

User's Manual

E-TUBE PROJECT Cyclist



Contents

Supported models.....	3
Connecting to the bicycle.....	5
Introduction	5
For Di2 rear derailleur (with wireless function)	5
For wireless unit	6
For system information display	7
For SHIMANO STEPS cycle computer (SC-E8000)	8
For SHIMANO STEPS cycle computer (excluding SC-E8000)/switch/junction	
[A].....	9
For power meter	10

Supported models

A bike configuration that contains one of the following models with a Bluetooth LE function is required to connect with E-TUBE PROJECT Cyclist.

- Di2 rear derailleur (with wireless function)

RD-R9250



RD-R8150



RD-R7150



- Wireless unit

EW-WU111



EW-WU101



- System information display

SC-M9051



SC-MT800



- SHIMANO STEPS cycle computer/switch/junction [A]

SC-E800



SC-E7000



SC-E6100



SC-E8000



SW-EN600L



EW-EN100



- Power meter

Supported models

FC-R9200-P



FC-R8100-P



FC-R9100-P



Connecting to the bicycle

Introduction

Before connection, turn on Bluetooth LE on the smartphone.

- For Di2 rear derailleur (with wireless function)
- For wireless unit
- For system information display
- For SHIMANO STEPS cycle computer (SC-E8000)
- For SHIMANO STEPS cycle computer (excluding SC-E8000)/switch/junction [A]
- For power meter

For Di2 rear derailleur (with wireless function)

1. Start E-TUBE PROJECT Cyclist and set it to listen for Bluetooth LE signals.
2. Press and hold the function button until the LED flashes blue.

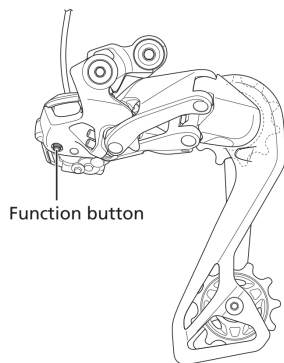

3. **The bicycle side is ready to connect.**

The unit name is displayed on the E-TUBE PROJECT screen.

If the unit is already registered, the connection automatically starts.

* Release the function button as soon as the bicycle side is ready to be connected. If the function button is held down for any longer, a different mode will be activated.

Connecting to the bicycle

For wireless unit

4. Select the unit name displayed on screen.

When disconnecting, cancel the Bluetooth LE connection from the smartphone/tablet. (The bicycle will switch from the connection mode to the normal operation mode.)

Switching operation modes

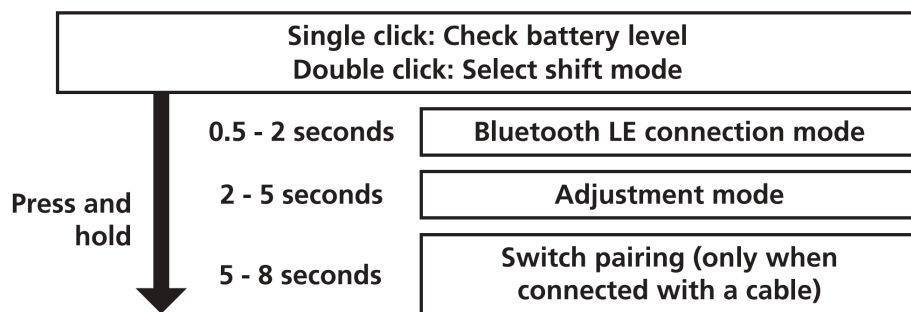

For the setting procedure, contact your place of purchase or a distributor.

For wireless unit

1. Start E-TUBE PROJECT Cyclist and set it to listen for Bluetooth LE signals.
2. Press and hold the junction [A] button until the green LED and red LED start blinking alternately.
3. The bicycle side is ready to connect.

The unit name is displayed on the E-TUBE PROJECT Cyclist screen.

If the unit is already registered, the connection automatically starts.

* Release the button as soon as the bicycle side is ready to be connected. If the button is held down for any longer, a different mode will be activated.

4. Select the unit name displayed on screen.

When disconnecting, cancel the Bluetooth LE connection from the smartphone/tablet. (The bicycle will switch from the connection mode to the normal operation mode.)

Switching operation modes

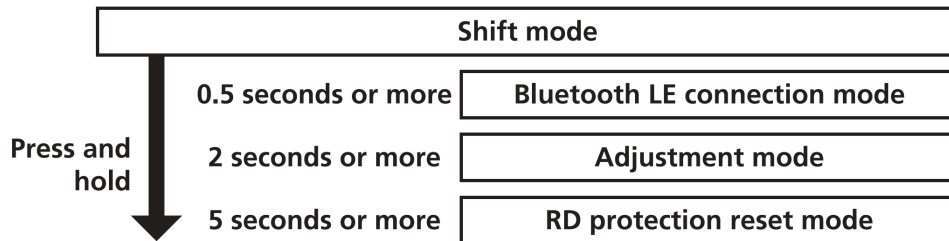

To end adjustment mode or RD protection reset mode, press and hold for 0.5 seconds or more.
For the setting procedure, contact your place of purchase or a distributor.

For system information display

1. Start E-TUBE PROJECT Cyclist and set it to listen for Bluetooth LE signals.
2. Press and hold the mode switch on the bicycle until "C" appears on the display.



3. The bicycle side is ready to connect.

The unit name is displayed on the E-TUBE PROJECT Cyclist screen.
If the unit is already registered, the connection automatically starts.

* Release the mode switch as soon as the bicycle side is ready to be connected. If the mode switch is held down for any longer, a different mode will be activated.

Connecting to the bicycle

For SHIMANO STEPS cycle computer (SC-E8000)

4. Select the unit name displayed on screen.

When disconnecting, cancel the Bluetooth LE connection from the smartphone/tablet. (The bicycle will switch from the connection mode to the normal operation mode.)

Switching operation modes

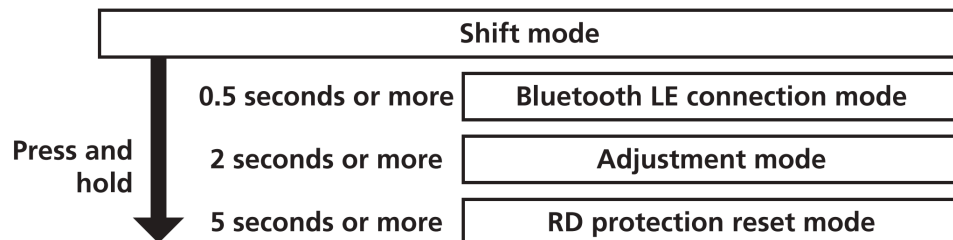

To end adjustment mode or RD protection reset mode, press and hold for 0.5 seconds or more.

For the setting procedure, contact your place of purchase or a distributor.

For SHIMANO STEPS cycle computer (SC-E8000)

1. Start E-TUBE PROJECT Cyclist and set it to listen for Bluetooth LE signals.

Connecting to the bicycle

For SHIMANO STEPS cycle computer (excluding SC-E8000)/switch/junction [A]

2. Press X or Y to select "Start" and press A to start Bluetooth LE pairing.

Press A to start Bluetooth LE pairing.

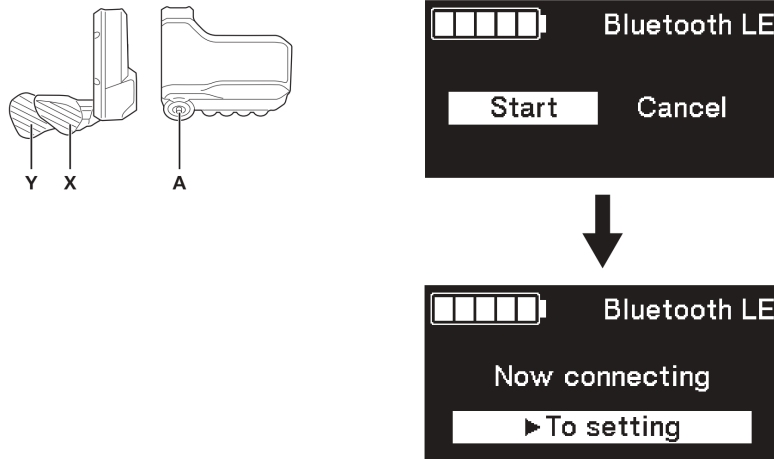

If the connection is successful, the SHIMANO STEPS logo is displayed on the screen.

If the connection fails, a message indicating so is displayed.



3. Press X, Y, or A after a connection failure.

Otherwise, the screen will automatically return to the menu list screen after a while.

4. The bicycle side is ready to connect.

The unit name is displayed on the E-TUBE PROJECT Cyclist screen.

If the unit is already registered, the connection automatically starts.

5. Select the unit name displayed on screen.

When disconnecting, cancel the Bluetooth LE connection from the smartphone/tablet. (The bicycle will switch from the connection mode to the normal operation mode.)

For SHIMANO STEPS cycle computer (excluding SC-E8000)/switch/junction [A]

1. Start E-TUBE PROJECT Cyclist and set it to listen for Bluetooth LE signals.

Connecting to the bicycle

For power meter

2. Set the bicycle side ready to connect.

Communication can only be received under the following conditions. Perform one of the operations.

- Within 15 seconds of the main power for SHIMANO STEPS turning on
- Within 15 seconds of operating any button other than the SHIMANO STEPS power switch

3. The bicycle side is ready to connect.

The unit name is displayed on the E-TUBE PROJECT Cyclist screen.

If the unit is already registered, the connection automatically starts.

4. Select the unit name displayed on screen.

When disconnecting, cancel the Bluetooth LE connection from the smartphone/tablet. (The bicycle will switch from the connection mode to the normal operation mode.)

For power meter

1. Start E-TUBE PROJECT Cyclist and set it to listen for Bluetooth LE signals.

2. Press the button of the control unit.

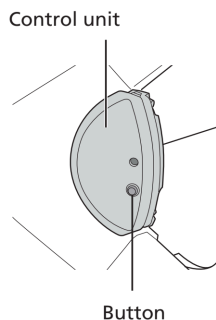

3. The bicycle side is ready to connect.

The unit name is displayed on the E-TUBE PROJECT Cyclist screen.

If the unit is already registered, the connection automatically starts.

4. Select the unit name displayed on screen.

When disconnecting, cancel the Bluetooth LE connection from the smartphone/tablet. (The bicycle will switch from the connection mode to the normal operation mode.)

SHIMANO

SHIMANO NORTH AMERICA BICYCLE, INC.
One Holland, Irvine, California 92618, U.S.A. Phone: +1-949-951-5003

SHIMANO EUROPE B.V.
High Tech Campus 92, 5656 AG Eindhoven, The Netherlands Phone: +31-402-612222

SHIMANO INC.
3-77 Oimatsu-cho, Sakai-ku, Sakai City, Osaka 590-8577, Japan

Please note: specifications are subject to change for improvement without notice. (English)
© Feb. 2023 by SHIMANO INC. ITP