

WARNING

- Before riding the bicycle, check that the ring is turned to the “FREE” side (in the clockwise direction) as far as it will go and that the red “●” mark is aligned with the center of the frame. When the ring is in this position, the handlebar should turn smoothly.
- If you try to ride the bicycle while the ring is turned to the “STOP” position, it will not be possible to turn the handlebar in the normal way, and a serious accident may result.
- The handlebar will also not turn in the normal way while the ring is set to somewhere between the “FREE” and “STOP” positions. If you try to ride the bicycle with the ring in this condition, a serious accident may result.
- Never turn the ring to the “STOP” position while riding, as this will stop the handlebar from turning normally, which could cause a serious accident.
- Do not hang any luggage in the area of the handlebar while riding, as there is the danger that the luggage might touch the ring and move it away from the “FREE” position and toward the “STOP” position.
- Avoid putting a child’s seat forward of the bicycle seat, as the child might accidentally touch the ring while sitting in this seat.
- Do not leave the bicycle alone while a child is sitting in the child’s seat otherwise the bicycle may fall over and serious injury to the child may result.
- Make sure you fully understand how the ring operates before you ride the bicycle. If you have any questions regarding operation, please contact your nearest bicycle shop.

SERVICE INSTRUCTIONS

SI-9470A

HP-NX10

Handlebar stopper

Before use, read these instructions carefully, and follow them for correct use.

■ METHOD OF USE

Moving the ring to “STOP” when parking the bicycle

The handlebar stopper is activated by turning the ring to the “STOP” position (counterclockwise). In this condition, the handlebar will turn if you force it to turn, but it will make a cracking sound. Never ride the bicycle in this condition, as it is extremely dangerous.

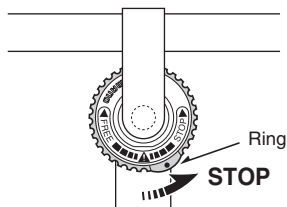

If the handlebar still moves after the ring has been turned counterclockwise, turn the ring again while moving the handlebar slightly until it locks.

Moving the ring to “FREE” before riding the bicycle

The handlebar can be unlocked by turning the ring to the “FREE” position (clockwise). Check that the red “●” mark is aligned with the center of the frame and that the handlebar turns smoothly before riding the bicycle.

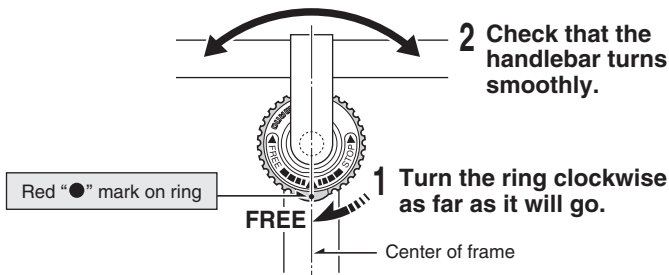

SHIMANO

SHIMANO AMERICAN CORPORATION
One Holland, Irvine, California 92618, U.S.A. Phone: +1-949-951-5003

SHIMANO EUROPE B.V.
Industrieweg 24, 8071 CT Nunspeet, The Netherlands Phone: +31-341-272222

SHIMANO INC.
3-77 Oimatsu-cho, Sakai-ku, Sakai-shi, Osaka 590-8577, Japan

These service instructions explain how to use and maintain the Shimano bicycle parts which have been used on your new bicycle. For any questions regarding your bicycle or other matters which are not related to Shimano parts please contact the place of purchase or the bicycle manufacturer.