

## General Safety Information

### ⚠ WARNING

- Obtain and read the service instructions carefully prior to installing the parts. Loose, worn, or damaged parts may cause injury to the rider. We strongly recommend only using genuine Shimano replacement parts.
- Obtain and read the service instructions carefully prior to installing the parts. If adjustments are not carried out correctly, the chain may come off and this may cause you to fall off the bicycle which could result in serious injury.
- Read these Technical Service Instructions carefully, and keep them in a safe place for later reference.

### Note

- Do not turn the ring until the lever has been secured to the frame.
- For smooth operation, use the specified outer casing and bottom bracket cable guide.
- Grease the inner cable and the inside of the outer casing before use to ensure that they slide properly.
- Use a frame with internal cable routing is strongly discouraged as it has tendencies to impair the SIS shifting function due to its high cable resistance.
- Operation of the levers related to gear shifting should be made only when the front chainwheel is turning.
- Parts are not guaranteed against natural wear or deterioration resulting from normal use.
- For maximum performance we highly recommend Shimano lubricants and maintenance products.
- For any questions regarding methods of installation, adjustment, maintenance or operation, please contact a professional bicycle dealer.

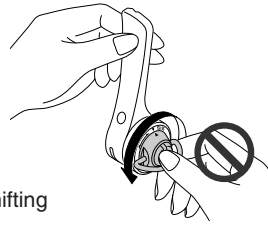

## Technical Service Instructions

SI-6CW0B-001

# SL-1056-8 SL-R400

Shifting Lever

In order to realize the best performance, we recommend that the following combination be used.

Series	105	SORA
Shifting lever	SL-1056-8	SL-R400
Outer casing	SIS SP40	SIS SP40
Gears	16	16
Front derailleur	FD-A551	FD-3300
Rear derailleur	RD-A551	RD-3300-SS
Chain	CN-HG50	CN-HG50
Bottom bracket cable guide	SM-SP17	SM-SP17

## Installation of the lever (for rear)

1. Install the lever to the frame.

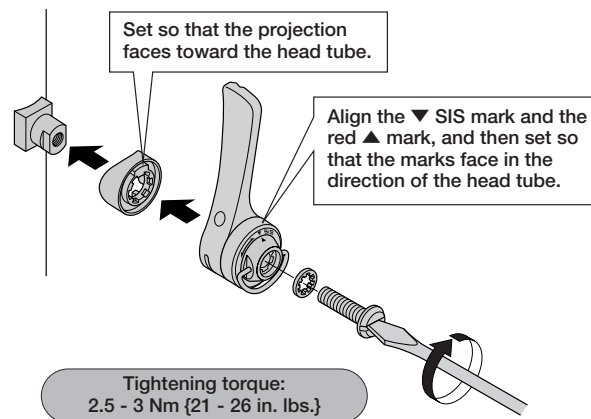

## Installation of the lever (for front)

1. Install the lever boss cover to the brazed-on boss.

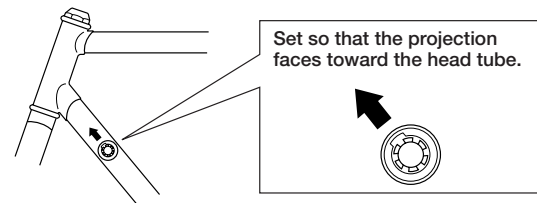

2. Install the lever.

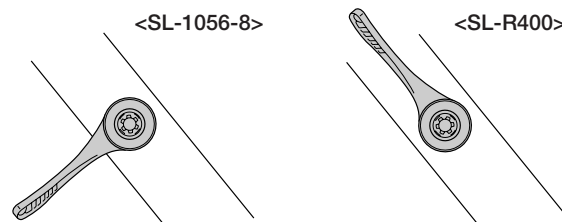

3. <SL-1056-8>

Turn the lever in the direction of (A) and then tighten the lever fixing bolt until the lever no longer returns by the force of the spring.

<SL-R400>

Use the lever fixing bolt to install the lever.

Tightening torque:  
2.5 - 3 Nm {21 - 26 in. lbs.}

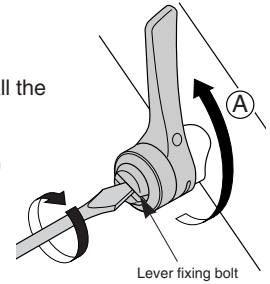

### Note (SL-1056-8) :

- Be sure to turn the lever in the direction of (A). If it is turned in the opposite direction, the internal mechanism may become broken.
- In order to improve operability, the front lever is designed so that there is a 30° rise from the frame when the lever is moved to the low position.

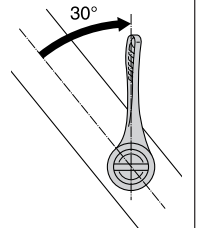

## SIS operation

Turn the ring to select either SIS or friction. (The SL-R400 is not equipped with this mechanism.)

If SIS is selected, turn the ring until the red ▲ mark is correctly aligned with the ▼ SIS mark.

If friction is selected, turn the ring fully counterclockwise.

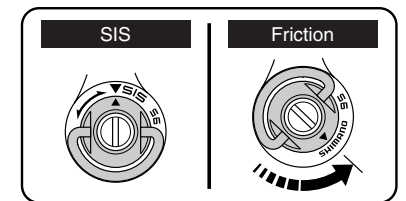
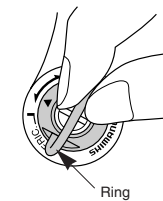

After making a selection, be sure to fold the ring downward.

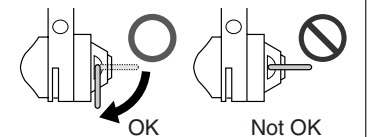

# SHIMANO

SHIMANO AMERICAN CORPORATION  
One Holland, Irvine, California 92618, U.S.A. Phone: +1-949-951-5003

SHIMANO EUROPE B.V.  
Industrieweg 24, 8071 CT Nunspeet, The Netherlands Phone: +31-341-272222

SHIMANO INC.  
3-77 Oimatsu-cho, Sakai-ku, Sakai-shi, Osaka 590-8577, Japan

These service instructions are printed on recycled paper. Please note: specifications are subject to change for improvement without notice. (English)  
© Oct. 2006 by Shimano Inc. XBC SZK Printed in Japan.