

General Safety Information

⚠ WARNING

- Check that the wheels are fastened securely before riding the bicycle. If the wheels are loose in any way, they may come off the bicycle and serious injury may result.
- Obtain and read the service instructions carefully prior to installing the parts. Loose, worn or damaged parts may cause the bicycle to fall over and serious injury may occur as a result. We strongly recommend only using genuine Shimano replacement parts.
- Read these Technical Service Instructions carefully, and keep them in a safe place for later reference.

Note

- If the wheel becomes stiff and difficult to turn, you should lubricate it with grease.
- Do not apply any lubricant to the inside of the hub, otherwise the grease will come out.
- Parts are not guaranteed against natural wear or deterioration resulting from normal use.
- For maximum performance we highly recommend Shimano lubricants and maintenance products.

Technical Service Instructions

SI-27V0A-001

HB-MX71

Front hub



00

In order to realize the best performance, we recommend that the following combination be used.

Series	DXR
Brake Lever	BL-MX70
V-BRAKE	BR-MX70
Freehub	FH-MX71
Front hub	HB-MX71
Gears	1
Cassette sprocket	CS-MX66

Specifications

Front hub

Model No.	HB-MX71
No. of spoke holes	32 H / 36 H
Applicable front fork end thickness	4 - 7 mm
Applicable front fork end dimensions	10 mm
Overlock nut dimensions	100 mm

Maintenance

The unit can be disassembled as shown in the illustration. Apply grease to the various parts at periodic intervals.

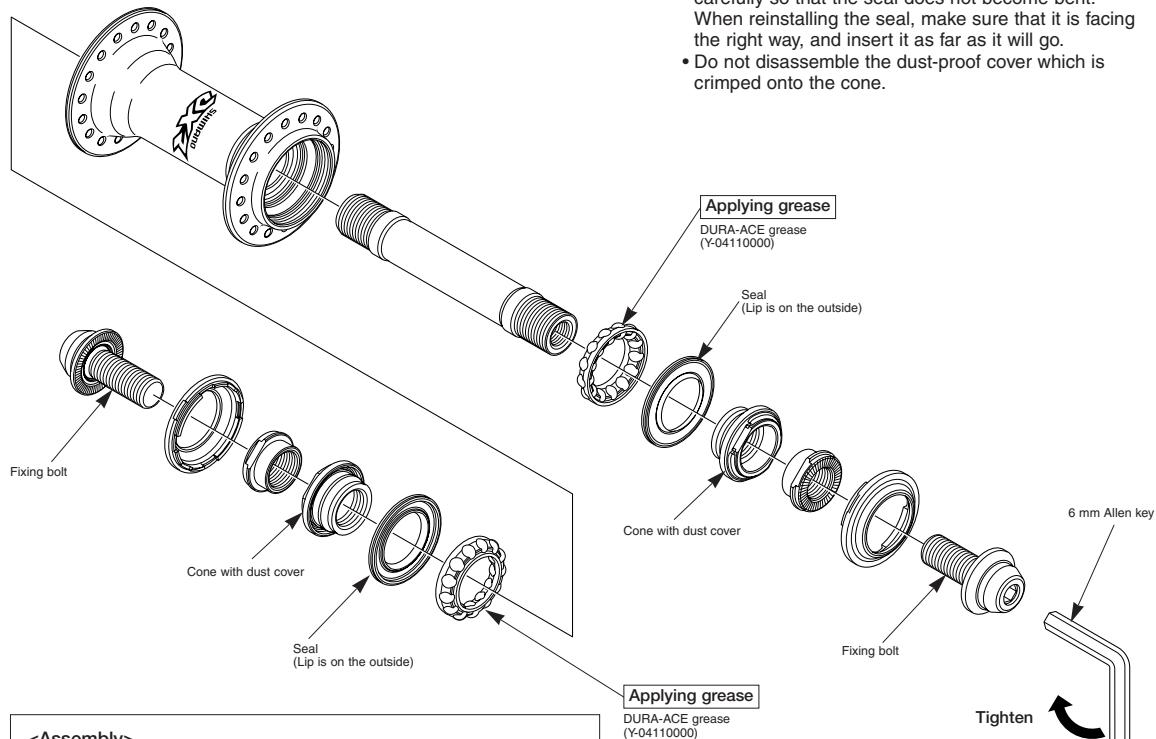

Note:

- When removing and installing the seal, do it very carefully so that the seal does not become bent. When reinstalling the seal, make sure that it is facing the right way, and insert it as far as it will go.
- Do not disassemble the dust-proof cover which is crimped onto the cone.

<Assembly>

Use the TL-HS23 (18 mm) and TL-HS22 (17 mm) special tools to tighten the lock nut in order to double-lock the assembly.

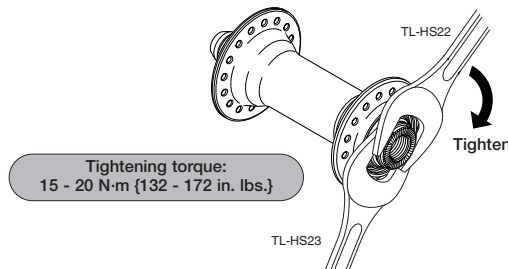

Applying grease
DURA-ACE grease
(Y-04110000)

Fixing bolt tightening torque:
23 - 28 N·m [200 - 244 in. lbs.]

SHIMANO

SHIMANO AMERICAN CORPORATION
One Holland, Irvine, California 92618, U.S.A. Phone: +1-949-951-5003

SHIMANO EUROPE B.V.
Industrieweg 24, 8071 CT Nunspeet, The Netherlands Phone: +31-341-272222

SHIMANO INC.
3-77 Oimatsu-cho, Sakai-ku, Sakai-shi, Osaka 590-8577, Japan

Please note: specifications are subject to change for improvement without notice. (English)
© Feb. 2009 by Shimano Inc. XBC SZK Printed in Japan.