

SORA Dual Control Lever ST-R3000 (2x9-speed)

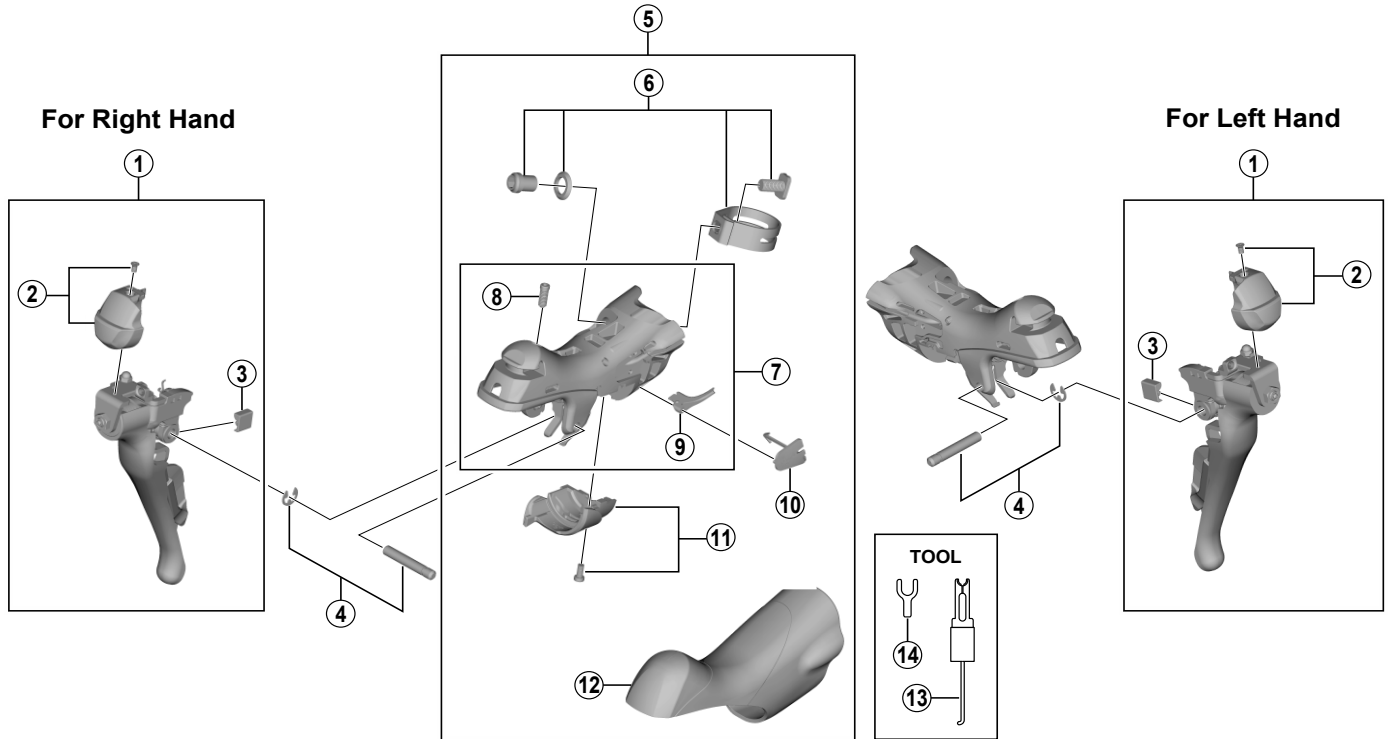

ITEM NO.	SHIMANO CODE NO.	DESCRIPTION	INTERCHANGEABILITY	
1	Y05T98020	R.H. Main Lever Assembly		
	Y05U98010	L.H. Main Lever Assembly		
2	Y05T98030	R.H. Name Plate R & Fixing Screw		
	Y05U98020	L.H. Name Plate L & Fixing Screw		
3	Y05T00140	R.H. Main Lever Support R		
	Y05U00100	L.H. Main Lever Support L		
4	Y05T98040	Lever Axle & E-ring		
	Y05T98050	R.H. Bracket Assembly		
5	Y05U98030	L.H. Bracket Assembly		
	Y05T98060	Clamp Band Unit (ø23.8 mm - ø24.2 mm)		
7	Y05T98070	R.H. Bracket Unit		
	Y05U98040	L.H. Bracket Unit		
8	Y05T00170	Grip Adjusting Screw		
9	Y05T000G0	R.H. SL Cable Guide R		
	Y63X55000	L.H. SL Cable Guide L		
10	Y00E75000	R.H. SL Cable Cover R		
	Y00F75000	L.H. SL Cable Cover L		
11	Y05T98080	R.H. Unit Cover R & Fixing Screw		
	Y05U98050	L.H. Unit Cover L & Fixing Screw		
12	Y05T98010	Bracket Covers (Black/Pair)		
13	Y6RT68000	Tool A for E-ring	A	
14	Y6RT66000	Tool B for E-ring	A	

A: Same parts.

B: Parts are usable, but differ in materials, appearance, finish, size, etc.

Absence of mark indicates non-interchangeability.

Specifications are subject to change without notice.

ST-3500

Feb.-2016-3975

© Shimano Inc. I

SHIMANO