

SHIMANO

SHIMANO (EUROPA) GmbH.
Kleinhülsen 1-3 4010 Hilden, Germany
Tel. 02103-5005-0

SHIMANO AMERICAN CORPORATION
One Shimano Drive, P.O. Box 19615, Irvine,
California U.S.A. 92718 Tel. (714) 951-5003

Small parts list for after market.

- You may photocopy this sheet and use it as an order form.
- Sie können dieses Blatt kopieren und als Bestellformular verwenden.
- Vous pouvez photocopier cette feuille et l'utiliser comme bon de commande.
- Dit blad kan gecopieerd en als bestelformulier gebruikt worden.
- Potete fotocopiare questo foglio e usarlo come modulo di commissione.

DURA-ACE Dual Control Lever ST-7400

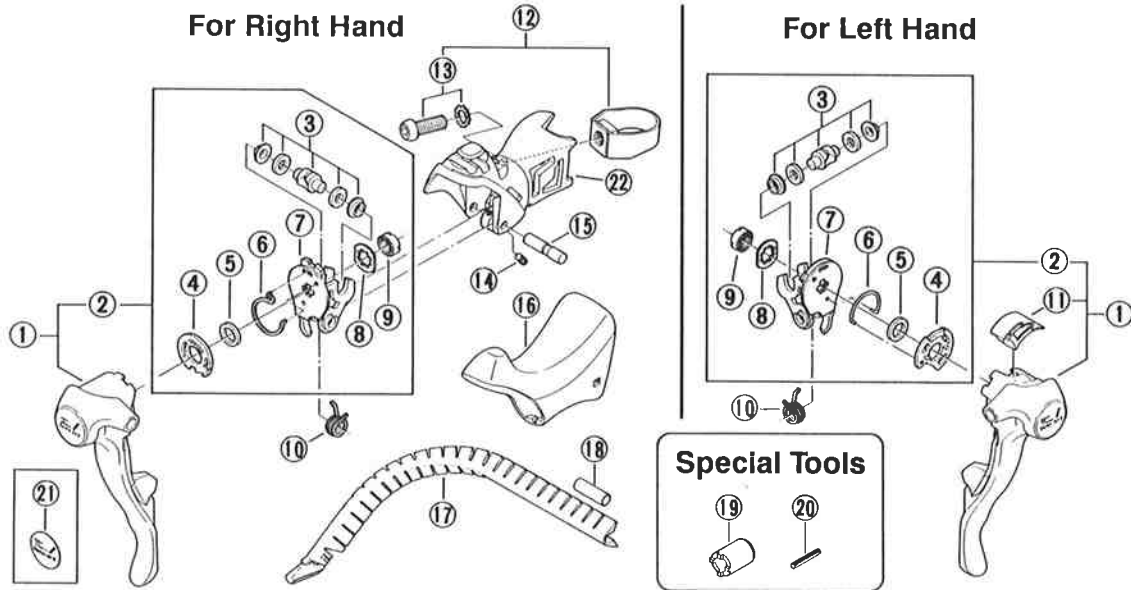

Q'TY	ITEM NO.	PART NO.	DESCRIPTION
	1	67D 9810	R.H. Main Lever Unit
	1	67D 9811	L.H. Main Lever Unit
	2	67D 9815	R.H. Adapter Unit
	2	67D 9816	L.H. Adapter Unit
	3	67D 9814	Wire Hook Unit
	4	67D 6900-1	R.H. Release Plate
	4	67D 1100	L.H. Release Plate
	5	67D 4210	R.H. Release Plate Washer (t=1.4mm)
	5	67D 4200	L.H. Release Plate Washer (t=1.2mm)
	6	67D 8100	R.H. Spring for Release Plate
	6	67D 3800	L.H. Spring for Release Plate
	7	67D 9812	R.H. Adapter
	7	67D 9813	L.H. Adapter
	8	67D 4300	Non-Turn Washer
	9	66E 3300	Lock Nut
	10	88B 0700	R.H. Return Spring
	10	88B 0800	L.H. Return Spring
	11	67D 1000	Cover Only for L.H. Main Lever
	12	67D 9817	Clamp Band Unit (ø23.8mm-ø24.2mm)
	13	67D 9819	Clamp Bolt (M6 x 18) & Teethed Washer
	14	884 1400	Lever Axle Fixing Screw
	15	88B 0500	Lever Axle
	16	88B 9801-1	Bracket Covers (Pair / Black)
	17	86B 9001	Outer Cable Guide
	18	877 1100	Outer Cable Joint (Option)
	19	130 0300	Lock Nut Removal Tool (TL-ST01)
	20	130 0310	Return Spring Installation Tool (TL-ST02)
	21	67D 3900	Name Plate
	22	88B 9803	R.H. Lever Bracket
	22	88B 9804	L.H. Lever Bracket