

SHIMANO ULTEGRA Dual Control Lever  
**ST-6500-B**

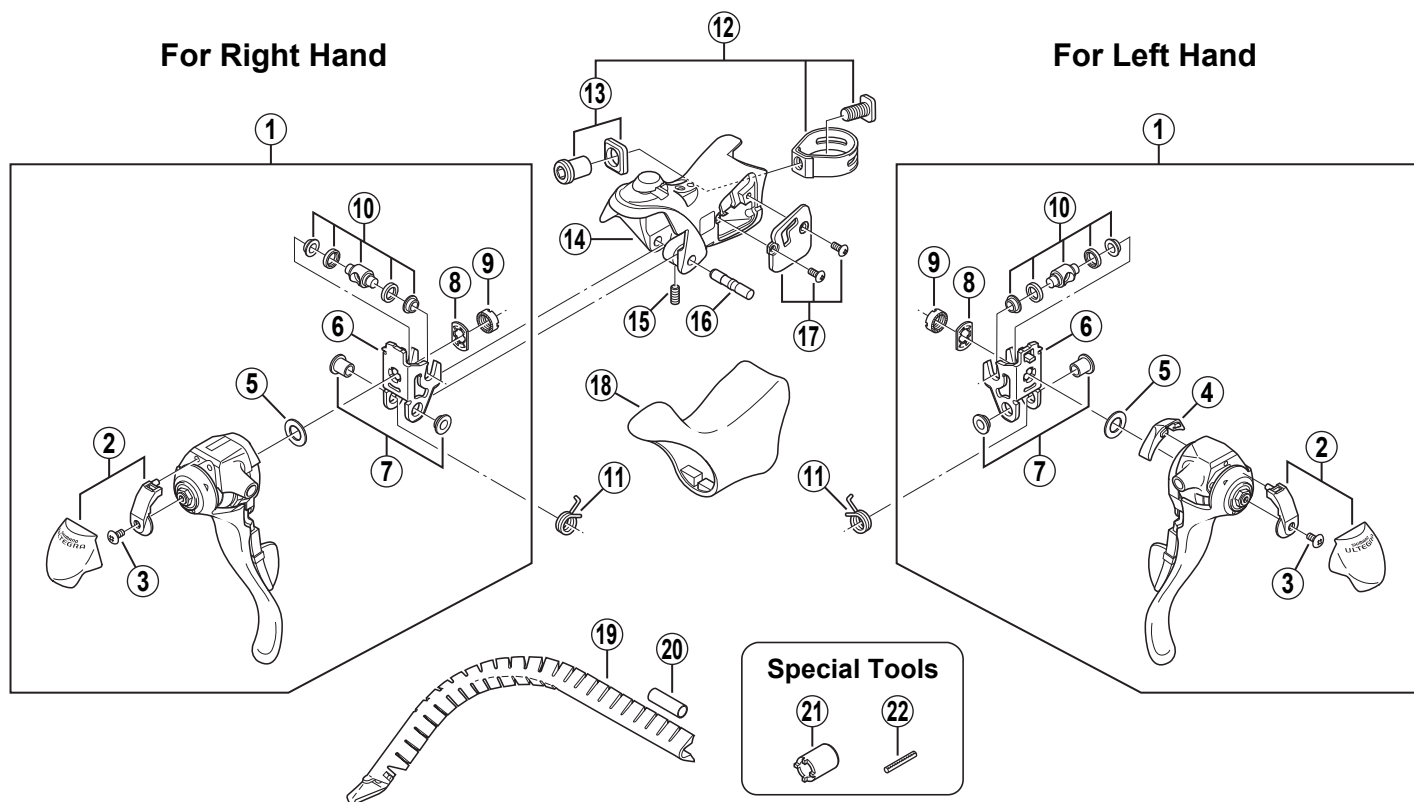

| Q'TY | ITEM NO. | SHIMANO CODE NO. | DESCRIPTION                                  |
|------|----------|------------------|--|
|      | 1        | Y-6BS98110       | R.H. Main Lever Assembly                     |
|      |          | Y-6BS98120       | L.H. Main Lever Assembly                     |
|      | 2        | Y-6BS98130       | R.H. Name Plate & Front Cover                |
|      |          | Y-6BS98140       | L.H. Name Plate & Front Cover                |
|      | 3        | Y-6BS42000       | Front Cover Fixing Screw (M3 x 6)            |
|      | 4        | Y-6BS71000       | L.H. Rear Cover                              |
|      | 5        | Y-6BS74000       | Adapter Spacer                               |
|      | 6        | Y-6CT03000       | R.H. Adapter                                 |
|      |          | Y-6CT03010       | L.H. Adapter                                 |
|      | 7        | Y-85Z 98010      | Lever Axle Bush Unit                         |
|      | 8        | Y-6BD39000       | Non-Turn Washer                              |
|      | 9        | Y-66E 33000      | Lock Nut                                     |
|      | 10       | Y-6BD98110       | Cable Hook Unit                              |
|      | 11       | Y-6BD75000       | R.H. Return Spring                           |
|      |          | Y-6BD74000       | L.H. Return Spring                           |
|      | 12       | Y-6BD98120       | Clamp Band Unit (φ23.8 mm - φ24.2 mm)        |
|      | 13       | Y-6BD98130       | Clamp Nut & Washer                           |
|      | 14       | Y-6BS98050       | R.H. Bracket                                 |
|      |          | Y-6BS98060       | L.H. Bracket                                 |
|      | 15       | Y-6BD76000       | Lever Axle Fixing Screw                      |
|      | 16       | Y-6BS84000       | Lever Axle                                   |
|      | 17       | Y-6BS98070       | R.H. Bracket Cap & Fixing Screws (M3 x 6.35) |
|      |          | Y-6BS98080       | L.H. Bracket Cap & Fixing Screws (M3 x 6.35) |
|      | 18       | Y-6BS98090       | Bracket Covers (Pair)                        |
|      | 19       | Y-86B 90010      | Outer Cable Guide                            |
|      | 20       | Y-877 11000      | Outer Cable Joint                            |
|      | 21       | Y-130 03000      | Lock Nut Removal Tool (TL-ST01)              |
|      | 22       | Y-130 03100      | Return Spring Installation Tool (TL-ST02)    |