

SHIMANO

SHIMANO (EUROPA) GmbH.
Kleinhülsen 1-3 4010 Hilden, Germany
Tel. 02103-5005-0

SHIMANO AMERICAN CORPORATION
One Shimano Drive, P.O. Box 19615, Irvine,
California U.S.A. 92718 Tel. (714) 951-5003

Small parts list for after market.

- You may photocopy this sheet and use it as an order form.
- Sie können dieses Blatt kopieren und als Bestellformular verwenden.
- Vous pouvez photocopier cette feuille et l'utiliser comme bon de commande.
- Dit blad kan gecopieerd en als bestelformulier gebruikt worden.
- Potete fotocopiare questo foglio e usarlo come modulo di commissione.

SHIMANO XTR Head Parts

HP-M900 B.C.1"x24T or M25xP1.0

HP-M901 B.C.1-1/8"x26T

HP-M902 B.C.1-1/4"x26T

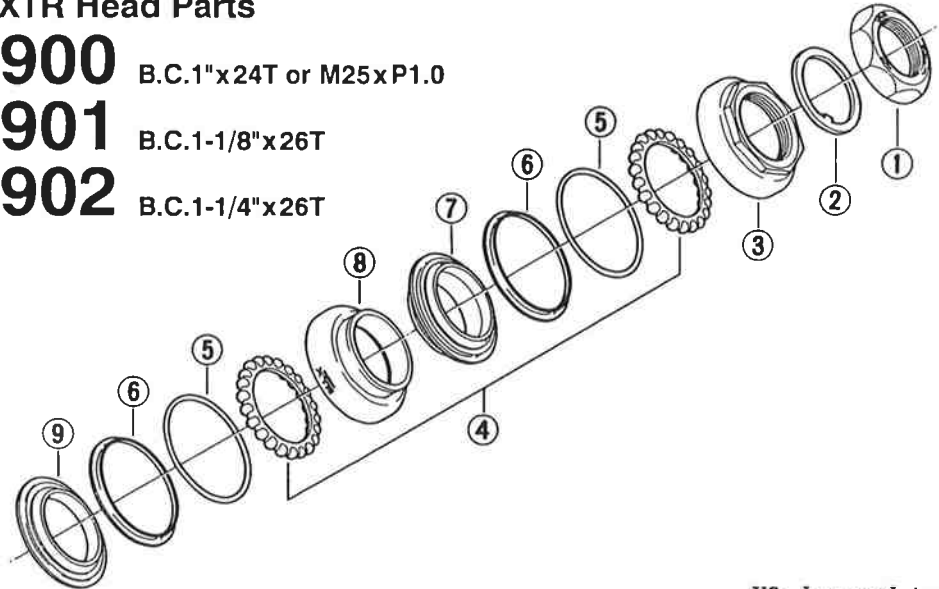

JIS: Japanese Industrial Standards.

Q'TY	ITEM NO.	PART NO.	DESCRIPTION
	1	783 9804	Lock Nut B.C.1" x 24T (English & JIS Thread) w/Stem Seal for HP-M900
		783 9801	Lock Nut M25 x P1.0 (French Thread) w/Stem Seal for HP-M900
		784 9801	Lock Nut B.C.1-1/8" x 26T (English Thread) w/Stem Seal for HP-M901
		786 9801	Lock Nut B.C.1-1/4" x 26T (English Thread) w/Stem Seal for HP-M902
	2	715 0200	Lock Washer (English & JIS) for HP-M900
		715 0210	Lock Washer (French) for HP-M900
		712 0700	Lock Washer (English) for HP-M901
		712 0710	Lock Washer (English) for HP-M902
	3	783 9805	Upper Head Cup B.C.1" x 24T (English & JIS Thread) for HP-M900
		783 9806	Upper Head Cup M25 x P1.0 (French Thread) for HP-M900
		784 9803	Upper Head Cup B.C.1-1/8" x 26T (English Thread) for HP-M901
		786 9803	Upper Head Cup B.C.1-1/4" x 26T (English Thread) for HP-M902
	4	783 9811	Ball Retainer (3/16" x 20) 2pcs. for HP-M900
		784 9805	Ball Retainer (3/16" x 22) 2pcs. for HP-M901
		786 9805	Ball Retainer (3/16" x 24) 2pcs. for HP-M902
	5	783 0800	O-Ring for HP-M900
		784 0900	O-Ring for HP-M901
		786 0800	O-Ring for HP-M902
	6	783 0700	Dust Seal for HP-M900
		784 0800	Dust Seal for HP-M901
		786 0700	Dust Seal for HP-M902
	7	783 9808	Upper Head Cone ϕ 30.0mm (JIS) for HP-M900
		783 9807	Upper Head Cone ϕ 30.2mm for HP-M900
		784 9804	Upper Head Cone ϕ 34.0mm for HP-M901
		786 9804	Upper Head Cone ϕ 37.0mm for HP-M902
	8	783 9803	Lower Head Cup ϕ 30.0mm (JIS) for HP-M900
		783 9802	Lower Head Cup ϕ 30.2mm for HP-M900
		784 9802	Lower Head Cup ϕ 34.0mm for HP-M901
		786 9802	Lower Head Cup ϕ 37.0mm for HP-M902
	9	783 9810	Lower Head Cone w/Press-Fit Ring ϕ 27.0mm (JIS) for HP-M900
		783 9809	Lower Head Cone w/Press-Fit Ring ϕ 26.4mm for HP-M900
		784 0700	Lower Head Cone ϕ 30.0mm for HP-M901
		786 0600	Lower Head Cone ϕ 33.0mm for HP-M902