

Freehub (for Disc Brake 8/9-speed)
FH-M475-S Silver Version
FH-M475-L Black Version

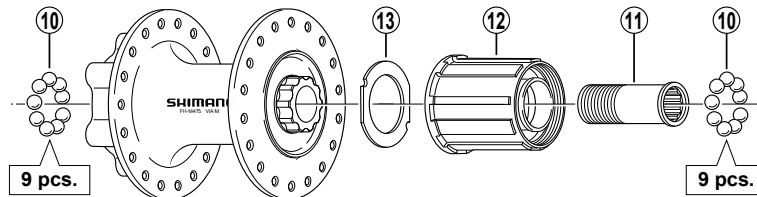
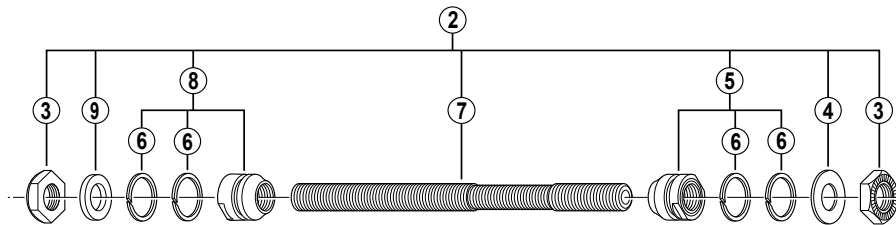
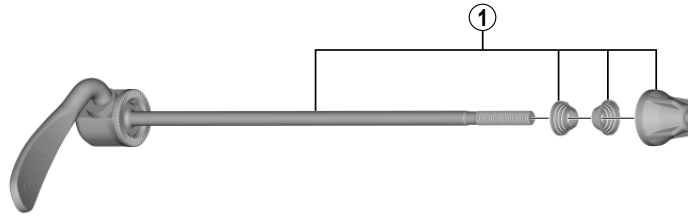

• Over Lock Nut Dimension: 135 mm (5-5/16")

ITEM NO.	SHIMANO CODE NO.	DESCRIPTION
*	Y3CC98070	Complete Quick Release 166 mm (6-17/32") Silver
* 1	Y31U98010	Complete Quick Release 166 mm (6-17/32") Black
*	Y3CC98080	Complete Quick Release 170 mm (6-11/16") Silver
*	Y31U98020	Complete Quick Release 170 mm (6-11/16") Black
2	Y3B598030	Complete Hub Axle 146 mm (5-3/4")
3	Y22005011	Serrated Lock Nut 4.5 mm
4	Y3AC09000	Right Hand Washer 0.5 mm
5	Y30G90500	Right Hand Cone (M10 x 15 mm) & Seal Rings
6	Y29905000	Seal Ring
7	Y30K01200	Hub Axle M10 x 146 mm (5-3/4")
8	Y22098080	Left Hand Cone (M10 x 15 mm) & Seal Rings
9	Y30106100	Left Hand Washer 2.3 mm
	Y30106300	Left Hand Washer 1.9 mm
10	Y00091310	Steel Ball (1/4") 18 pcs.
11	Y3BL03000	Body Fixing Bolt
12	Y3SL98030	Complete Freewheel Body w/Right Hand Dust Cap
13	Y3AN10000	Freewheel Body Washer

Apr.-2016-2198B
 © Shimano Inc. I

Specifications are subject to change without notice.

SHIMANO