

SHIMANO

SHIMANO (EUROPA) GmbH.
Kleinhülsen 1-3 4010 Hilden, Germany
Tel. 02103-5005-0

SHIMANO AMERICAN CORPORATION
One Shimano Drive, P.O. Box 19615, Irvine,
California U.S.A. 92718 Tel. (714) 951-5003

Small parts list for after market.

- You may photocopy this sheet and use it as an order form.
- Sie können dieses Blatt kopieren und als Bestellformular verwenden.
- Vous pouvez photocopier cette feuille et l'utiliser comme bon de commande.
- Dit blad kan gecopieerd en als bestelformulier gebruikt worden.
- Potete fotocopiare questo foglio e usarlo come modulo di commissione.

FH-HG20-7QR Freehub Quick Release Type / 7-Speed

FH-HG20-7NT Freehub Nut Type / 7-Speed

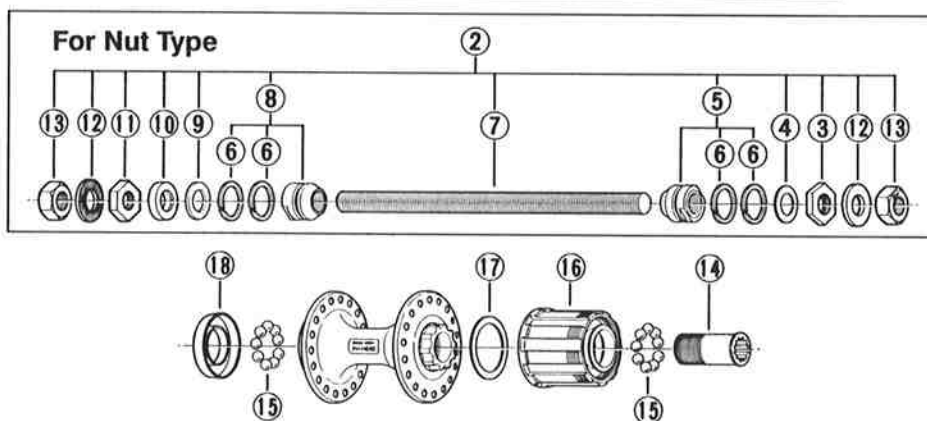
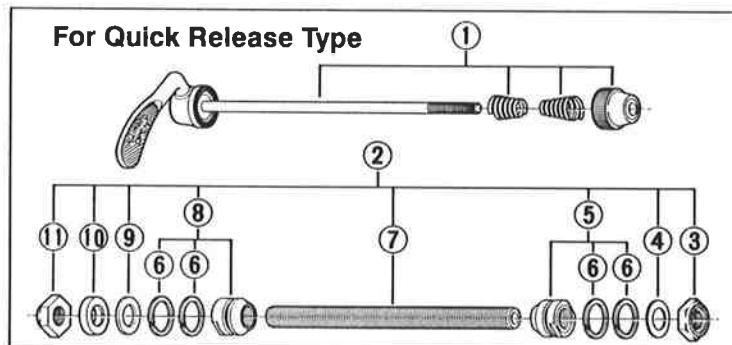

• Use with CS-HG50.

Over Lock Nut Dimensions: Quick Release Type / Nut Type...130mm(5-1/8")

Q'TY	ITEM NO.	PART NO.	DESCRIPTION
	1	384 9803	Complete Quick Release 161mm(6-11/32")
	* 2	30K 9801	Complete Hub Axle 141mm(5-9/16") for Quick Release Type
		383 9803	Complete Hub Axle 180mm(7-3/32") for Nut Type
	3	220 0502-1	Right Hand Lock Nut 3.5mm for Quick Release Type
		385 0100	Right Hand Lock Nut 3.5mm for Nut Type
	4	220 0431	Right Hand Washer 0.5mm
	* 5	30G 9050	Right Hand Cone (M10 x 15mm) & Seal Ring
	6	299 0500	Seal Ring
	* 7	30K 0110	Hub Axle 141mm(5-9/16") for Quick Release Type
		30J 0640	Hub Axle 180mm(7-3/32") for Nut Type
	* 8	220 9808	Left Hand Cone (M10 x 15mm) & Seal Ring
	9	301 0810	Left Hand Washer 1.2mm
	10	220 0460	Left Hand Axle Spacer 4mm
	11	220 0501-1	Left Hand Lock Nut 4.5mm for Quick Release Type
		385 0101	Left Hand Lock Nut 4.5mm for Nut Type
	12	220 0600	Hub Washer 2mm for Nut Type
	13	385 0200	Hub Nut for Nut Type
	14	359 0400	Freewheel Body Fixing Bolt
	* 15	000 9131	Steel Ball (1/4") 18pcs.
	* 16	30H 9801	Complete Freewheel Body w/Right Hand Dust Cap
	* 17	375 0400	Freewheel Body Washer
	18	248 0500	Left Hand Dust Cap