

SLX Crankset

FC-M7120-1 FC-M7120-B2
BB-MT800 SM-CRM75

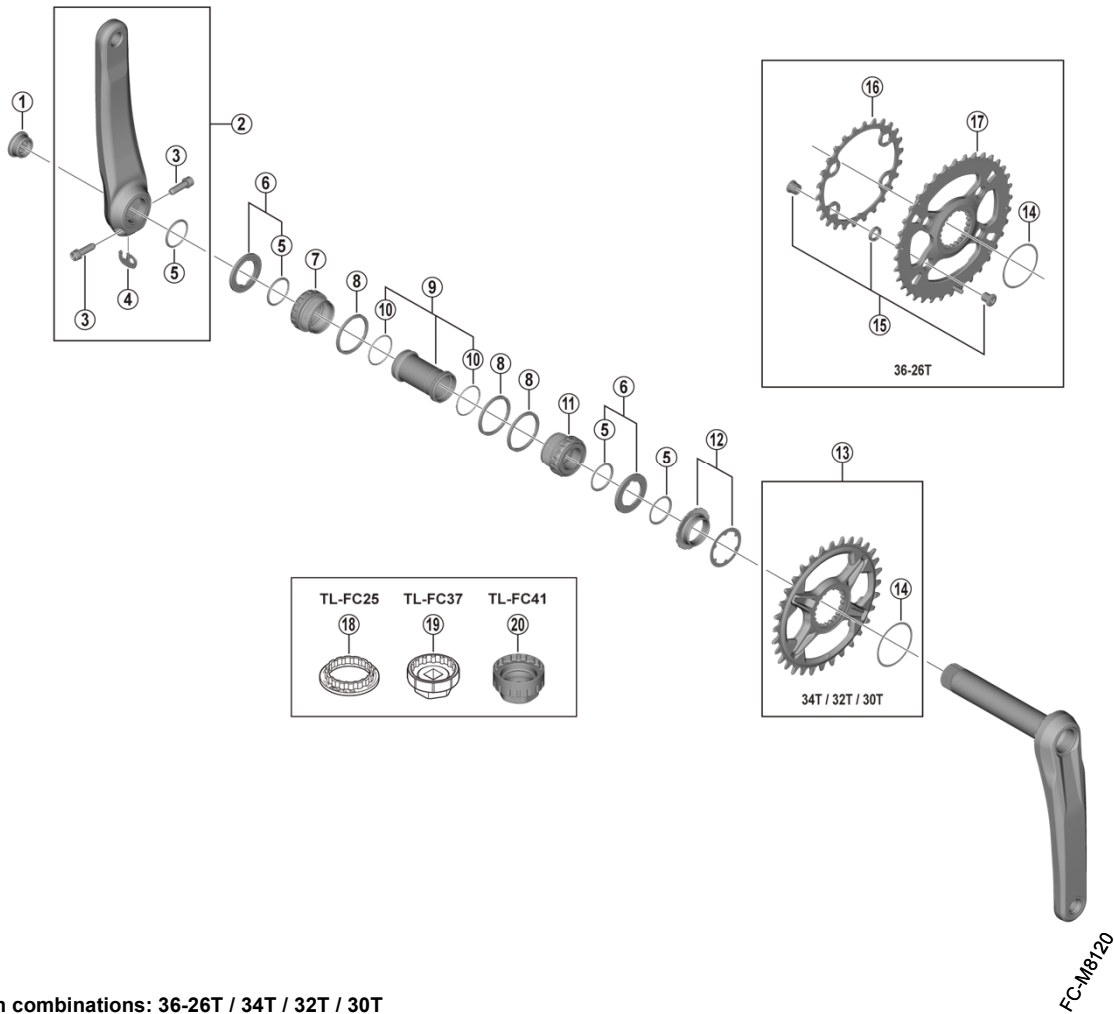

• Chaining teeth combinations: 36-26T / 34T / 32T / 30T

ITEM NO.	SHIMANO CODE NO.	DESCRIPTION	INTERCHANGEABILITY		
1	Y0J620000	Crank Arm Fixing Bolt	A		
2	Y0J998010	Left Hand Crank Arm Unit 165 mm			
	Y0J998020	Left Hand Crank Arm Unit 170 mm			
	Y0J998030	Left Hand Crank Arm Unit 175 mm			
3	Y1GS21000	Clamp Bolt with Washer (M6 x 21)	A		
4	Y0J698050	Plate	A		
5	Y1F316000	Ring	A		
6	Y1PW98070	Spacer & Ring	A		
7	Y1V698010	Left Hand Adapter (B.C.1.37" x 24T) English Thread (BB-MT800)	A		
8	Y1P804000	Spacer (2.5 mm)	A		
9	Y1E598210	Inner Cover & O-Ring	A		
10	Y1TF21000	O-Ring	A		
11	Y1V698020	Right Hand Adapter (B.C.1.37" x 24T) English Thread (BB-MT800)	A		
12	Y0J698060	Lock Ring & Washer	A		
13	ISMCRM75A0	Chaining 30T w/Spacer (SM-CRM75)			
	ISMCRM75A2	Chaining 32T w/Spacer (SM-CRM75)			
	ISMCRM75A4	Chaining 34T w/Spacer (SM-CRM75)			
14	Y0JC61000	Spacer	A		
15	Y0JB98020	Gear Fixing Bolt Unit (4 sets)	B		
16	Y0J826000	Chaining 26T-BJ for 36-26T	A		
17	Y0JB98010	Chaining 36T-BJ for 36-26T	B		
18	Y13009260	TL-FC25 Adapter Installation Tool			
19	Y13009270	TL-FC37 Adapter Installation Tool			
20	Y13098720	TL-FC41 Front Chaining Direct Mount Tool			

A: Same parts.

B: Parts are usable, but differ in materials, appearance, finish, size, etc.

Absence of mark indicates non-interchangeability.

Specifications are subject to change without notice.

Aug.-2019-4559

© Shimano Inc. I

SHIMANO