

CONTENTS

Compatibility (in English only)

Cautions regarding LINKGLIDE 11-speed specifications

LINKGLIDE cassette and FREEHUB compatibility (C-649)

Drivetrain for MTB, LIFESTYLE components

Rear drivetrain compatibility

- 9,10,11-speed rear drivetrain compatibility
- 11-speed rear drivetrain
- 10-speed rear drivetrain
- 9-speed rear drivetrain

Front drivetrain compatibility

- 11-speed front drivetrain
- 10-speed front drivetrain
- 9-speed front drivetrain

Compatibility

Cautions regarding LINKGLIDE 11-speed specifications

When using 11-speed specification LINKGLIDE, interference may occur with the rear derailleur and spokes. Check dimensions beforehand, and check that points A and B do not interfere with the spokes or other parts.

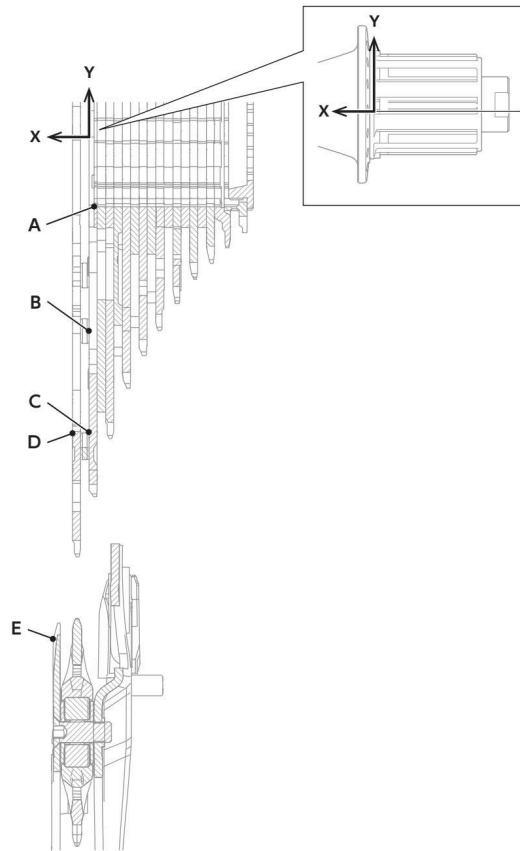

Model No.		A	B	C	D	E
CS-LG700-11 (11-45T)	X mm	0	1.2	1.2	5.8	10
	Y mm	-19.3	-52.5	-62	-62	-104.4
CS-LG700-11 (11-50T)	X mm	0	1.2	1.2	5.85	10
	Y mm	-19.3	-51	-70	-70	-124
CS-LG400-11 (11-45T)	X mm	0	1.2	1.2	5.5	10
	Y mm	-16.25	-51.5	-62	-62	-104.4
CS-LG400-11 (11-50T)	X mm	0	1.2	1.2	5.5	10
	Y mm	-16.25	-42.3	-71	-71	-124

TECH TIPS

It is also possible to check for interference by using the cassette sprockets listed below and measuring the clearance between the largest sprocket and the spokes, etc.

HG 11-speed 11-51T (CS-M5100): 8.5 mm or more

HG 11-speed 11-46T (CS-M8000/CS-M7000): 7.5 mm or more

LG 11-speed 11-50T (CS-LG600): 6.5 mm or more

* The latest model information can be accessed on our website (<https://productinfo.shimano.com/#/>).

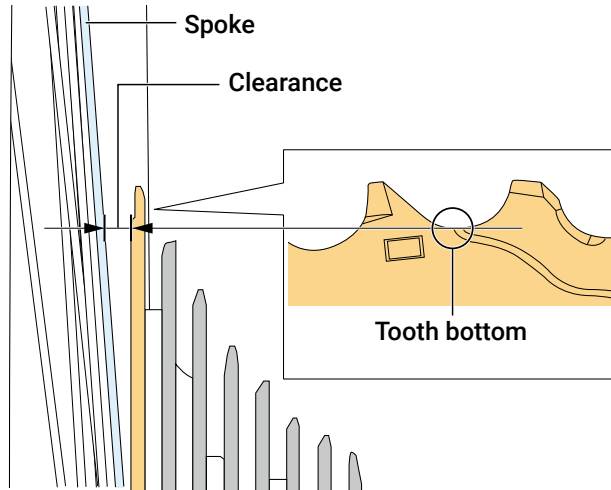

LINKGLIDE cassette and FREEHUB compatibility

LINKGLIDE cassette are not compatible with MICRO SPLINE FREEHUB.

Freewheel body type	FREEHUB spec.	Model No.	CS-LG700-11 CS-LG600-11 CS-LG400-11	CS-LG600-10 CS-LG400-10 CS-LG300-10	CS-LG400-9 CS-LG300-9
HG spline M (10/9/8-speed, MTB 11-speed)	O.L.D. 148 mm, E-THRU type	FH-M8010-B			
		FH-M6010-B			
		FH-TC600-HM-B	✓	✓	✓
		FH-TC500-HM-B			
		FH-MT400-B			
	O.L.D. 141 mm, Quick release type	FH-MT200-B			
	O.L.D. 150 mm, E-THRU type	FH-M825	✓	✓	✓
	O.L.D. 135 mm, E-THRU type	FH-M820	- *2	✓	✓
	O.L.D. 142 mm, E-THRU type	FH-M8010			
		FH-M6010	- *2	✓	✓
		FH-MT400			
		FH-TC500-HM	✓	✓	✓
	O.L.D. 135 mm, Quick release type	FH-M9000			
		FH-M8000			
		FH-M6000			
		FH-M4050			
		FH-M3050			
		FH-RM35			
		FH-TX505-8			
		FH-M756-A	- *2	✓	✓
		FH-M525			
		FH-M475			
		FH-TX506			
FH-T610					
FH-T3000					
FH-TX500-8-QR					
FH-TX500-8-NT					
FH-QC400-HM	✓	✓	✓		
FH-QC300-HM					
O.L.D. 130 mm, Quick release type	FH-RS300	- *2	✓	✓	
HG spline L (ROAD 12/11-speed)	O.L.D. 142 mm, E-THRU type	FH-R7070			
		FH-RS770	✓ *1	✓ *1	✓ *1
		FH-RS470			
	O.L.D. 135 mm, Quick release type	FH-UR600	✓ *1	✓ *1	✓ *1
	O.L.D. 130 mm, Quick release type	FH-R7000			
FH-RS400		- *2	✓ *1	✓ *1	

*1 Need low spacer (1.85 mm.)

*2 Interference may occur with the rear derailleur and spokes.

Drivetrain for MTB, LIFESTYLE components

Rear drivetrain compatibility

9,10,11-speed rear drivetrain

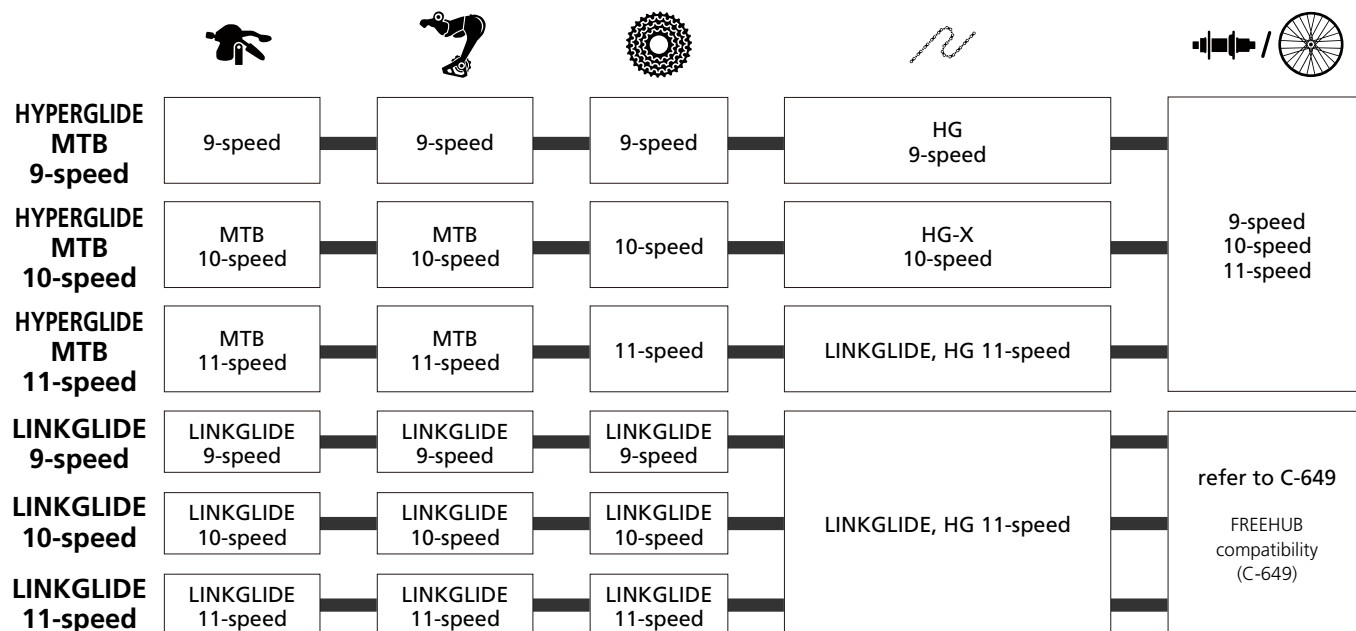

11-speed rear drivetrain

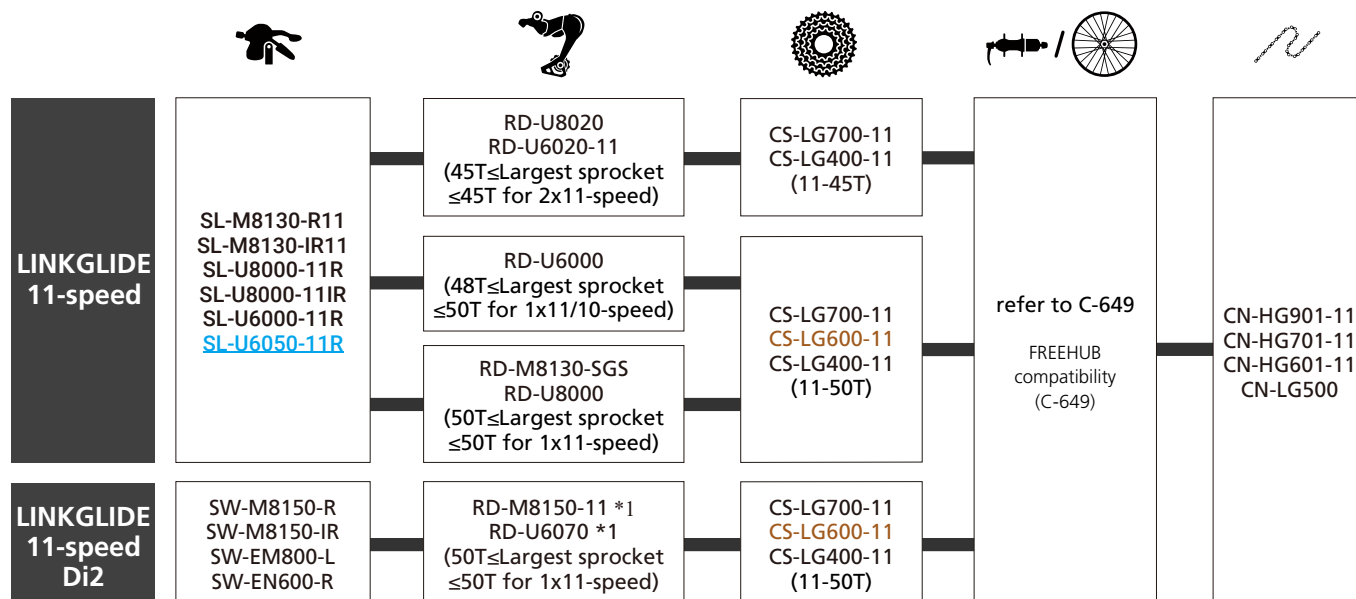

*1 Only for E-BIKE

10-speed rear drivetrain

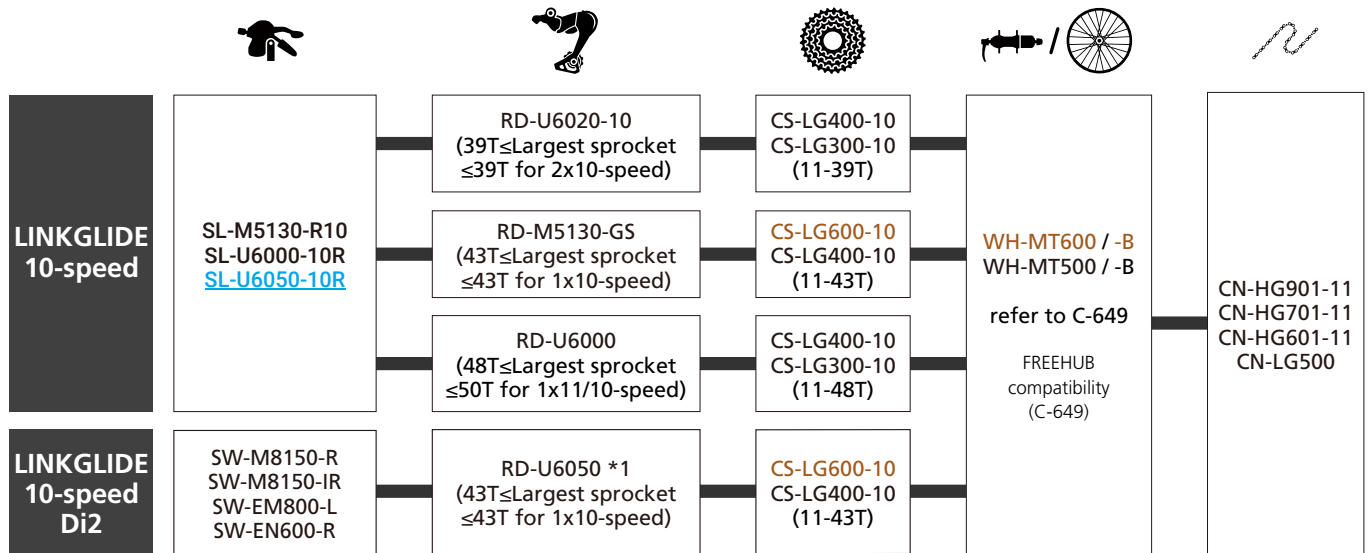

*1 Only for SHIMANO STEPS

9-speed rear drivetrain

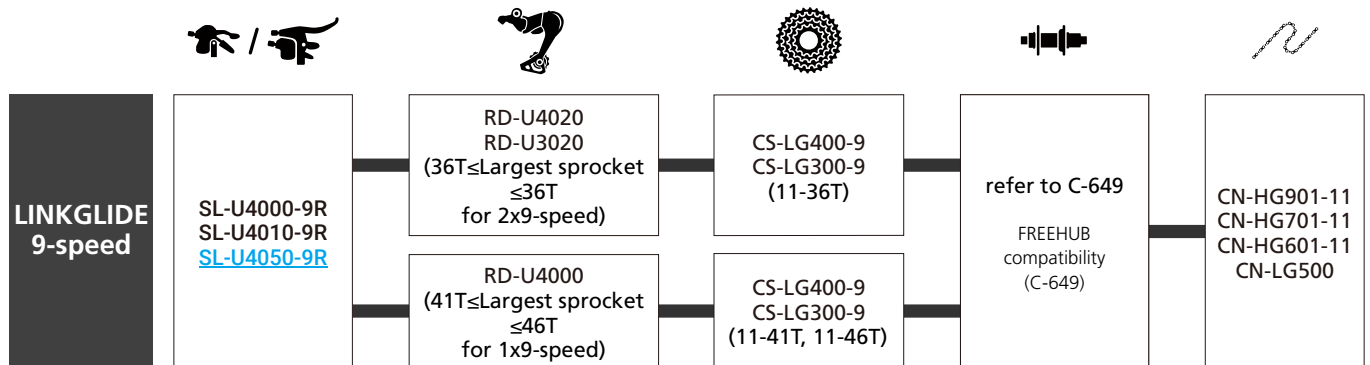

Front drivetrain compatibility

11-speed front drivetrain

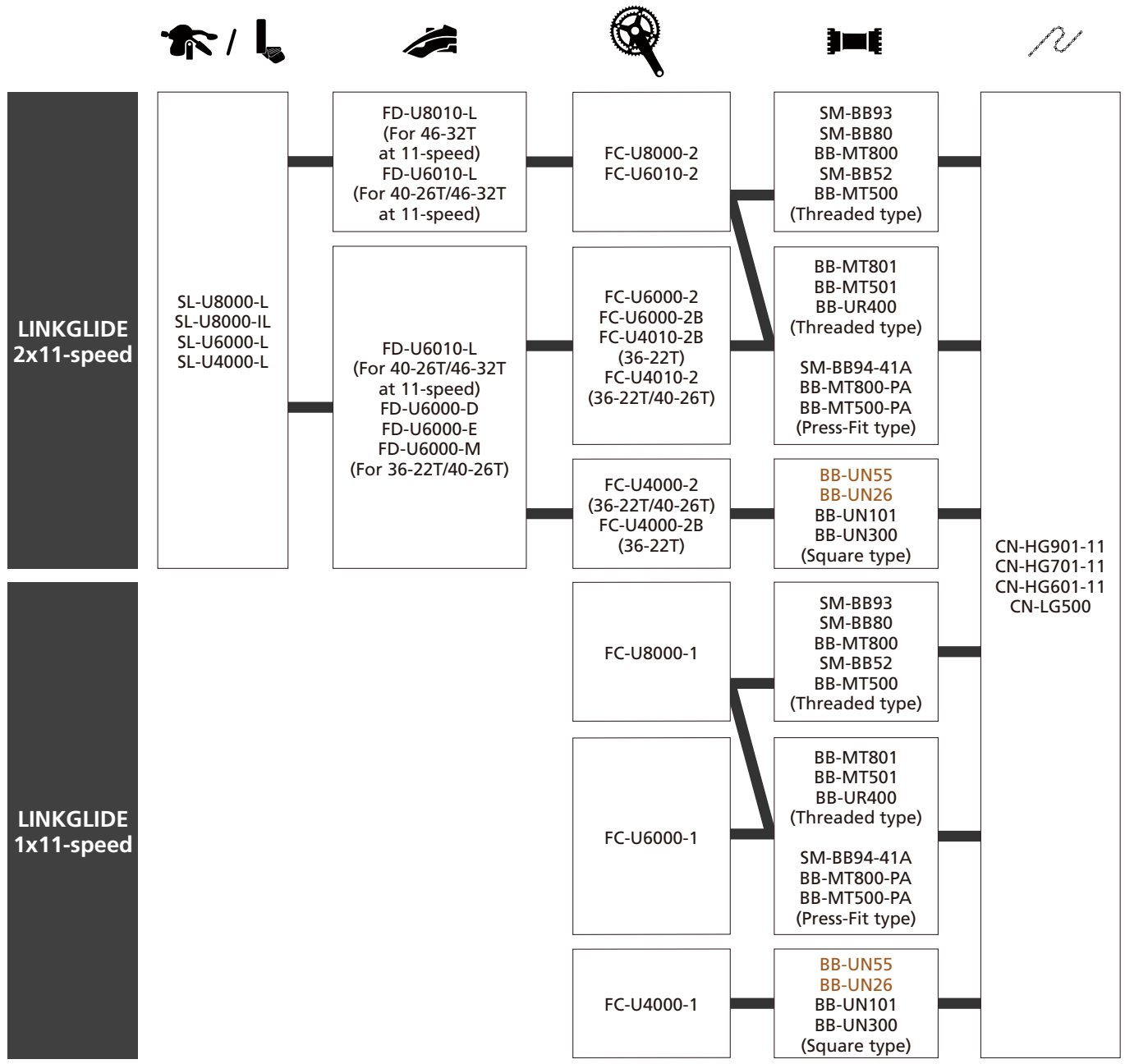

10-speed front drivetrain

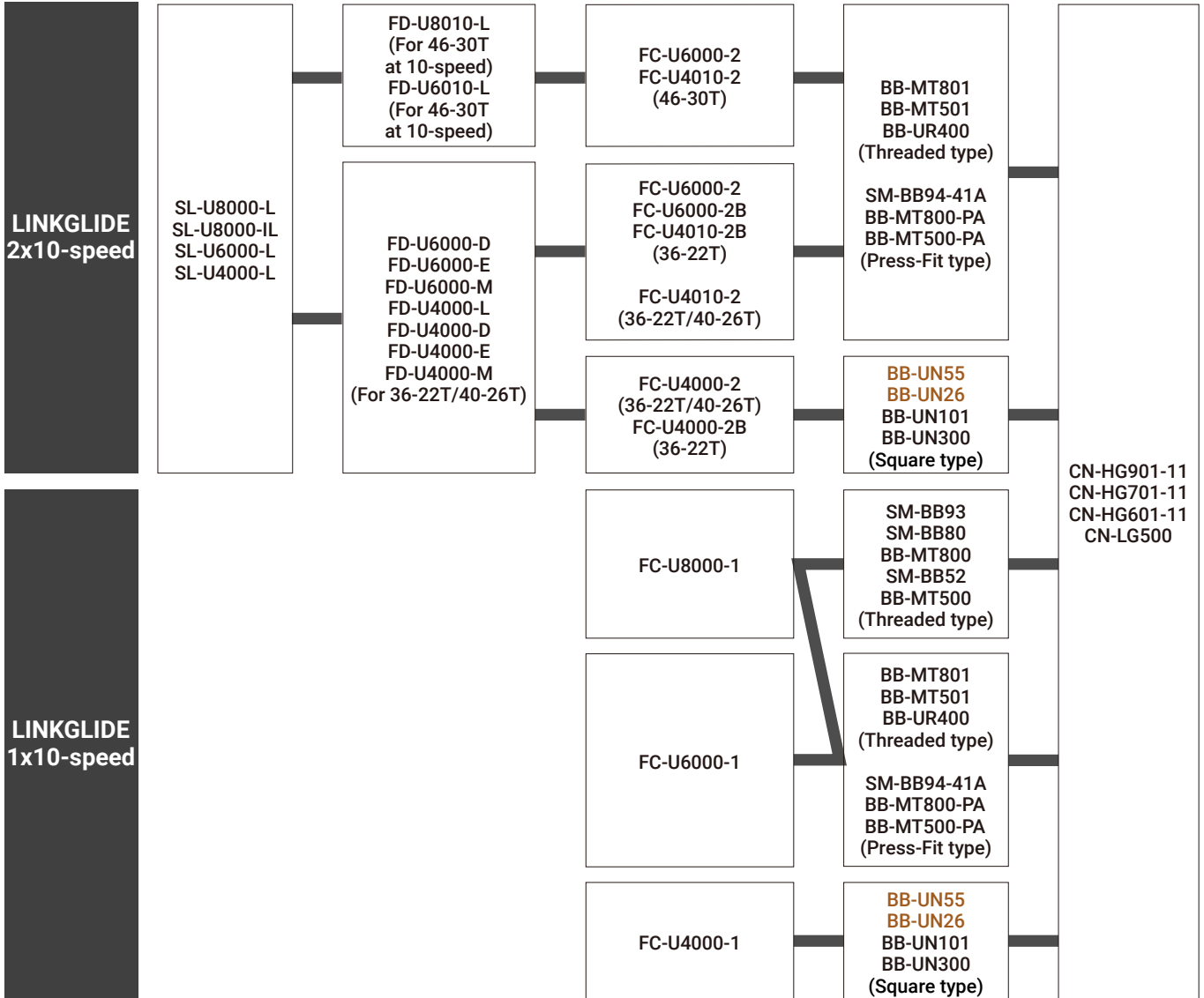

9-speed front drivetrain

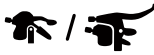

**LINKGLIDE
2x9-speed**

SL-U8000-L
SL-U8000-IL
SL-U6000-L
SL-U4000-L

FD-U4010-L
(For 46-30T)

FD-U4000-L
FD-U4000-D
FD-U4000-E
FD-U4000-M
(For 36-22T/40-26T)

FC-U6000-2
FC-U4010-2
(46-30T)

FC-U6000-2
FC-U6000-2B
FC-U4010-2B
(36-22T)

FC-U4010-2
(36-22T/40-26T)

FC-U4000-2
(36-22T/40-26T)
FC-U4000-2B
(36-22T)

BB-MT801
BB-MT501
BB-UR400
(Threaded type)

SM-BB94-41A
BB-MT800-PA
BB-MT500-PA
(Press-Fit type)

BB-UN55
BB-UN26
BB-UN101
BB-UN300
(Square type)

CN-HG901-11
CN-HG701-11
CN-HG601-11
CN-LG500

**LINKGLIDE
1x9-speed**

FC-U8000-1

FC-U6000-1

FC-U4000-1

SM-BB93
SM-BB80
BB-MT800
SM-BB52
BB-MT500
(Threaded type)

BB-MT801
BB-MT501
BB-UR400
(Threaded type)

SM-BB94-41A
BB-MT800-PA
BB-MT500-PA
(Press-Fit type)

BB-UN55
BB-UN26
BB-UN101
BB-UN300
(Square type)

CN-HG901-11
CN-HG701-11
CN-HG601-11
CN-LG500