

E6000 Series Drive Unit

DU-E6000 Drive Unit with Cover

DU-E6010 Drive Unit

SM-DUE10 Speed Sensor Unit

DU-E6001 Drive Unit

DU-E6050 Drive Unit

SM-DUE60 0 degree/45 degree Drive Unit Cover

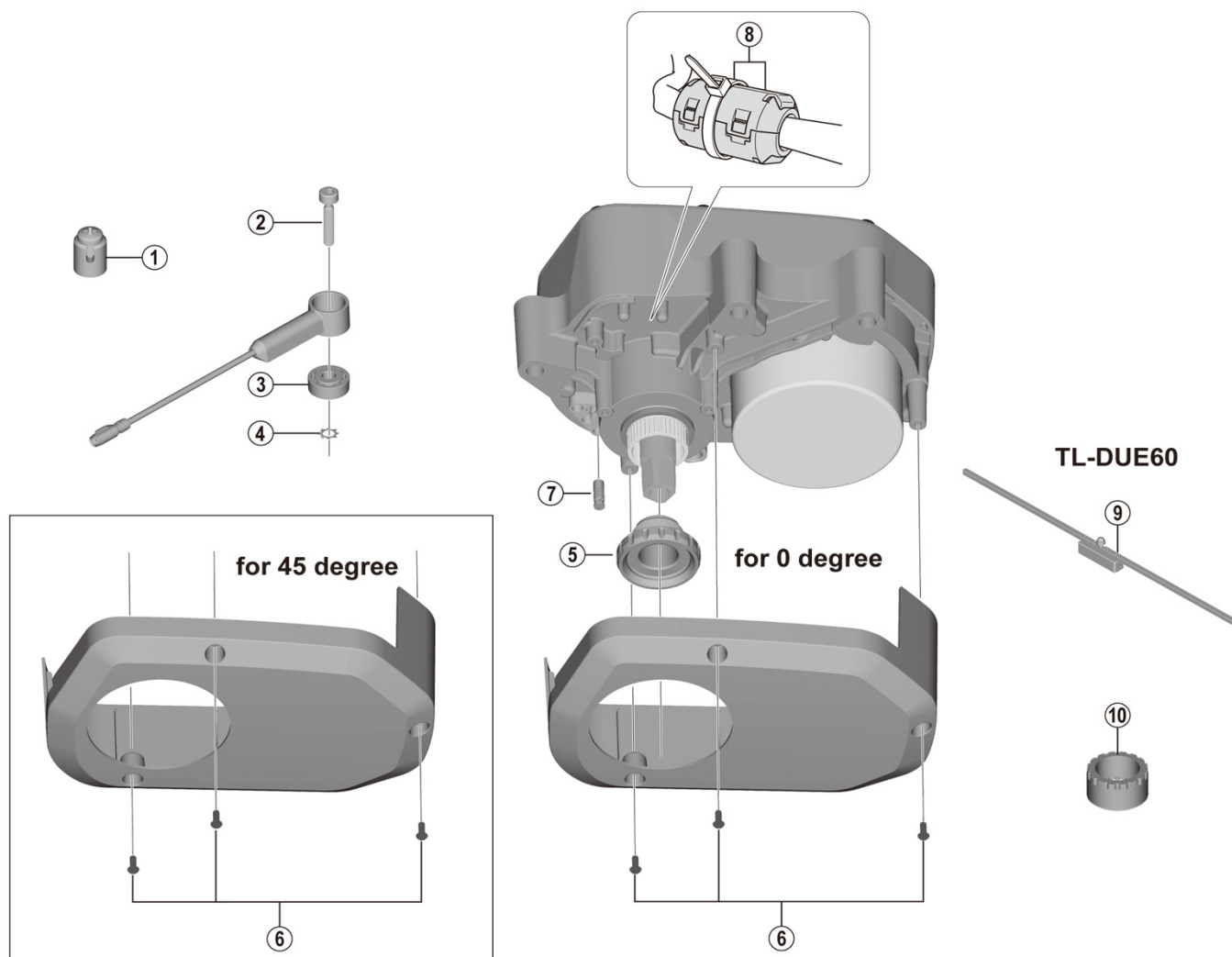

ITEM NO.	SHIMANO CODE NO.	DESCRIPTION
1	Y72H98010	Magnet unit
2	Y70L000G0	Speed sensor fixing screw L16 (4 mm hexagon head)
	Y70L000U0	Speed sensor fixing screw L22 (4 mm hexagon head)
	Y72H00012	Speed sensor fixing screw L16 (HEXALOBULAR T25 head)
	Y72H00013	Speed sensor fixing screw L22 (HEXALOBULAR T25 head)
3	Y70L000F0	Spacer
4	Y70L000M0	Toothed washer
5	Y70L00010	Lock ring
6	Y70L98030	Fixing screws (M3 x 8) set for SM-DUE60 0 degree and 45 degree
7	Y6VE15000	Dummy plug
8	Y70L98040	Ferrite core and zip tie
9	YEZY00002	TL-DUE60 Chain tension measurement tool
10	YEZY00010	TL-FC38 Adapter removal tool

A: Same parts.

B: Parts are usable, but differ in materials, appearance, finish, size, etc.

Absence of mark indicates non-interchangeability.

Specifications are subject to change without notice.

Nov.-2021-37611

© Shimano Inc. I

SHIMANO