

## User's Manual

# E-TUBE PROJECT Cyclist Connection Guide

Check our website for the latest manuals.  
<https://si.shimano.com>



---

## Contents

<b>Supported models and connection method .....</b>	<b>3</b>
<b>Connecting to the bicycle.....</b>	<b>5</b>
Introduction .....	5
For Di2 rear derailleur (with wireless function) .....	6
• Switching operation modes .....	6
For a motor unit (with wireless function) .....	7
• Switching operation modes .....	7
For wireless unit .....	8
• Switching operation modes .....	8
For system information display .....	9
• Switching operation modes .....	9
For SHIMANO E-BIKE SYSTEMS cycle computer (SC-E8000) .....	10
For SHIMANO E-BIKE SYSTEMS cycle computer (excluding SC-E8000)/switch/ junction [A].....	11
For power meter .....	12

# Supported models and connection method

A bike configuration that contains one of the following models with a Bluetooth® LE function is required to connect with E-TUBE PROJECT Cyclist.

Tap the product image to refer to the setting procedure for the Bluetooth® LE connection mode.

- Di2 rear derailleur (with wireless function)



- Motor unit (with wireless function)



- Wireless unit



- System information display



- SHIMANO E-BIKE SYSTEMS cycle computer/switch/junction [A]

[SC-EM800](#)



[SC-E7000](#)



[SC-E6100](#)



[SC-E8000](#)



[SW-EN600L](#)



[EW-EN100](#)



- Power meter

[FC-R9200-P](#)  
[FC-R9200-PX](#)



[FC-R8100-P](#)



[FC-R9100-P](#)



# Connecting to the bicycle

## Introduction

Before connection, turn on Bluetooth<sup>®</sup> LE function on the smartphone.

- [For Di2 rear derailleur \(with wireless function\)](#)
- [For a motor unit \(with wireless function\)](#)
- [For wireless unit](#)
- [For system information display](#)
- [For SHIMANO E-BIKE SYSTEMS cycle computer \(SC-E8000\)](#)
- [For SHIMANO E-BIKE SYSTEMS cycle computer \(excluding SC-E8000\)/switch/junction \[A\]](#)
- [For power meter](#)

## For Di2 rear derailleur (with wireless function)

1. Start E-TUBE PROJECT Cyclist and set it to listen for Bluetooth<sup>®</sup> LE signals.
2. Press and hold the function button until the LED flashes blue.

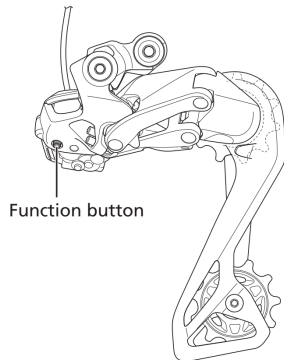

3. **The bicycle side is ready to connect.**

The unit name is displayed on the E-TUBE PROJECT screen.

If the unit is already registered, the connection automatically starts.

\* Release the function button as soon as the bicycle side is ready to be connected. If the function button is held down for any longer, a different mode will be activated.

4. **Select the unit name displayed on screen.**

When disconnecting, cancel the Bluetooth<sup>®</sup> LE connection from the smartphone. (The bicycle will switch from the connection mode to the normal operation mode.)

## Switching operation modes

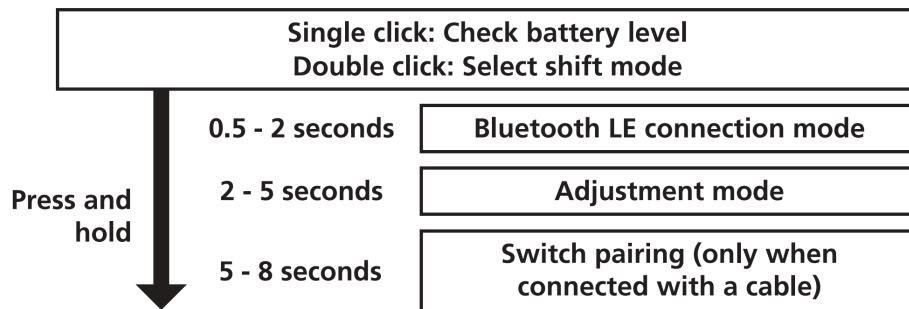

For the setting procedure, contact your place of purchase or a distributor.

## For a motor unit (with wireless function)

1. Start E-TUBE PROJECT Cyclist and set it to listen for Bluetooth<sup>®</sup> LE signals.
2. Press and hold the function button until the LED flashes blue.

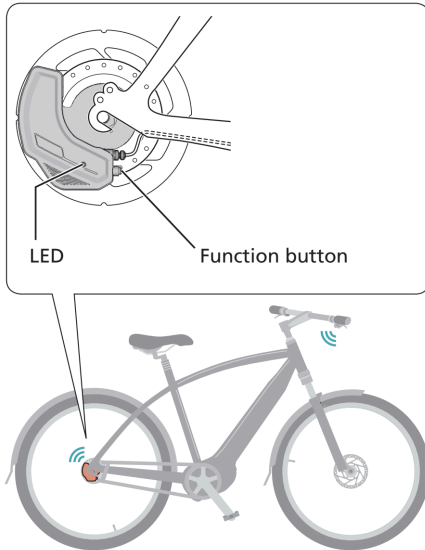

3. The bicycle side is ready to connect.

The unit name is displayed on the E-TUBE PROJECT screen.

If the unit is already registered, the connection automatically starts.

\* Release the function button as soon as the bicycle side is ready to be connected. If the function button is held down for any longer, a different mode will be activated.

4. Select the unit name displayed on screen.

When disconnecting, cancel the Bluetooth<sup>®</sup> LE connection from the smartphone. (The bicycle will switch from the connection mode to the normal operation mode.)

## Switching operation modes

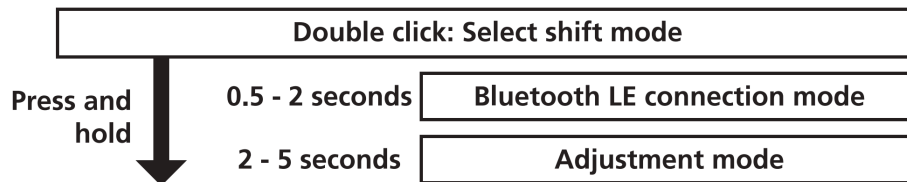

For the setting procedure, contact your place of purchase or a distributor.

## For wireless unit

1. Start E-TUBE PROJECT Cyclist and set it to listen for Bluetooth<sup>®</sup> LE signals.
2. Press and hold the junction [A] button until the green LED and red LED start blinking alternately.
3. The bicycle side is ready to connect.

The unit name is displayed on the E-TUBE PROJECT Cyclist screen.

If the unit is already registered, the connection automatically starts.

\* Release the button as soon as the bicycle side is ready to be connected. If the button is held down for any longer, a different mode will be activated.

4. Select the unit name displayed on screen.

When disconnecting, cancel the Bluetooth<sup>®</sup> LE connection from the smartphone. (The bicycle will switch from the connection mode to the normal operation mode.)

## Switching operation modes

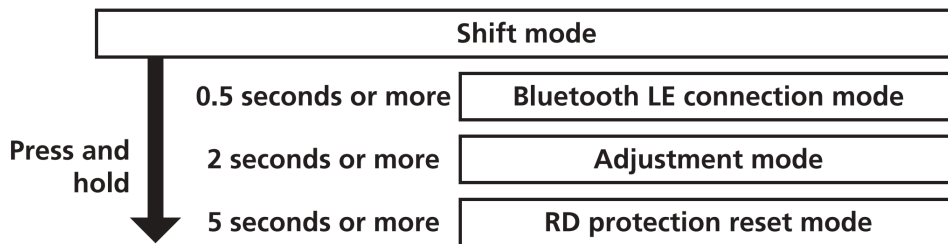

To end adjustment mode or RD protection reset mode, press and hold for 0.5 seconds or more.

For the setting procedure, contact your place of purchase or a distributor.

## For system information display

1. Start E-TUBE PROJECT Cyclist and set it to listen for Bluetooth<sup>®</sup> LE signals.
2. Press and hold the mode switch on the bicycle until "C" appears on the display.



3. The bicycle side is ready to connect.

The unit name is displayed on the E-TUBE PROJECT Cyclist screen.

If the unit is already registered, the connection automatically starts.

\* Release the mode switch as soon as the bicycle side is ready to be connected. If the mode switch is held down for any longer, a different mode will be activated.

4. Select the unit name displayed on screen.

When disconnecting, cancel the Bluetooth<sup>®</sup> LE connection from the smartphone. (The bicycle will switch from the connection mode to the normal operation mode.)

## Switching operation modes

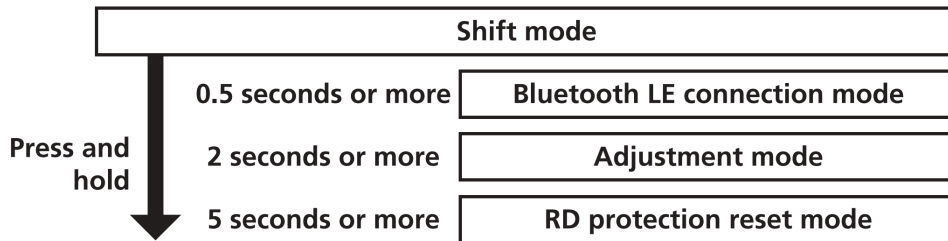

To end adjustment mode or RD protection reset mode, press and hold for 0.5 seconds or more.

For the setting procedure, contact your place of purchase or a distributor.

# For SHIMANO E-BIKE SYSTEMS cycle computer (SC-E8000)

1. **Start E-TUBE PROJECT Cyclist and set it to listen for Bluetooth<sup>®</sup> LE signals.**
2. **Press X or Y to select [Start] and press A to start Bluetooth<sup>®</sup> LE pairing.**  
Press A to start Bluetooth<sup>®</sup> LE pairing.

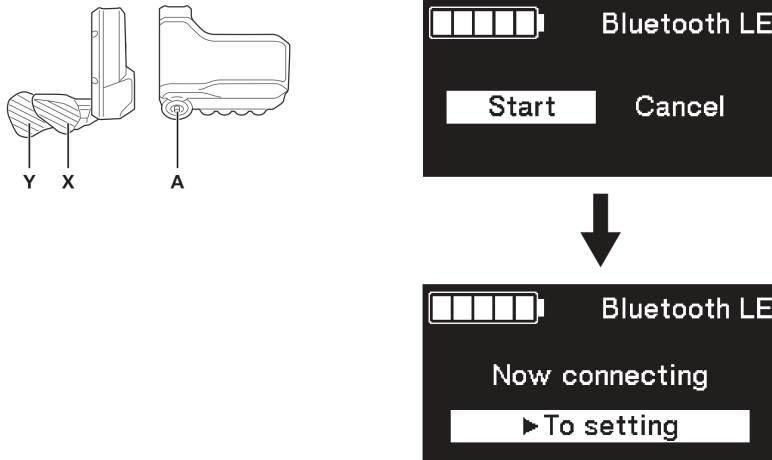

If the connection is successful, the logo is displayed on the screen.  
If the connection fails, a message indicating so is displayed.



3. **Press X, Y, or A after a connection failure.**  
Otherwise, the screen will automatically return to the menu list screen after a while.
4. **The bicycle side is ready to connect.**  
The unit name is displayed on the E-TUBE PROJECT Cyclist screen.  
If the unit is already registered, the connection automatically starts.
5. **Select the unit name displayed on screen.**  
When disconnecting, cancel the Bluetooth<sup>®</sup> LE connection from the smartphone. (The bicycle will switch from the connection mode to the normal operation mode.)

## For SHIMANO E-BIKE SYSTEMS cycle computer (excluding SC-E8000)/switch/junction [A]

**1. Start E-TUBE PROJECT Cyclist and set it to listen for Bluetooth<sup>®</sup> LE signals.**

**2. Set the bicycle side ready to connect.**

Communication can only be received under the following conditions. Perform one of the operations:

- For 15 seconds after the main power of SHIMANO E-BIKE SYSTEMS is turned ON
- For 15 seconds after one of the buttons except for the power button of SHIMANO E-BIKE SYSTEMS is operated

**3. The bicycle side is ready to connect.**

The unit name is displayed on the E-TUBE PROJECT Cyclist screen.

If the unit is already registered, the connection automatically starts.

**4. Select the unit name displayed on screen.**

When disconnecting, cancel the Bluetooth<sup>®</sup> LE connection from the smartphone. (The bicycle will switch from the connection mode to the normal operation mode.)

## For power meter

1. Start E-TUBE PROJECT Cyclist and set it to listen for Bluetooth<sup>®</sup> LE signals.
2. Press the button of the control unit.

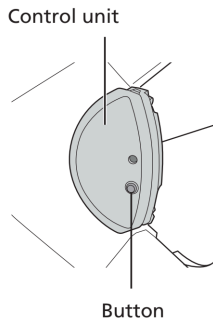

3. The bicycle side is ready to connect.

The unit name is displayed on the E-TUBE PROJECT Cyclist screen.

If the unit is already registered, the connection automatically starts.

4. Select the unit name displayed on screen.

When disconnecting, cancel the Bluetooth<sup>®</sup> LE connection from the smartphone. (The bicycle will switch from the connection mode to the normal operation mode.)

# SHIMANO

**SHIMANO NORTH AMERICA BICYCLE, INC.**  
One Holland, Irvine, California 92618, U.S.A. Phone: +1-949-951-5003

**SHIMANO EUROPE B.V.**  
High Tech Campus 92, 5656 AG Eindhoven, The Netherlands Phone: +31-402-612222  
Only EU General Contact : [contactshimano@shimano-eu.com](mailto:contactshimano@shimano-eu.com)

**SHIMANO INC.**  
3-77 Oimatsu-cho, Sakai-ku, Sakai City, Osaka 590-8577, Japan

Please note: specifications are subject to change for improvement without notice. (English)  
© Oct. 2024 by SHIMANO INC. ITP