

# SERVICE INSTRUCTIONS

Before use, read these instructions carefully, and follow them for correct use.

Brake Lever

**BL-A251**

(Aero type)

**BL-A251-EX**

(Type corresponding to extension lever)

**BL-A25**

(Extension lever)

# EXAGE



The following products should be used together for the Shimano Linear Response (SLR).

- Brake Lever.....BL-A251/BL-A251-EX
- Caliper Brake.....BR-A250/BR-A450/BR-A350
- Outer Cable.....Shimano outer cable casing with liner

## Installation of the brake lever

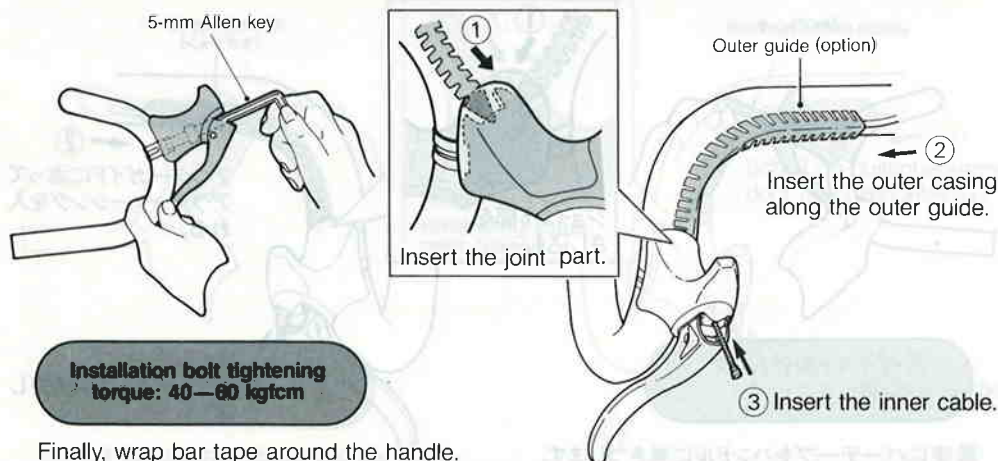

## Installation of the extension lever

Install by referring to the diagram below.

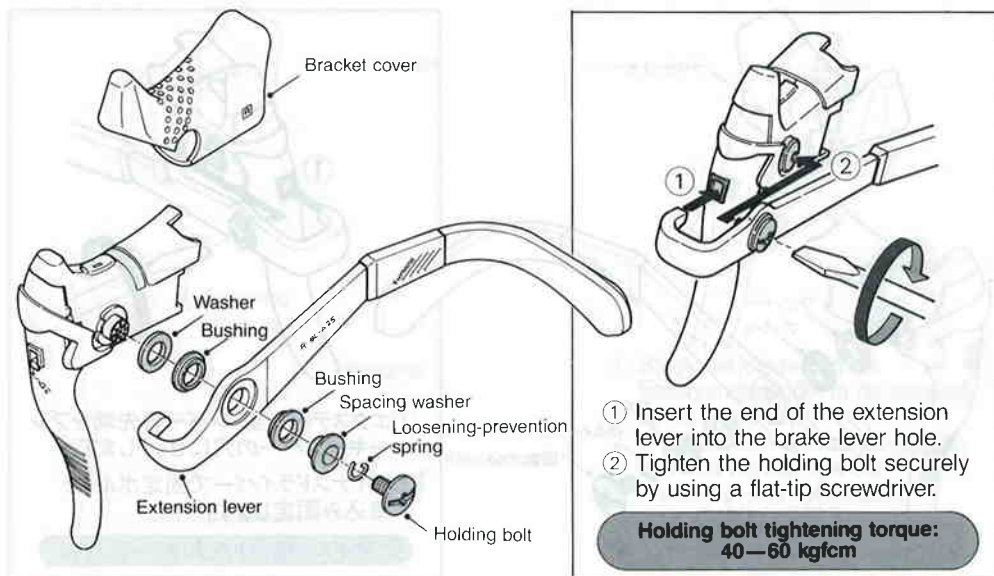

**SHIMANO**

Please note: Specifications are subject to change for improvement without notice. (English)

**SHIMANO AMERICAN CORPORATION**  
One Shimano Drive, Irvine, California U.S.A. 92718 Tel. (714) 951-5003

**SHIMANO (EUROPA) GmbH.**  
Im Hülsentfeld 13 4010 Hilden, West Germany Tel. 02103-5005-0

**SHIMANO (SINGAPORE) PTE. LTD.**  
No. 20, Benoi Sector, Jurong Town, Singapore 2262 Tel. 2654777

**SHIMANO INDUSTRIAL CO., LTD.**  
3-77 Oimatsucho, Sakai, Osaka, Japan Tel. (0722) 23-3243

© Jun. 1988 by Shimano Co., Ltd. R-47 XBC SZK Printed in Japan