

# SERVICE INSTRUCTION

## DURA-ACE BL-7401 SHIMANO 600 EX BL-6209



### BRAKE LEVERS

Before use, read these instructions carefully, and follow them for correct use.

### Specifications

- Weight: BL-7401 ..... 254g (left/right pair)  
BL-6209 ..... 244g (left/right pair)
- Material: light alloy
- Clamp band diameter:  $\phi 23.8\text{mm} \sim \phi 24.2\text{mm}$  (15/16" ~ 31/32")
- Cable: outer cable with liner

### How to install the brake lever

- 1 Insert the cable from the rear, and attach the inner end to the wire hook.

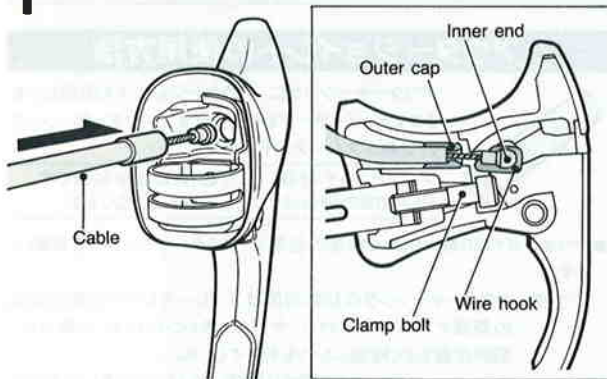

- 2 Secure the brake lever to the handlebar.

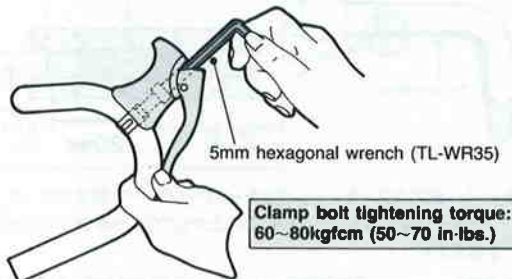

• Please note: Specifications are subject to change for improvement without notice.

SHIMANO SALES CORPORATION  
9530 Cozycroft Avenue, Chatsworth, California 91311 Tel. (818) 882-4411  
SHIMANO (SINGAPORE) PTE. LTD.  
No 20, Bendi Sector, Jurong Town, Singapore 2262 Tel. 2654777

SHIMANO AMERICAN CORPORATION  
205 Jefferson Road, Parsippany, New Jersey 07054 U.S.A. Tel. (201) 864-2300  
SHIMANO INDUSTRIAL CO., LTD.  
3-77 Oimatsucho, Sakai, Osaka, Japan Tel. (0722) 23-3243

SHIMANO (EUROPA) GmbH  
Im Huelensfeld 13 4010 Hilden, West Germany Tel. 02103 5006 16

- 3 With the cable placed along the front part of the handlebar, cover with the outer guide. Be sure that the installation is done so that the pointed part is at the lever side.

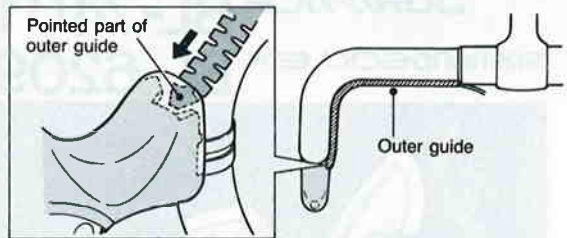

- 4 Cut the outer guide to correspond to the length of the handlebar.

- 5 Temporarily secure the outer guide to the handlebar (by using tape or similar material).

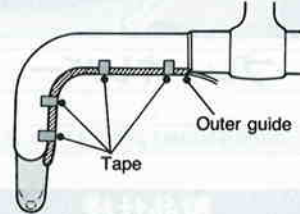

- 6 Then wrap the handlebar with handlebar tape.

### Note

The length of the cable should be long enough so that there is enough extra length when the handlebar is turned completely to the left and right.

### How to use the cable joint

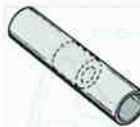

When the cable joint is used to divide the outer casing, the caliper side of the outer casing can be replaced easily, with the handlebar tape still wrapped.

The cable joint is standard equipment for BL-7401; for BL-6209, it is an optional part.

- Cut the outer casing at a point 20mm inward from the end of the outer guide.

Note: When cutting the outer casing, refer to the section "How to install the brake lever", and make the cut only after first installing the brake lever and cable to the handlebar and carefully checking the position where the cut will be made.

Be careful not to cut the inner cable when cutting the outer casing.

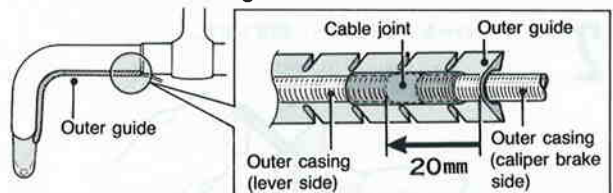

- Insert the lever side of the outer casing and the caliper brake side of the outer casing into the cable joint. Then cover them with the outer guide, and wrap with handlebar tape.
- To change the outer casing due to damage, change in stem height or color, only replacement of the caliper brake side of the outer casing is necessary.