

EXTENSION LEVER ASSEMBLY

Model BL-AD50
ADAMAS-AX Brake Lever

Model BL-AX50
PARAPUL-AX Brake Lever



Necessary parts for assembly

Confirm that the following parts listed below are available before assembling. And when ordering the parts, please include the code numbers listed below.

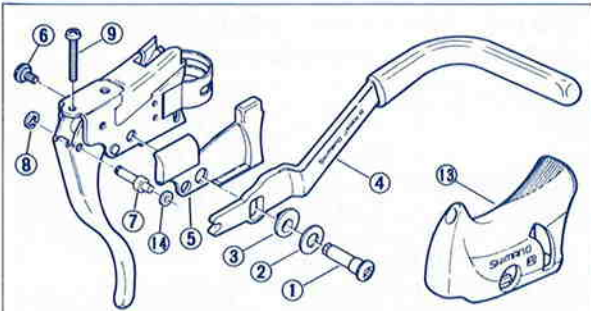

NO.	CODE NO.	PARTS NAME	AMOUNT
1	888 1600	Extension Lever Axle	2pcs
2	888 1800	Washer	2pcs
3		Eccentric Bush	2pcs
4	3-888 9001	Right Extension Lever	1pc
	3-888 9002	Left Extension Lever	1pc
5	888 1700	Holder (Right)	1pc
	888 1701	Holder (Left)	1pc
6	888 1900	Stopper Screw	2pcs
7	888 2000	Extension Pin	2pcs
8	531 1401	E Shape Stopper Ring (M3)	2pcs
9	888 1400	Adjusting Screw (M4x23)	2pcs
13	888 1300	Bracket Cover (Right)	1pc
	888 1301	Bracket Cover (Left)	1pc
14	888 2800	Rubber Ring	2pcs

Assembly Position

Assembly position of the extension type brake lever should be where the clearance between the extension lever and handle bar is around 10 mm as shown in the diagram.

When assembling the extension lever to the hooded-type brake lever which already has bar tape and there is some difficulty in making a clearance of 10mm between the handle bar and extension lever, unscrew the clamp bolt and then twist the hooded lever bracket so that there is at least some clearance between the handle bar and extension lever.

Tightening torque of the clamp bolt should be 40 kg-cm.

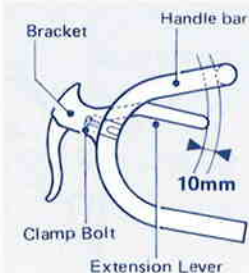

Assembly

- 1) Remove the adjusting screw, stopper screw, bracket cover and stopper axle from the hooded type brake lever in that order.

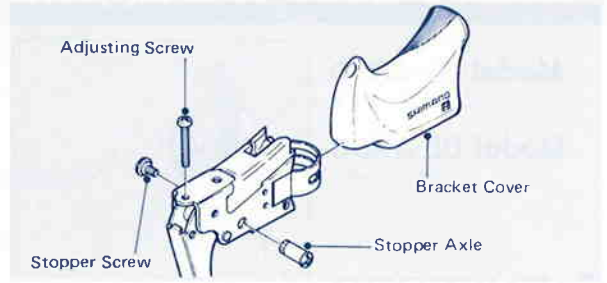

- 2) Insert the extension pin to the main lever, then fix with the E shape stopper ring. And then put the rubber ring onto the extension pin. Next insert the protruding section of the holder to the "A" hole of the bracket and then fix.
- 3) Check the signs "R" and "L" on the bracket cover and then assemble to the bracket. At that time, please confirm the holder position.

Note: "R" indicates the right side and "L" the left side.

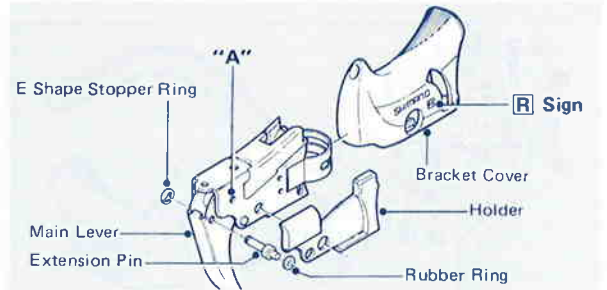

- 4) Insert the eccentric bush into the extension lever. Then insert the extension lever into the bracket cover hole and engage the concave section of the extension lever with the extension pin.

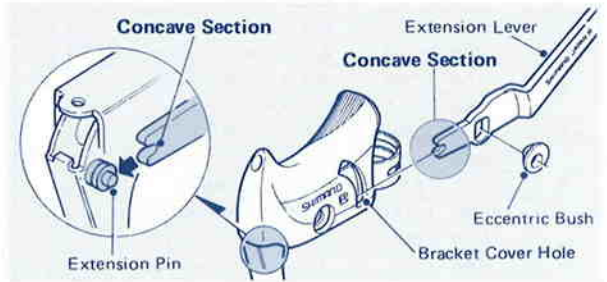

- 5) Pass the washer over the extension lever axle, then insert the extension lever axle end part into the octagonal hole on the bracket securely. Tighten with the stopper screw. Tightening torque of the stopper screw should be 15 kg-cm.
- 6) Assemble the adjusting screw to the bracket.

Now assembly is complete.

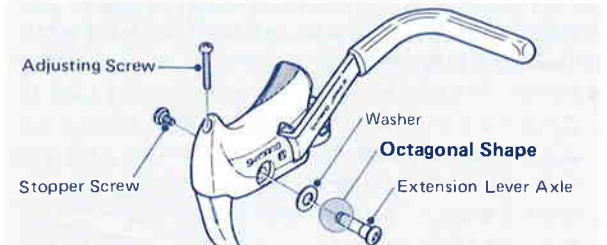

SHIMANO SALES CORPORATION
9259 San Fernando Road, Sun Valley, California 91352 Tel: (213) 767 7777
SHIMANO AMERICAN CORPORATION
205 Jefferson Road, Parsippany, New Jersey 07054 U.S.A. Tel: (201) 884 2300
SHIMANO (EUROPA) GmbH
Professor Deiters Str. 9, 4000 Düsseldorf 13, West Germany Tel: 793093-98

SHIMANO (SINGAPORE) PTE. LTD.
No. 20, Bencoolen Sector, Jurong Town, Singapore 2267 Tel: 654777
SHIMANO INDUSTRIAL CO., LTD.
3-77 Oimatsucho, Sakai, Osaka, Japan Tel: (0722) 23 3243