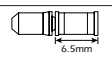
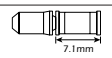

General Safety Information

WARNING

- Check that the wheels are fastened securely before riding the bicycle. If the wheels are loose in any way, they may come off the bicycle and serious injury may result.
- Use neutral detergent to clean the chain. Do not use alkali-based or acid based detergent such as rust cleaners as it may result in damage and/or failure of the chain.
- Use the reinforced connecting pin only for connecting the narrow type of chain.
- There are two different types of reinforced connecting pins available. Be sure to check the table below before selecting which pin to use. If connecting pins other than reinforced connecting pins are used, or if a reinforced connecting pin or tool which is not suitable for the type of chain is used, sufficient connection force may not be obtained, which could cause the chain to break or fall off.

Chain	Reinforced connecting pin	Chain tool
9-speed super narrow chain such as CN-7701 / CN-HG93	 Silver	TL-CN32/TL-CN23
8-/7-/6-speed narrow chain such as CN-HG50 / CN-IG51	 Black	TL-CN32/TL-CN23

- If it is necessary to adjust the length of the chain due to a change in the number of sprocket teeth, make the cut at some other place than the place where the chain has been joined using a reinforced connecting pin or an end pin. The chain will be damaged if it is cut at a place where it has been joined with a reinforced connecting pin or an end pin.
- Check that the tension of the chain is correct and that the chain is not damaged. If the tension is too weak or the chain is damaged, the chain should be replaced. If this is not done, the chain may break and cause serious injury.
- Obtain and read the service instructions carefully prior to installing the parts. Loose, worn, or damaged parts may cause injury to the rider. We strongly recommend only using genuine Shimano replacement parts.
- Read these Technical Service Instructions carefully, and keep them in a safe place for later reference.

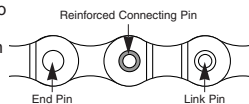

Note

- Adjust the RD-C201 reverse spring type rear derailleur from the low side.
- If gear shifting operations do not feel smooth, wash the derailleur and lubricate all moving parts.
- If the amount of looseness in the links is so great that adjustment is not possible, you should replace the derailleur.
- You should periodically clean the derailleur and lubricate all moving parts (mechanism and pulleys).
- If gear shifting adjustment cannot be carried out, check the degree of parallelism at the rear end of the bicycle. Also check if the cable is lubricated and if the outer casing is too long or too short.
- If you hear abnormal noise as a result of looseness in a pulley, you should replace the pulley.
- If the wheel becomes stiff and difficult to turn, you should lubricate it with grease.
- Do not apply any oil to the inside of the hub, otherwise the grease will come out.
- You should periodically wash the sprockets in a neutral detergent and then lubricate them again. In addition, cleaning the chain with neutral detergent and lubricating it can be an effective way of extending the useful life of the sprockets and the chain.
- If the chain keeps coming off the sprockets during use, replace the sprockets and the chain.
- Always be sure to use the sprocket set bearing the same group marks. Never use in combination with a sprocket bearing a different group mark.
- Use a frame with internal cable routing is strongly discouraged as it has tendencies to impair the SIS shifting function due to its high cable resistance.
- Use an outer casing which still has some length to spare even when the handlebars are turned all the way to both sides. Furthermore, check that the shifting lever does not touch the bicycle frame when the handlebars are turned all the way.
- Grease the inner cable and the inside of the outer casing before use to ensure that they slide properly.
- Operation of the levers related to gear shifting should be made only when the front chainwheel is turning.
- Parts are not guaranteed against natural wear or deterioration resulting from normal use.
- For maximum performance we highly recommend Shimano lubricants and maintenance products.
- For any questions regarding methods of installation, adjustment, maintenance or operation, please contact a professional bicycle dealer.

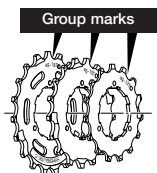

Technical Service Instructions

SI-0027B

Rear Drive System



In order to realize the best performance, we recommend that the following combination be used.

Series	Altus
Rapidfire Plus	ST-EF50-8RT
Outer casing	SIS
Rear derailleur	RD-C201
Type	MGS
Freehub	FH-RM30-8
Gears	8
Cassette sprocket	CS-HG50-8I / CS-HG40-8I
Chain	CN-HG50 / CN-HG40
Bottom bracket guide	SM-SP18 / SM-BT18

Specifications

Rear Derailleur

Model number	RD-C201
Type	MGS
Total capacity	43T
Largest sprocket	34T
Smallest sprocket	11T
Front chainwheel tooth difference	20T

Cassette sprocket tooth combination

Model number	Sprockets	Group name	Tooth combination
CS-HG50-8I	8	an	11, 13, 15, 17, 20, 23, 26, 30T
CS-HG40-8I	8	ao	11, 13, 15, 17, 20, 23, 26, 34T

Gear shifting operation

Both lever (A) and lever (B) always return to the initial position when they are released after shifting. When operating one of the levers, always be sure to turn the crank arm at the same time.

To shift from a large sprocket to a smaller sprocket (Lever A)

To shift one step only, press lever (A) to the (1) position. To shift two steps at one time, press to the (2) position.

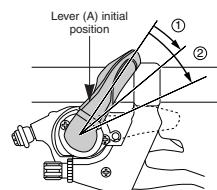

To shift from a small sprocket to a larger sprocket (Lever B)

Press lever (B) once to shift one step from a smaller to a larger sprocket.

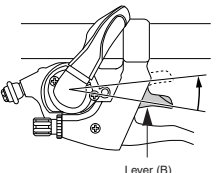

Installation of the rear derailleur

Direct-mount type

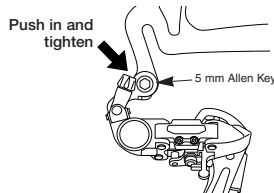

Tightening torque:
8 - 10 N·m {70 - 86 in. lbs.}

Bracket type

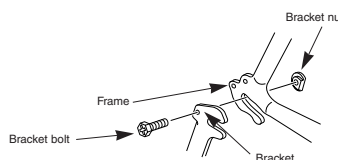

Tightening torque:
3 - 4 N·m {26 - 34 in. lbs.}

Installation of the sprockets

For each sprocket, the surface that has the group mark should face outward and be positioned so that the triangle (▲) mark on each sprocket and the A part (where the groove width is wide) of the freewheel body are aligned.

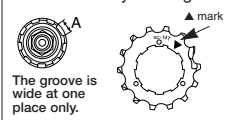

For installation of the HG sprockets, use the special tool (TL-LR15) to tighten the lock ring.

Tightening torque:
30 - 50 N·m {261 - 434 in. lbs.}

To replace the HG sprockets, use the special tool (TL-LR15) and TL-SR21 to remove the lock ring.

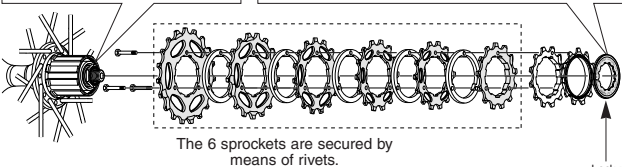
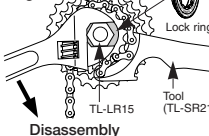

Chain length

Add 2 links (with the chain on both the largest sprocket and the largest chainring)

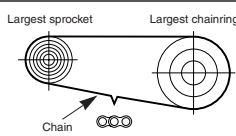

Mounting the shifting lever

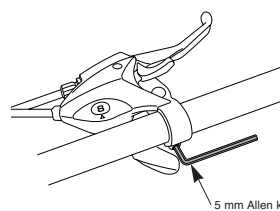

Use a handlebar grip with a maximum outer diameter of 32 mm.

Allen key tightening torque:
6 - 8 N·m {53 - 69 in. lbs.}

SIS Adjustment

Installation of the chain

Install the chain with the Pro-Set alignment block still attached. After installing, remove the Pro-Set alignment block.

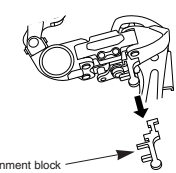

Turn the crank arm to set the derailleur to the low position.

1. Low adjustment

Turn the low adjustment screw so that the guide pulley moves to a position directly in line with the largest sprocket.

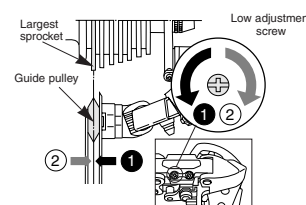

2. Top adjustment

Turn the crank arm while pulling the derailleur with your hand to move the derailleur to the top position, and then turn the top adjustment screw to adjust so that the guide pulley is in line with the outer line of the smallest sprocket when looking from the rear. Turn the crank arm to set the derailleur to the low position.

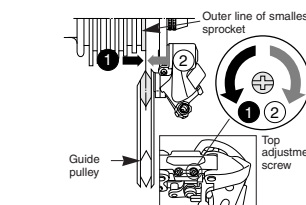

3. Securing the outer cable and inner cable

Operate lever (B) at least 7 times to set the lever to the lowest position. Remove the screw, and then remove the cover. Pull out the inner cable as shown in Figure, and then install the new inner cable.

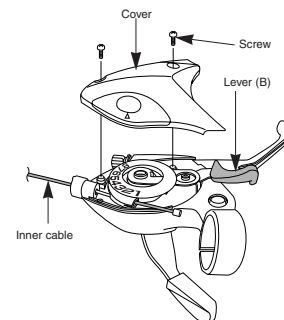

Tightening torque:
0.3 - 0.5 N·m {3 - 4 in. lbs.}

Inserting the inner cable

Insert the inner cable into the outer casing from the end with the marking in order to maintain cable operating efficiency.



Place the outer casing so that it does not touch the basket and mudguard, otherwise it may cause a problem with the performance of the derailleur.

Set the outer casing so that its length is as follows.

•If routing the casing upward:
(The chain should be on the largest chainring and on the largest sprocket.)

Add 10 mm to the length of the outer casing from the end that is inserted into the outer casing holder to the end which is inserted into the link.

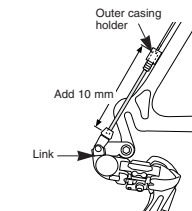
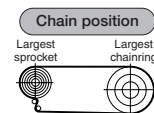

•If routing the casing downward:
(The chain should be on the largest chainring and on the largest sprocket.)

Set the length of the outer casing so that it describes a smooth arc, and so that the link stops in a position where there is a small gap between the link and the link stop.

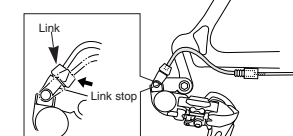
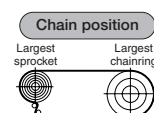

Connect the inner cable to the derailleur as shown in the illustration.

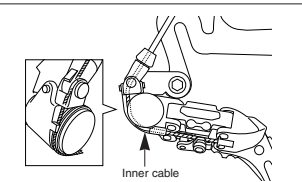

Cutting the outer casing

When cutting the outer casing, cut the opposite end to the end with the marking. After cutting the outer casing, make the end round so that the inside of the hole has a uniform diameter.

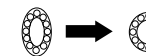

Attach the same outer end cap to the cut end of the outer casing.

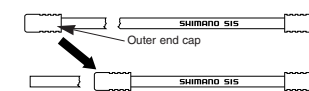

Note:

Be sure that the cable is securely in the groove.

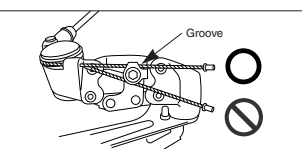

Connect the cable to the rear derailleur and, after taking up the initial slack in the cable, re-secure to the rear derailleur as shown in the illustration.

Tightening torque:
5 - 7 N·m {44 - 60 in. lbs.}



4. SIS adjustment

Push lever (B) while turning the crank arm to move the derailleur to the largest sprocket. Then operate lever (A) once to move the derailleur to the 2nd-gear sprocket. After this, operate lever (A) just as far as the extent of play, and then turn the crank arm.

When changing to 3rd



When no noise is heard at all

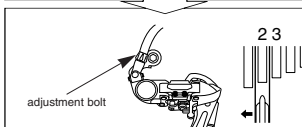
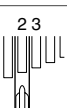

Turn the cable adjustment bolt clockwise to tighten it until the chain returns to the 2nd sprocket.

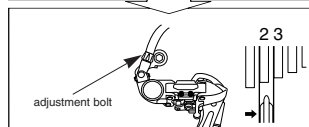

Turn the cable adjustment bolt counter-clockwise to loosen it until the chain touches a sprocket and generates noise.

Best setting

The best setting is when the cable adjustment bolt is tightened (turned clockwise) until noise occurs without lever (A) being operated, and then loosened (turned counter-clockwise) 90 - 180 degrees from that point.

Operate lever (A) to change gears, and check that no noise occurs in any of the gear positions.

For the best SIS performance, periodically lubricate all power-transmission parts.

Replacement of the freewheel body

After removing the hub axle, remove the freewheel body fixing bolt (inside the freewheel body), and then replace the freewheel body.

Note:
Do not attempt to disassemble the freewheel body, because it may result in a malfunction.

Tightening torque:
35 - 50 N·m {305 - 434 in. lbs.}

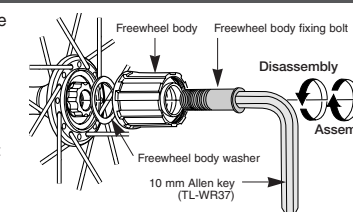

This service instruction explains how to use and maintain the Shimano bicycle parts which have been used on your new bicycle. For any questions regarding your bicycle or other matters which are not related to Shimano parts, please contact the place of purchase or the bicycle manufacturer.

SHIMANO

SHIMANO AMERICAN CORPORATION
One Holland, Irvine, California 92618, U.S.A. Phone: +1-949-951-5003

SHIMANO EUROPE B.V.
Industrieweg 24, 8071 CT Nunspeet, The Netherlands Phone: +31-341-272222

SHIMANO INC.
3-77 Oimatsu-cho, Sakai-shi, Osaka 590-8577, Japan

Please note: specifications are subject to change for improvement without notice. (English)
© Feb. 2006 by Shimano Inc. XBC SZK Printed in Singapore.