

SHIMANO

SHIMANO (EUROPA) GmbH.
Kleinhülsen 1-3 40724 Hilden, Germany
Tel. 02103-5005-0

SHIMANO AMERICAN CORPORATION
One Shimano Drive, P.O. Box 19615, Irvine,
California U.S.A. 92713-9615 Tel. (714) 951-5003

Small parts list for after market.

- You may photocopy this sheet and use it as an order form.
- Sie können dieses Blatt kopieren und als Bestellformular verwenden.
- Vous pouvez photocopier cette feuille et l'utiliser comme bon de commande.
- Dit blad kan gecopieerd en als bestelformulier gebruikt worden.
- Potete fotocopiare questo foglio e usarlo come modulo di commissione.

SHIMANO RSX Dual Control Lever ST-A410

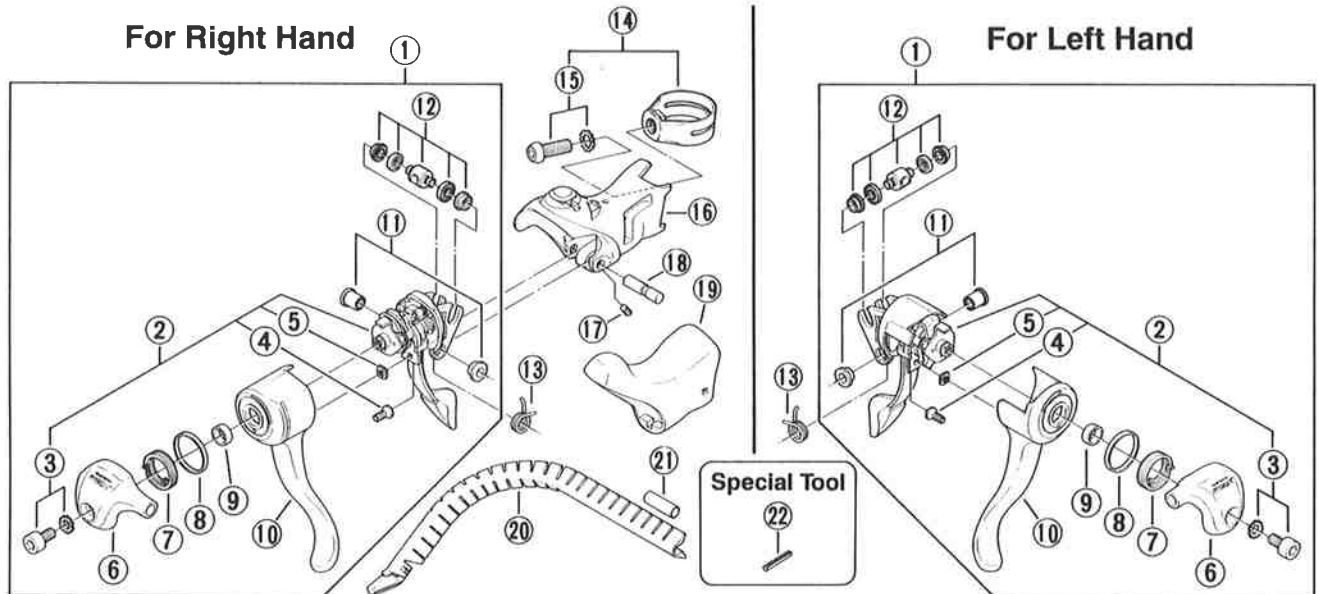

	Q'TY	ITEM NO.	PART NO.	DESCRIPTION	WEIGHT / PACK (g)	Q'TY / PACK
		1	6AE 9801	R.H. Main Lever Unit	242	1
			6AE 9802	L.H. Main Lever Unit	238	1
		2	6AE 9803	R.H. Release Lever Unit & Small Parts	182	1
			6AE 9804	L.H. Release Lever Unit & Small Parts	182	1
		3	65E 9805	Cap Fixing Bolt (M5 × 10) & Teethed Washer	44	10
		4	66E 3200	Release Lever Fixing Screw	8	10
		5	66E 4600	Non-Turn Washer	6	10
		6	6AE 5900	R.H. Outer Support Cap	116	1
			6AE 1700	L.H. Outer Support Cap	116	1
		7	66E 7300	R.H. Return Spring for Main Lever	38	10
			6AE 1600	L.H. Return Spring for Main Lever	38	10
		8	66E 7500	Ring for Main Lever	4	10
		9	66E 8800	Spacer for Main Lever	18	10
		10	6AE 9805	R.H. Main Lever	50	1
			6AE 9806	L.H. Main Lever	44	1
		11	85Z 9801	Lever Axle Bush Unit	8	10
		12	85Z 9802	Cable Hook Unit	36	10
		13	87G 0900	R.H. Return Spring	20	10
			87G 1000	L.H. Return Spring	20	10
		14	8TK 9801	Clamp Band Unit (φ 23.8 mm – φ 24.2 mm)	196	10
		15	67D 9819	Clamp Bolt (M6 × 18) & Teethed Washer	52	10
		16	8TK 9803	R.H. Bracket	346	1
			8TK 9804	L.H. Bracket	346	1
		17	884 1400	Lever Axle Fixing Screw	8	10
		18	87G 0500	Lever Axle	36	10
		19	85Z 9805	Bracket Covers (Pair / Black)	40	1
		20	86B 9001	Outer Cable Guide	66	10
		21	877 1100	Outer Cable Joint (Option)	20	10
		22	130 0310	Return Spring Installation Tool (TL-ST02)	12	10