

SHIMANO 105 Dual Control Lever

ST-5800-S Silver Version

ST-5800-L Black Version

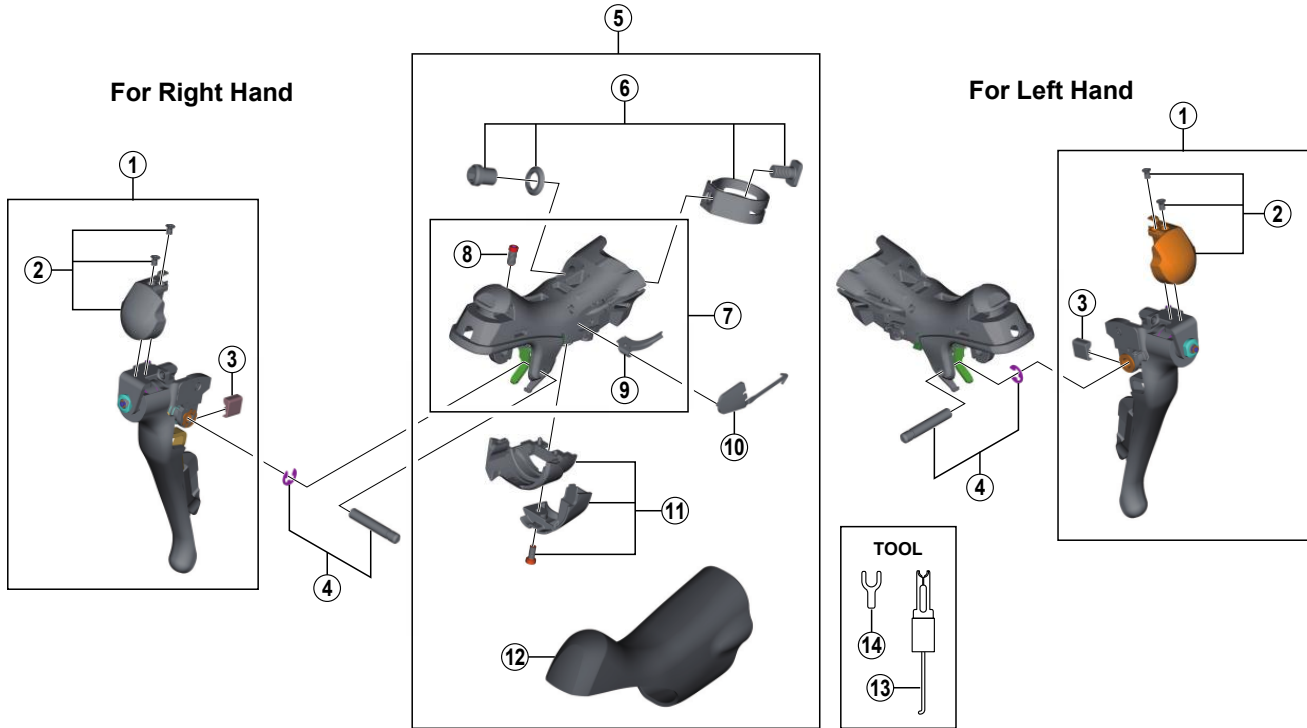

ST-5800

ITEM NO.	SHIMANO CODE NO.	DESCRIPTION	INTERCHANGEABILITY
1	Y01F98010	R.H. Main Lever Assembly (Silver) for ST-5800-S	
	Y01F98020	R.H. Main Lever Assembly (Black) for ST-5800-L	
	Y01G98010	L.H. Main Lever Assembly (Silver) for ST-5800-S	
	Y01G98020	L.H. Main Lever Assembly (Black) for ST-5800-L	
2	Y01F98030	R.H. Name Plate R & Fixing Screws	
	Y01G98030	L.H. Name Plate L & Fixing Screws	
3	Y63X80000	R.H. Main Lever Support R	A
	Y63X80010	L.H. Main Lever Support L	A
4	Y01G98070	Lever Axle & E-ring	
	Y01F98050	R.H. Bracket Unit	
5	Y01G98040	L.H. Bracket Unit	
	Y00E98050	Clamp Band Unit (ø23.8 mm - ø24.2 mm)	A
7	Y01F98070	R.H. Bracket	
	Y01G98050	L.H. Bracket	
8	Y00S000A0	Grip Adjusting Screw	
9	Y63X63000	R.H. SL Cable Guide R	A
	Y63X55000	L.H. SL Cable Guide L	A
10	Y00E75000	R.H. SL Cable Cover R	A
	Y00F75000	L.H. SL Cable Cover L	A
11	Y01F98080	R.H. Cover Unit	
	Y01G98060	L.H. Cover Unit	
12	Y00E98080	Bracket Covers (Black/Pair)	A
	Y00E98090	Bracket Covers (White/Pair)	A
13	Y6RT68000	Tool A for E-ring	A
14	Y6RT66000	Tool B for E-ring	A

A: Same parts.

B: Parts are usable, but differ in materials, appearance, finish, size, etc.

Absence of mark indicates non-interchangeability.

Aug.-2014-3711
© Shimano Inc. H

Specifications are subject to change without notice.

SHIMANO