

SHIMANO

SHIMANO EUROPA

Industrieweg 24 NL-8071 CT Nunspeet, Holland
Phone 31-3412-72222

SHIMANO AMERICAN CORPORATION

One Shimano Drive, P.O. Box 19615, Irvine,
California U.S.A. 92713-9615 Phone 714-951-5003

Small parts list for after market.

- You may photocopy this sheet and use it as an order form.
- Sie können dieses Blatt kopieren und als Bestellformular verwenden.
- Vous pouvez photocopier cette feuille et l'utiliser comme bon de commande.
- Dit blad kan gecopieerd en als bestelformulier gebruikt worden.
- Potete fotocopiare questo foglio e usarlo come modulo di commissione.

SHIMANO 105SC Dual Control Lever

ST-1055 / 1055-T For Triple Gear

For Right Hand

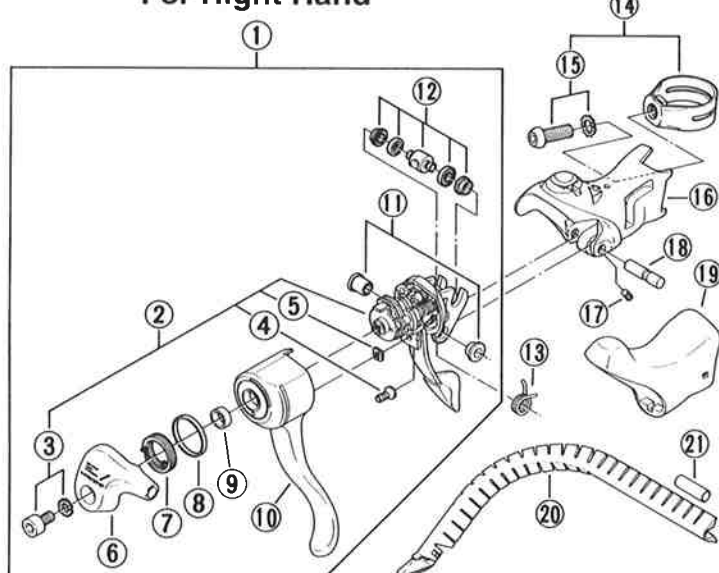

For Left Hand

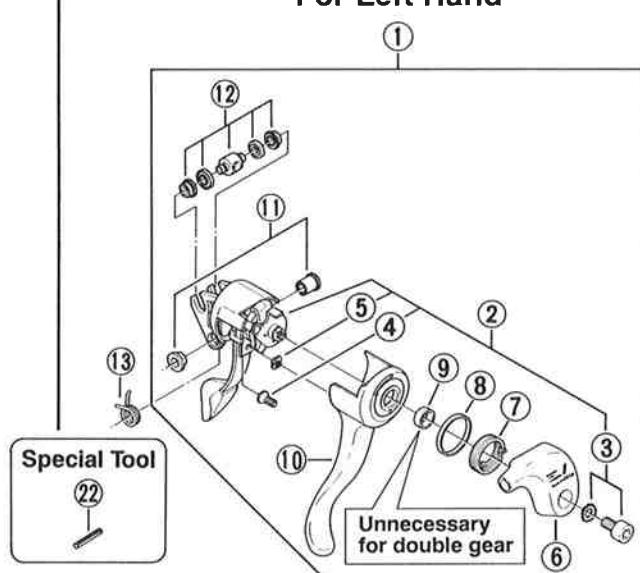

	Q'TY	ITEM NO.	PART NO.	DESCRIPTION	WEIGHT / PACK (g)	Q'TY / PACK
		1	65E 9801	R.H. Main Lever Unit	244	1
		*	65E 9802	L.H. Main Lever Unit for Double Gear	236	1
			65F 9801	L.H. Main Lever Unit for Triple Gear	246	1
		2	65E 9803	R.H. Release Lever Unit & Small Parts	98	1
		*	65E 9804	L.H. Release Lever Unit & Small Parts for Double Gear	94	1
			65F 9802	L.H. Release Lever Unit & Small Parts for Triple Gear	104	1
		3	65E 9805	Cap Fixing Bolt (M5 × 10) & Teethed Washer	44	10
		4	66E 3200	Release Lever Fixing Screw	8	10
		5	66E 4600	Non-Tum Washer	6	10
		6	65F 5600	R.H. Outer Support Cap	126	10
		*	65F 0200	L.H. Outer Support Cap for Double Gear	138	10
			65F 0800	L.H. Outer Support Cap for Triple Gear	122	10
			66E 7300	R.H. Main Lever Return Spring	38	10
		7	66E 4000	L.H. Main Lever Return Spring for Double Gear	38	10
		*	6AE 1600	L.H. Main Lever Return Spring for Triple Gear	38	10
		8	66E 7500	Main Lever Ring for R.H. / L.H. Triple Gear	4	10
			66E 1600	Main Lever Ring for L.H. Double Gear	4	10
		* 9	66E 8800	Main Lever Spacer for R.H. / L.H. Triple Gear	18	10
			65E 9808	R.H. Main Lever	50	1
		10	65E 9809	L.H. Main Lever for Double Gear	44	1
		*	65F 9803	L.H. Main Lever for Triple Gear	44	1
		11	85Z 9801	Lever Axle Bush Unit	8	10
		12	85Z 9802	Cable Hook Unit	36	10
			87G 0900	R.H. Return Spring	20	10
		13	87G 1000	L.H. Return Spring	20	10
		14	87G 9803	Clamp Band Unit (φ 23.8 mm – φ 24.2 mm)	196	10
		15	67D 9819	Clamp Bolt (M6 × 18) & Teethed Washer	52	10
		16	85Z 9803	R.H. Lever Bracket	66	1
			85Z 9804	L.H. Lever Bracket	66	1
		17	884 1400	Lever Axle Fixing Screw	8	10
		18	87G 0500	Lever Axle	36	10
			85Z 9805	Bracket Covers (Pair / Black)	40	1
		19	85Z 9806	Bracket Covers (Pair / White)	40	1
		20	86B 9001	Outer Cable Guide	66	10
		21	877 1100	Outer Cable Joint (Option)	20	10
		22	130 0310	Return Spring Installation Tool (TL-ST02)	12	10