

SHIMANO

SHIMANO EUROPA

Industrieweg 24 NL-8071 CT Nunspeet, Holland
Phone 31-3412-72222

SHIMANO AMERICAN CORPORATION

One Shimano Drive, P.O. Box 19615, Irvine,
California U.S.A. 92623-9615 Phone 714-951-5003

Small parts list for after market.

- You may photocopy this sheet and use it as an order form.
- Sie können dieses Blatt kopieren und als Bestellformular verwenden.
- Vous pouvez photocopier cette feuille et l'utiliser comme bon de commande.
- Dit blad kan gecopieerd en als bestelformulier gebruikt worden.
- Potete fotocopiare questo foglio e usarlo come modulo di commissione.

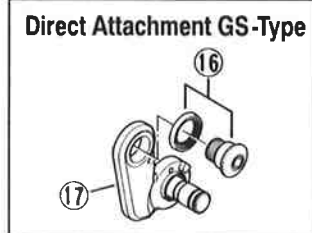
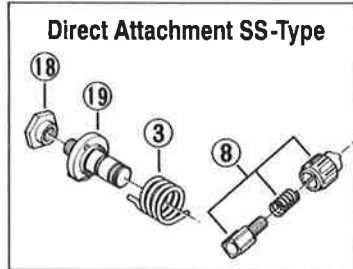
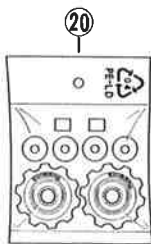
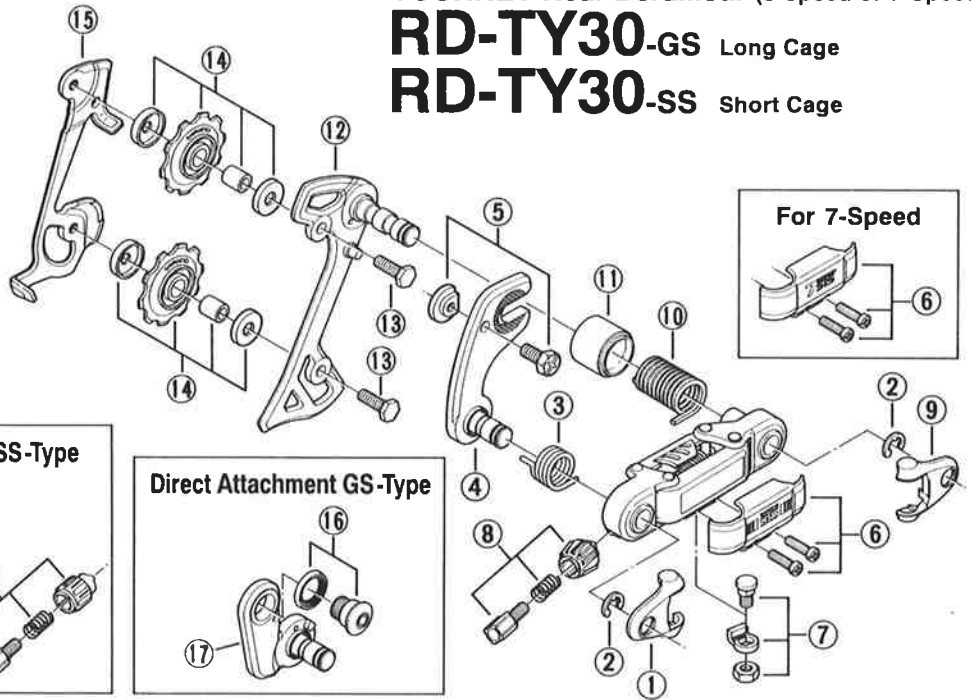
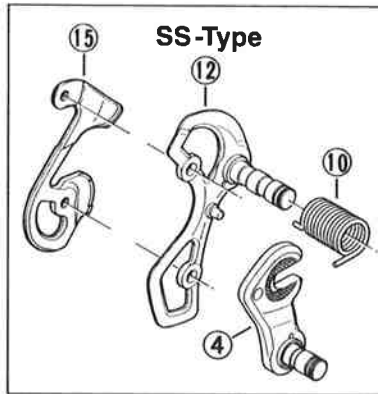

Q'TY	ITEM NO.	SHIMANO CODE NO.	DESCRIPTION
	1	54R 1110	B-Axle Cap
	2	521 3001	Stop Ring (φ 6 mm)
	3	54Y 2412	B-Tension Spring
		54Y 2400	B-Tension Spring (Direct Attachment SS-Type Only)
	4	54Z 9801	Adapter w/Mounting Shaft (GS-Type)
		54Z 9802	Adapter w/Mounting Shaft (SS-Type)
	5	525 9801	Adapter Screw (M5 × 11.5) & Nut
		54Z 9803	Stroke Adjusting Screws (M4 × 14.5) & Plate (6-Speed)
*	6	54Z 9812	Stroke Adjusting Screws (M4 × 14.5) & Plate (7-Speed)
	7	54Y 9806	Cable Fixing Bolt Unit
*	8	54N 9803	Cable Adjusting Bolt Unit
		54Z 9806	Cable Adjusting Bolt Unit (Direct Attachment SS-Type Only)
	9	54R 2010	P-Axle Cap
		522 2800	P-Tension Spring (GS-Type)
	10	54Y 2411	P-Tension Spring (SS-Type)
	11	54R 1900	P-Tension Spring Cover
		54Z 9807	Outer Plate w/Mounting Shaft (GS-Type)
		54Y 9802	Outer Plate w/Mounting Shaft (SS-Type)
	13	524 7200	Pulley Bolt (M5 × 15.4)
	14	563 9839	Pulley Unit
		511 0402	Inner Plate (GS-Type)
		539 2201	Inner Plate (SS-Type)
	16	54Z 9808	B-Axle & Spacer (Direct Attachment GS-Type)
	17	54Z 9809	Adapter w/Mounting Shaft (Direct Attachment GS-Type)
	18	521 3400	Nut B (Direct Attachment SS-Type)
	19	54Y 9804	B-Axle w/Stopper Plate (Direct Attachment SS-Type)
	*20	563 9810	Pulley Set (10 sets)