

SHIMANO

SHIMANO EUROPA

Industrieweg 24 NL-8071 CT Nunspeet, Holland
Phone 31-3412-72222

SHIMANO AMERICAN CORPORATION

One Shimano Drive, P.O. Box 19615, Irvine,
California U.S.A. 92713-9615 Phone 714-951-5003

Small parts list for after market.

- You may photocopy this sheet and use it as an order form.
- Sie können dieses Blatt kopieren und als Bestellformular verwenden.
- Vous pouvez photocopier cette feuille et l'utiliser comme bon de commande.
- Dit blad kan gecopieerd en als bestelformulier gebruikt worden.
- Potete fotocopiare questo foglio e usarlo come modulo di commissione.

TOURNEY Rear Derailleur (6-Speed)

RD-TY22-GS Long Cage

RD-TY22-SS Short Cage

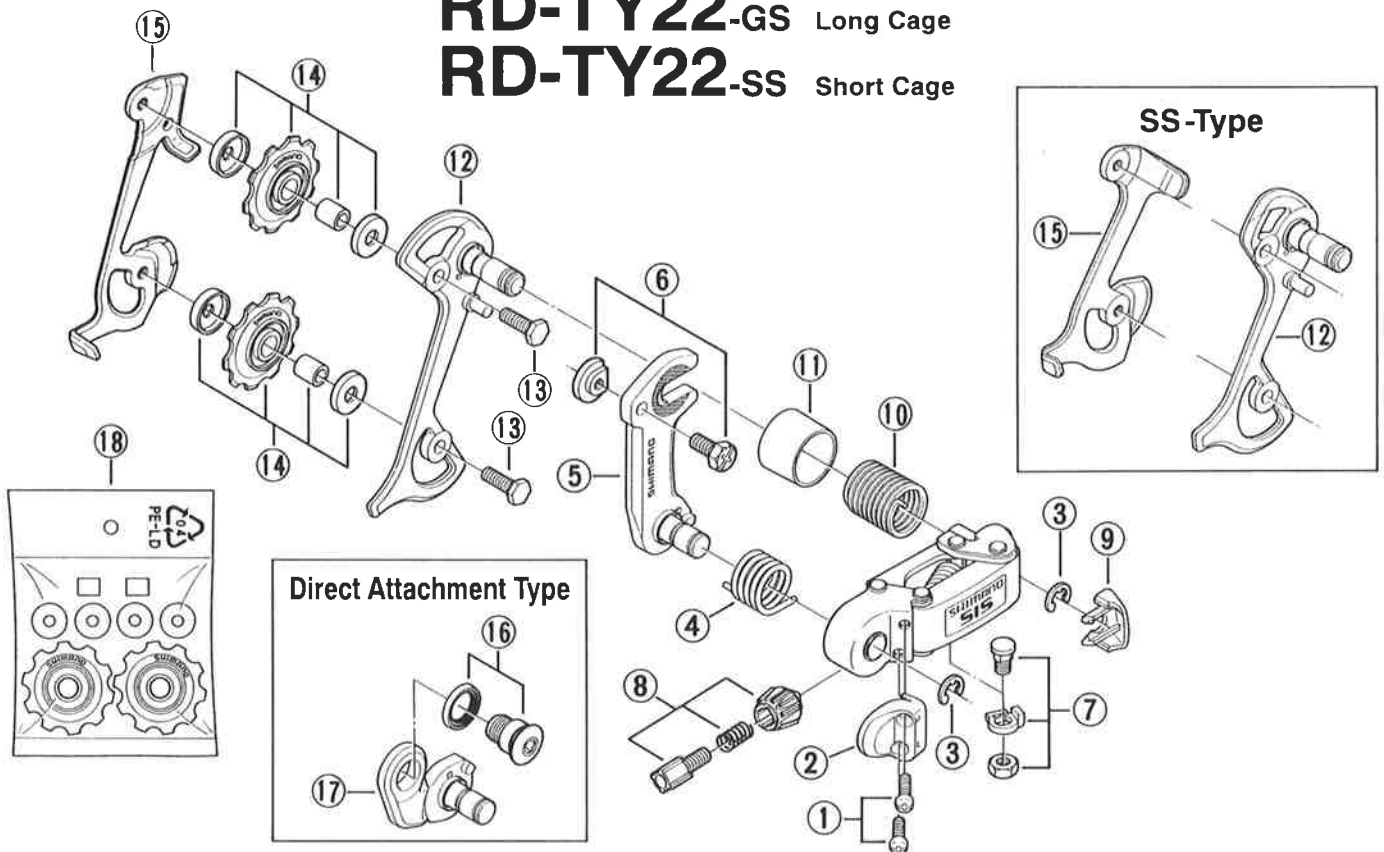

| | Q'TY | ITEM NO. | PART NO. | DESCRIPTION | WEIGHT / PACK (g) | Q'TY / PACK |
|--|------|----------|----------|---|-------------------|-------------|
| | | 1 | 517 9802 | Stroke Adjusting Screws (M4 × 14.5) 2pcs. | 30 | 10 |
| | | 2 | 54L 1200 | B-Axle Cap | 14 | 10 |
| | | 3 | 521 3001 | Stop Ring (φ6 mm) | 4 | 10 |
| | | 4 | 54L 1300 | B-Tension Spring | 50 | 10 |
| | | 5 | 54L 9801 | Adapter w/Mounting Shaft | 368 | 5 |
| | | 6 | 54M 9803 | Adapter Screw (M5 × 11.5) & Nut | 62 | 10 |
| | | 7 | 54N 9802 | Cable Fixing Bolt Unit | 64 | 10 |
| | | 8 | 54N 9803 | Cable Adjusting Bolt Unit | 48 | 10 |
| | | 9 | 54L 2800 | P-Axle Cap | 8 | 10 |
| | | 10 | 54L 2400 | P-Tension Spring | 108 | 10 |
| | | 11 | 54L 2700 | P-Tension Spring Cover | 8 | 10 |
| | | 12 | 54L 9802 | Outer Plate w/Mounting Shaft (GS-Type) | 62 | 1 |
| | | 12 | 54L 9803 | Outer Plate w/Mounting Shaft (SS-Type) | 54 | 1 |
| | | 13 | 524 7200 | Pulley Bolt (M5 × 15.4) | 30 | 10 |
| | | 14 | 563 9839 | Pulley Unit | 92 | 10 |
| | | 15 | 511 0402 | Inner Plate (GS-Type) | 376 | 10 |
| | | 15 | 54N 0900 | Inner Plate (SS-Type) | 260 | 10 |
| | | 16 | 54Z 9808 | B-Axle & Spacer (Direct Attachment Type) | 108 | 10 |
| | | 17 | 54L 9804 | Adapter w/Mounting Shaft (Direct Attachment Type) | 485 | 10 |
| | | 18 | 563 9810 | Pulley Set (10 sets) | 202 | 1 |