



**SHIMANO (EUROPA) GmbH.**

Kleinhülsen 1-3 4010 Hilden,  
West Germany Tel. 02103-5005-0

**SHIMANO AMERICAN CORPORATION**

One Shimano Drive, Irvine, California  
U.S.A. 92718 Tel. (714) 951-5003

## Small parts list for after market.

- You may photocopy this sheet and use it as an order form.
- Sie können dieses Blatt kopieren und als Bestellformular verwenden.
- Vous pouvez photocopier cette feuille et l'utiliser comme bon de commande.
- Dit blad kan gecopieerd en als bestelformulier gebruikt worden.
- Potete fotocopiare questo foglio e usarlo come modulo di commissione.

### RD-TY20-SS Rear Derailleur Short Cage

### RD-TY20-GS Rear Derailleur Long Cage

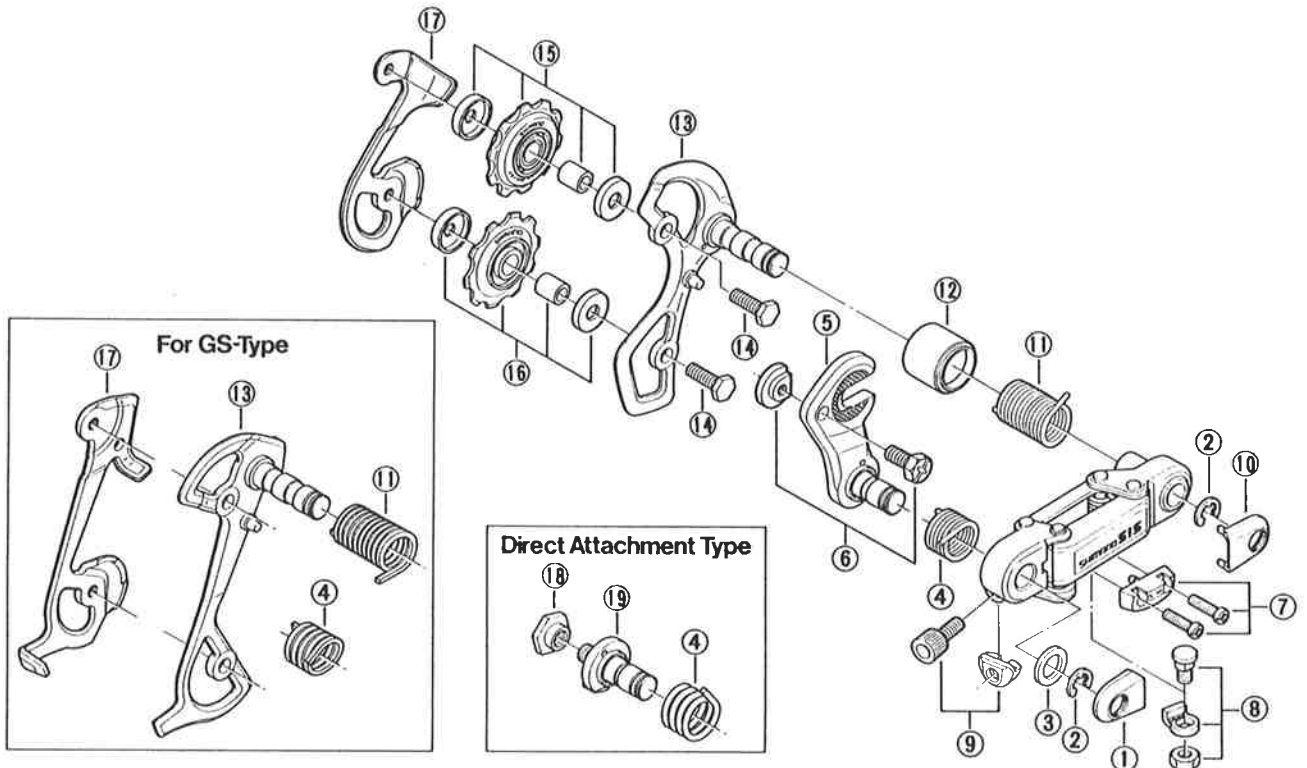

Q'TY	ITEM NO.	PART NO.	DESCRIPTION
	1	54Y 1300	Bracket Axle Cap
	2	521 3001	Stop Ring (ø6mm)
	3	521 3500	Spacer
	4	521 2601	B-Tension Spring (SS-Type) Adapter Type
		54Y 2400	B-Tension Spring (SS-Type) Direct Attachment Type
		522 2700	B-Tension Spring (GS-Type)
	5	54Y 9801	Adapter w/Mounting Shaft
	6	525 9801	Adapter Screw (M5x11.5) & Nut
	7	521 9823	Stroke Adjusting Screws (M4x14.5) & Plate
	8	54Y 9806	Cable Fixing Bolt Unit
	9	54Y 9805	Cable Adjusting Barrel & Plate
	10	54Y 2100	Plate Axle Cap
		521 1400-1	P-Tension Spring (SS-Type)
		522 2800	P-Tension Spring (GS-Type)
	12	54Y 2200	P-Tension Spring Cover
	13	54Y 9802	Outer Plate w/Mounting Shaft (SS-Type)
		54Y 9803	Outer Plate w/Mounting Shaft (GS-Type)
	14	524 7200	Pulley Bolt
	15	563 9837	Guide Pulley Unit
	16	563 9839	Tension Pulley Unit
	17	539 2201	Inner Plate (SS-Type)
		511 0402	Inner Plate (GS-Type)
	18	521 3400	Nut B for Direct Attachment Type
	19	54Y 9804	Bracket Axle w/Stopper Plate for Direct Attachment Type