

SHIMANO 105 Front Hub HB-5500

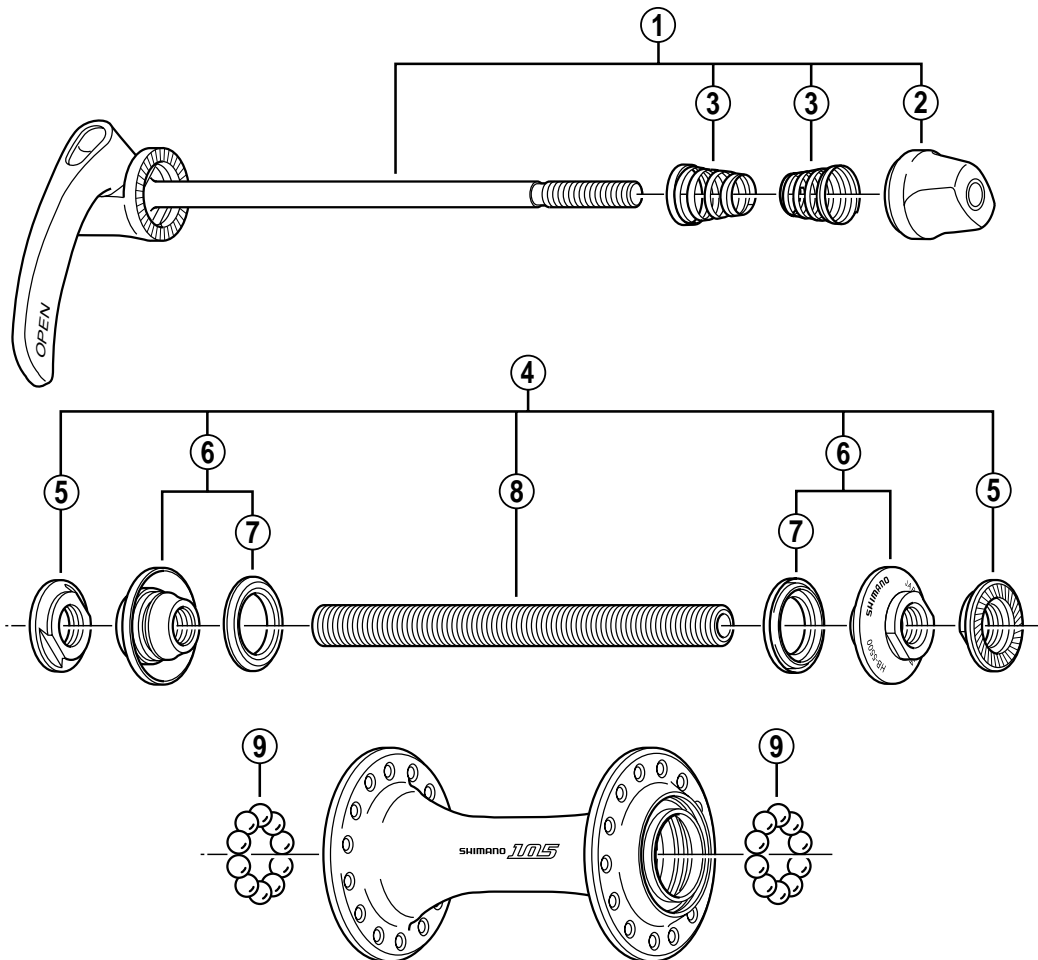

• Over Lock Nut Dimension: 100 mm (3-15/16")

ITEM NO.	SHIMANO CODE NO.	DESCRIPTION	INTERCHANGEABILITY	
			HB-6500	HB-1055-F
1	Y-23W 90100	Complete Quick Release 133 mm (5-1/4")	B	B
2	Y-23W 91100	Quick Release Nut	B	B
3	Y-231 11000	Volute Spring	A	A
4	Y-23W 98010	Complete Hub Axle 108 mm (4-1/4")	B	
5	Y-216 06100	Serated Lock Nut 4 mm	A	
6	Y-23W 98020	Cone (M9 x 12.8 mm) w/Dust Cover & Seal Ring	B	
7	Y-214 06000	Seal Ring	A	
8	Y-21C 03100	Hub Axle 108 mm (4-1/4")	A	B
9	Y-000 91210	Steel Ball (3/16") 20 pcs.	A	A

The table indicates the adaptability of conventional parts to HB-5500.

A: Same parts

B: Parts are usable, but differ in materials, appearance, finish, size, etc.

Absence of mark indicates non-interchangeability.

9808-1733



SHIMANO