



SHIMANO (EUROPA) GmbH.
Kleinhülsen 1-3 4010 Hilden,
West Germany Tel. 02103-5005-0

SHIMANO AMERICAN CORPORATION
One Shimano Drive, P.O. Box 19615, Irvine,
California U.S.A. 92718 Tel. (714) 951-5003

Small parts list for after market.

- You may photocopy this sheet and use it as an order form.
- Sie können dieses Blatt kopieren und als Bestellformular verwenden.
- Vous pouvez photocopier cette feuille et l'utiliser comme bon de commande.
- Dit blad kan gecopieerd en als bestelformulier gebruikt worden.
- Potete fotocopiare questo foglio e usarlo come modulo di commissione.

FH-MT62-QR Freehub DEORE II / Quick Release Type / 7-Speed

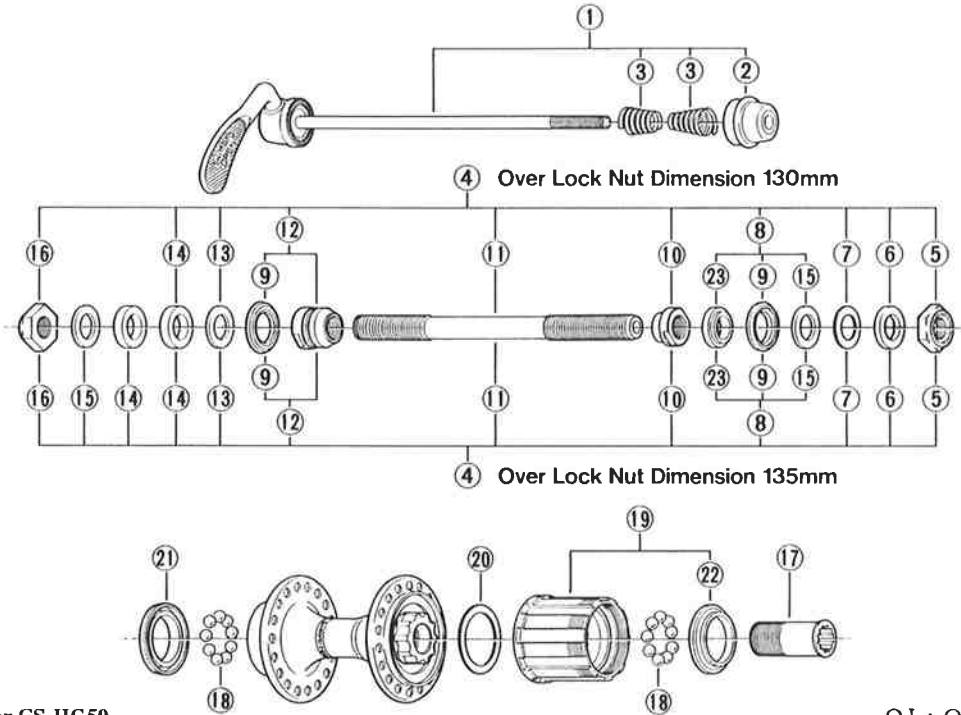

• Use with CS-HG70 or CS-HG50.

O.L.: Over Lock Nut Dimension

Q'TY	ITEM NO.	PART NO.	DESCRIPTION
	1	379 9061	Complete Quick Release 161mm for O.L. 130mm
		32C 9804	Complete Quick Release 166mm for O.L. 135mm
	2	205 9050	Nut for Skewer
	3	231 1100	Volute Spring
	4	32C 9802	Complete Hub Axle 141mm for O.L. 130mm
		32C 9803	Complete Hub Axle 146mm for O.L. 135mm
	5	220 0502-1	Right Hand Lock Nut 3.5mm
	6	301 0610	Right Hand Washer 2.3mm
	7	220 0431	Right Hand Washer 0.5mm
	* 8	380 9020	Right Hand Axle Spacer Unit 5.5mm
	9	377 1000	Seal Ring
	10	375 1600	Right Hand Cone M10 x 9mm
		360 1910-9	Hub Axle 141mm for O.L. 130mm
		360 1920-9	Hub Axle 146mm for O.L. 135mm
	12	377 9807	Left Hand Cone (M10 x 15.5mm) & Seal Ring
	13	301 0810	Left Hand Washer 1.2mm
	14	220 0460	Left Hand Axle Spacer 4mm
	* 15	301 0620	Washer 1mm
	16	220 0501-1	Left Hand Lock Nut 4.5mm
	17	359 0400	Freewheel Body Fixing Bolt
	* 18	000 9131	Steel Ball (1/4") 18pcs.
	* 19	32E 9802	Complete Freewheel Body w/Right Hand Dust Cap
	20	375 0400	Freewheel Body Dust Cap
	21	32C 0300	Left Hand Dust Cap
	* 22	32E 0300	Right Hand Dust Cap
	* 23	31B 0400	Right Hand Axle Spacer 4.5mm



SHIMANO (EUROPA) GmbH.
Kleinhülsen 1-3 4010 Hilden,
West Germany Tel. 02103-5005-0

SHIMANO AMERICAN CORPORATION
One Shimano Drive, P.O. Box 19615, Irvine,
California U.S.A. 92718 Tel. (714) 951-5003

Small parts list for after market.

- You may photocopy this sheet and use it as an order form.
- Sie können dieses Blatt kopieren und als Bestellformular verwenden.
- Vous pouvez photocopier cette feuille et l'utiliser comme bon de commande.
- Dit blad kan gecopieerd en als bestelformulier gebruikt worden.
- Potete fotocopiare questo foglio e usarlo come modulo di commissione.

FH-MT62-QR Freehub DEORE II / Quick Release Type / 7-Speed

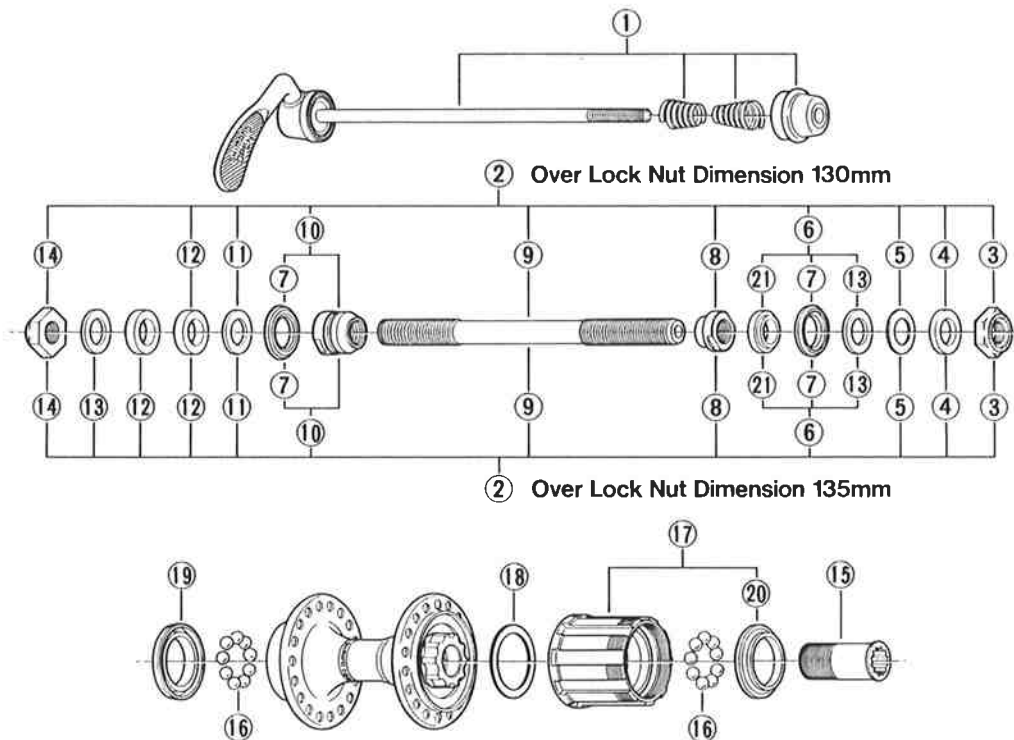

● Use with CS-HG70 or CS-HG50.

O.L.: Over Lock Nut Dimension

Q'TY	ITEM NO.	PART NO.	DESCRIPTION
	1	379 9061	Complete Quick Release 161mm(6-11/32") for O.L. 130mm(5-1/8")
		32C 9804	Complete Quick Release 166mm(6-17/32") for O.L. 135mm(5-5/16")
	2	32C 9802	Complete Hub Axle 141mm(5-9/16") for O.L. 130mm(5-1/8")
		32C 9803	Complete Hub Axle 146mm(5-3/4") for O.L. 135mm(5-5/16")
	3	220 0502-1	Right Hand Lock Nut 3.5mm
	4	301 0610	Right Hand Washer 2.3mm
	5	220 0431	Right Hand Washer 0.5mm
	* 6	380 9020	Right Hand Axle Spacer Unit 5.5mm
	7	377 1000	Seal Ring
	8	375 1600	Right Hand Cone M10 x 9mm
		360 1910-9	Hub Axle 141mm(5-9/16") for O.L. 130mm(5-1/8")
	9	360 1920-9	Hub Axle 146mm(5-3/4") for O.L. 135mm(5-5/16")
	10	377 9807	Left Hand Cone (M10 x 15.5mm) & Seal Ring
	11	301 0810	Left Hand Washer 1.2mm
	12	220 0460	Left Hand Axle Spacer 4mm
	* 13	301 0620	Washer 1mm
	14	220 0501-1	Left Hand Lock Nut 4.5mm
	15	359 0400	Freewheel Body Fixing Bolt
	16	—	Steel Ball (1/4") 9pcs.
	* 17	32E 9802	Complete Freewheel Body w/Right Hand Dust Cap
	18	375 0400	Freewheel Body Dust Cap
	19	32C 0300	Left Hand Dust Cap
	* 20	32E 0300	Right Hand Dust Cap
	* 21	31B 0400	Right Hand Axle Spacer 4.5mm