



**SHIMANO (EUROPA) GmbH.**

Kleinhüsen 1-3 4010 Hilden,  
West Germany Tel. 02103-5005-0

**SHIMANO AMERICAN CORPORATION**

One Shimano Drive, Irvine, California  
U.S.A. 92718 Tel. (714) 951-5003

## Small parts list for after market.

- You may photocopy this sheet and use it as an order form.
- Sie können dieses Blatt kopieren und als Bestellformular verwenden.
- Vous pouvez photocopier cette feuille et l'utiliser comme bon de commande.
- Dit blad kan gecopieerd en als bestelformulier gebruikt worden.
- Potete fotocopiare questo foglio e usarlo come modulo di commissione.

### FH-M550 Freehub DEORE LX/7-Speed

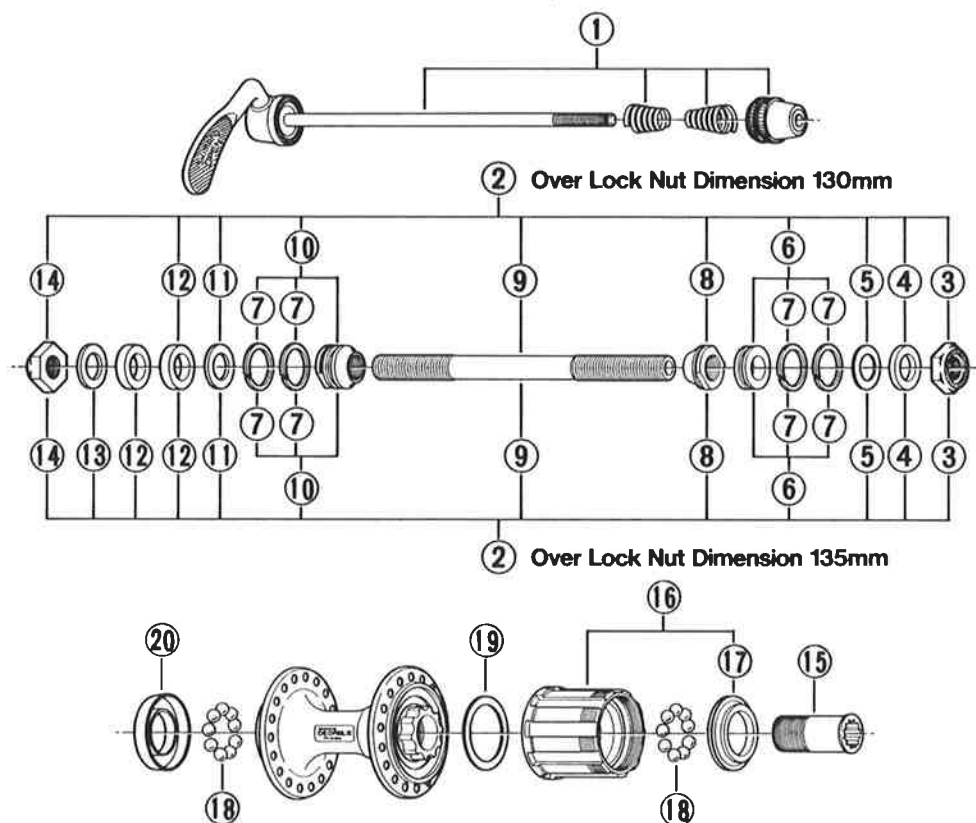

• Use with CS-HG70.

O.L.: Over Lock Nut Dimension

	Q'TY	ITEM NO.	PART NO.	DESCRIPTION
		1	382 9801	Complete Quick Release 161mm(6-11/32") for O.L. 130mm(5-1/8")
			30E 9802	Complete Quick Release 166mm(6-17/32") for O.L. 135mm(5-5/16")
	2		30E 9803	Complete Hub Axle 141mm(5-9/16") for O.L. 130mm(5-1/8")
			30E 9804	Complete Hub Axle 146mm(5-3/4") for O.L. 135mm(5-5/16")
	3		220 0502-1	Right Hand Lock Nut 3.5mm
	4		301 0610	Right Hand Washer 2.3mm
	5		220 0431	Right Hand Washer 0.5mm
	6		359 9838	Right Hand Axle Spacer (5.5mm) & Seal Ring
	7		299 0500	Seal Ring
	8		220 0851	Right Hand Cone M10x9mm
	9		301 0510	Hub Axle 141mm(5-9/16") for O.L. 130mm(5-1/8")
			301 0520	Hub Axle 146mm(5-3/4") for O.L. 135mm(5-5/16")
	10		220 9808	Left Hand Cone (M10x15.1mm) & Seal Ring
	11		301 0810	Left Hand Washer 1.2mm
	12		220 0460	Left Hand Axle Spacer 4mm
	13		301 0620	Left Hand Washer 1mm for O.L. 135mm(5-5/16")
	14		220 0501-1	Left Hand Lock Nut 4.5mm
	15		359 0400	Freewheel Body Fixing Bolt
	16		30H 9801	Complete Freewheel Body w/Right Hand Dust Cap
	17		32F 0200	Right Hand Dust Cap
	18		—	Steel Ball (1/4") 9pcs.
	19		375 0400	Freewheel Body Dust Cap
	20		248 0500	Left Hand Dust Cap



**SHIMANO (EUROPA) GmbH.**

Kleinhüsen 1-3 4010 Hilden,  
West Germany Tel. 02103-5005-0

**SHIMANO AMERICAN CORPORATION**

One Shimano Drive, Irvine, California  
U.S.A. 92718 Tel. (714) 951-5003

## Small parts list for after market.

- You may photocopy this sheet and use it as an order form.
- Sie können dieses Blatt kopieren und als Bestellformular verwenden.
- Vous pouvez photocopier cette feuille et l'utiliser comme bon de commande.
- Dit blad kan gecopieerd en als bestelformulier gebruikt worden.
- Potete fotocopiare questo foglio e usarlo come modulo di commissione.

### FH-M550 Freehub DEORE LX/7-Speed

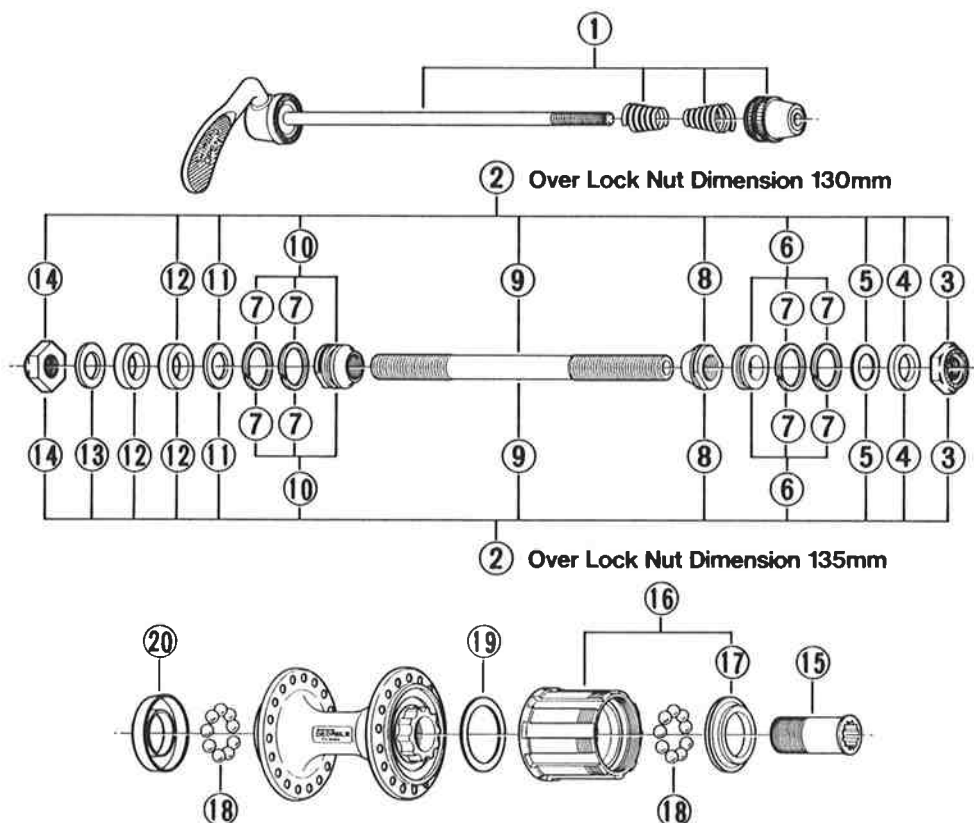

• Use with CS-HG70.

O.L.: Over Lock Nut Dimension

Q'TY	ITEM NO.	PART NO.	DESCRIPTION
	1	382 9801	Complete Quick Release 161mm for O.L. 130mm
		30E 9802	Complete Quick Release 166mm for O.L. 135mm
	2	30E 9803	Complete Hub Axle 141mm for O.L. 130mm
		30E 9804	Complete Hub Axle 146mm for O.L. 135mm
	3	220 0502-1	Right Hand Lock Nut 3.5mm
	4	301 0610	Right Hand Washer 2.3mm
	5	220 0431	Right Hand Washer 0.5mm
	6	359 9838	Right Hand Axle Spacer (5.5mm) & Seal Ring
	7	299 0500	Seal Ring
	8	220 0851	Right Hand Cone M10x9mm
	9	301 0510	Hub Axle 141mm for O.L. 130mm
		301 0520	Hub Axle 146mm for O.L. 135mm
	10	220 9808	Left Hand Cone (M10x15.1mm) & Seal Ring
	11	301 0810	Left Hand Washer 1.2mm
	12	220 0460	Left Hand Axle Spacer 4mm
	13	301 0620	Left Hand Washer 1mm for O.L. 135mm
	14	220 0501-1	Left Hand Lock Nut 4.5mm
	15	359 0400	Freewheel Body Fixing Bolt
	16	30H 9801	Complete Freewheel Body w/Right Hand Dust Cap
	17	32F 0200	Right Hand Dust Cap
	18	000 0131	Steel Ball (1/4") 18pcs.
	19	375 0400	Freewheel Body Dust Cap
	20	248 0500	Left Hand Dust Cap