

# Crankset FC-M523 BB-ES25

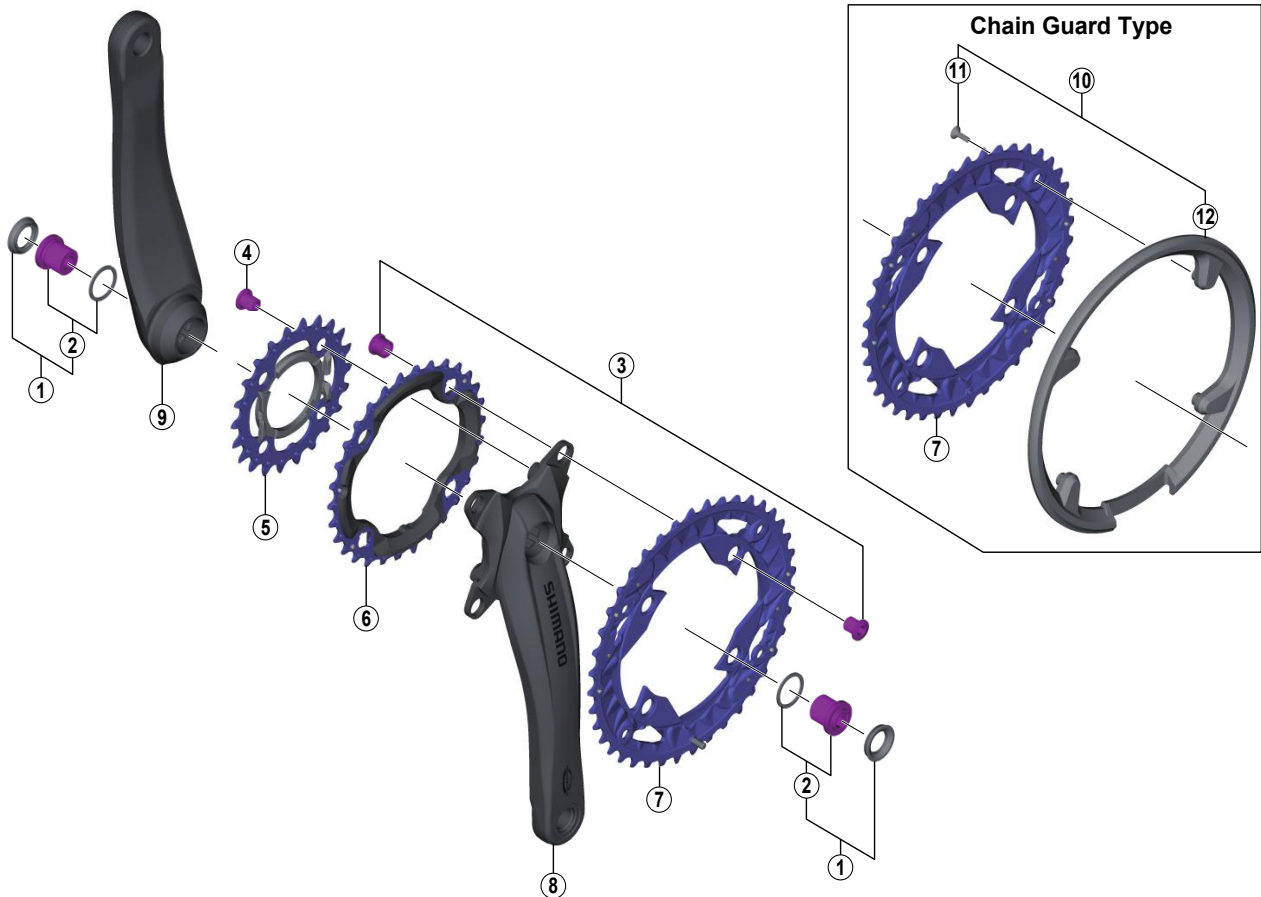

• Bolt circle diameter: 96 mm...(For outer gear and middle gear), 64 mm...(For inner gear)

FC-M522  
FC-M612

ITEM NO.	SHIMANO CODE NO.	DESCRIPTION	INTERCHANGEABILITY
1	Y1M098010	Crank Arm Fixing Bolt Unit	A
2	Y1M098020	Crank Arm Fixing Bolt & Washer	A
3	Y1LV98070	Double Gear Fixing Bolt (M8 x 8.5) & Nut (4 sets) for 30T	A
4	Y1LV98060	Inner Gear Fixing Bolt (M8 x 8.5 / 4 pcs.)	A A
5	Y1PY98010	Chainring 22T-AN (Black) & Chain Protector	
6	Y1NW98010	Chainring 30T-AN (Black)	A
* 7	Y1PY98020	Chainring 40T-AN (Black)	B
	Y1PY98030	Chainring 40T-AN (Black) for Chain Guard	
8	Y1PY98040	Right Hand Crank Arm 170 mm (Silver)	
	Y1PY98050	Right Hand Crank Arm 170 mm (Black)	
	Y1PY98060	Right Hand Crank Arm 175 mm (Silver)	
	Y1PY98070	Right Hand Crank Arm 175 mm (Black)	
9	Y1N005100	Left Hand Crank Arm 170 mm (Silver)	A
	Y1N005110	Left Hand Crank Arm 170 mm (Black)	A
	Y1N003100	Left Hand Crank Arm 175 mm (Silver)	A
	Y1N003110	Left Hand Crank Arm 175 mm (Black)	A
10	Y1PY98080	Chain Guard & Fixing Screws	
11	Y1D298010	Chain Guard Fixing Screw (4 pcs.)	
12	Y1PK16000	Chain Guard	

A: Same parts.

B: Parts are usable, but differ in materials, appearance, finish, size, etc.

Absence of mark indicates non-interchangeability.

Oct-2014-3706A  
© Shimano Inc. H

Specifications are subject to change without notice.

# SHIMANO