

DURA-ACE Crankset FC-09

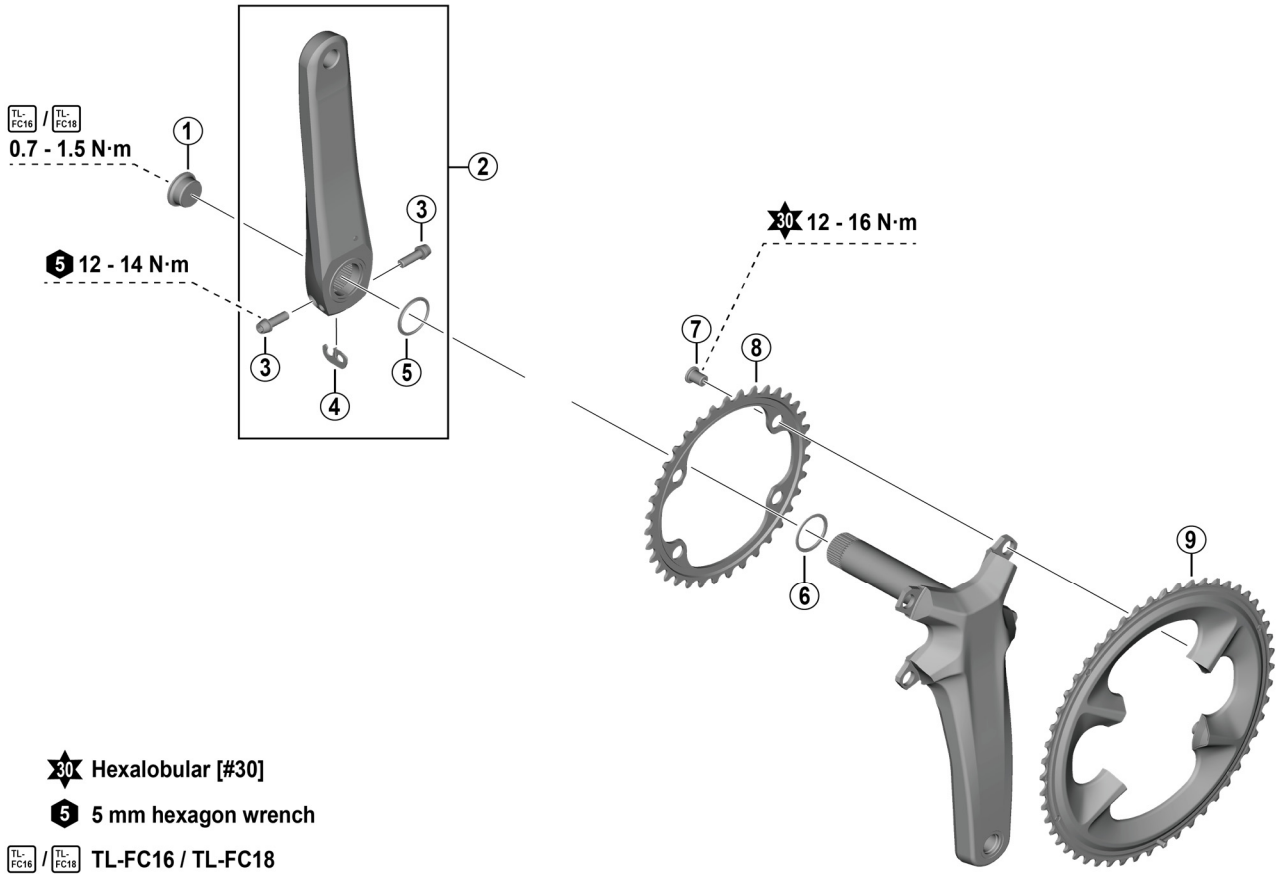

30 Hexalobular [#30]

5 5 mm hexagon wrench

TL-FC16 / TL-FC18 TL-FC16 / TL-FC18

• Chaining teeth combinations: 50-34T/52-36T/54-40T

• P.C.D. 110 mm

FC-R9200

ITEM NO.	SHIMANO CODE NO.	DESCRIPTION	INTERCHANGEABILITY		
1	Y1KY08000	Crank mounting screw	A		
2	Y0V298010	Left-hand crank arm unit 165 mm	B		
	Y0V298020	Left-hand crank arm unit 167.5 mm	B		
	Y0V298030	Left-hand crank arm unit 170 mm	B		
	Y0V298040	Left-hand crank arm unit 172.5 mm	B		
	Y0V298050	Left-hand crank arm unit 175 mm	B		
	Y0V298060	Left-hand crank arm unit 177.5 mm	B		
3	Y1GS22100	Crank fixing screw (M6 x 19) with washer	A		
4	Y1GE98050	Plate	A		
5	Y0MZ9801T	Ring L	A		
6	Y0MZ14000	Ring R	A		
7	Y1H598160	Chaining fixing screw (M8 x 10.1 / 1 unit = 4 pcs.)	A		
8	Y0MZ34000	Chaining 34T-NK	A		
	Y0MZ36000	Chaining 36T-NH	A		
	Y0MZ40000	Chaining 40T-NJ	A		
	Y0V298070	Chainring 50T-NK			
9	Y0V298080	Chainring 52T-NH			
	Y0V298090	Chainring 54T-NJ			

A: Same parts.

B: Parts are usable, but differ in materials, appearance, finish, size, etc.

Absence of mark indicates non-interchangeability.

Specifications are subject to change without notice.

Torque information is listed.

Jan.-2024-4988

© Shimano Inc. I

SHIMANO