

Cassette Sprocket (10-speed)

# CS-HG50-10

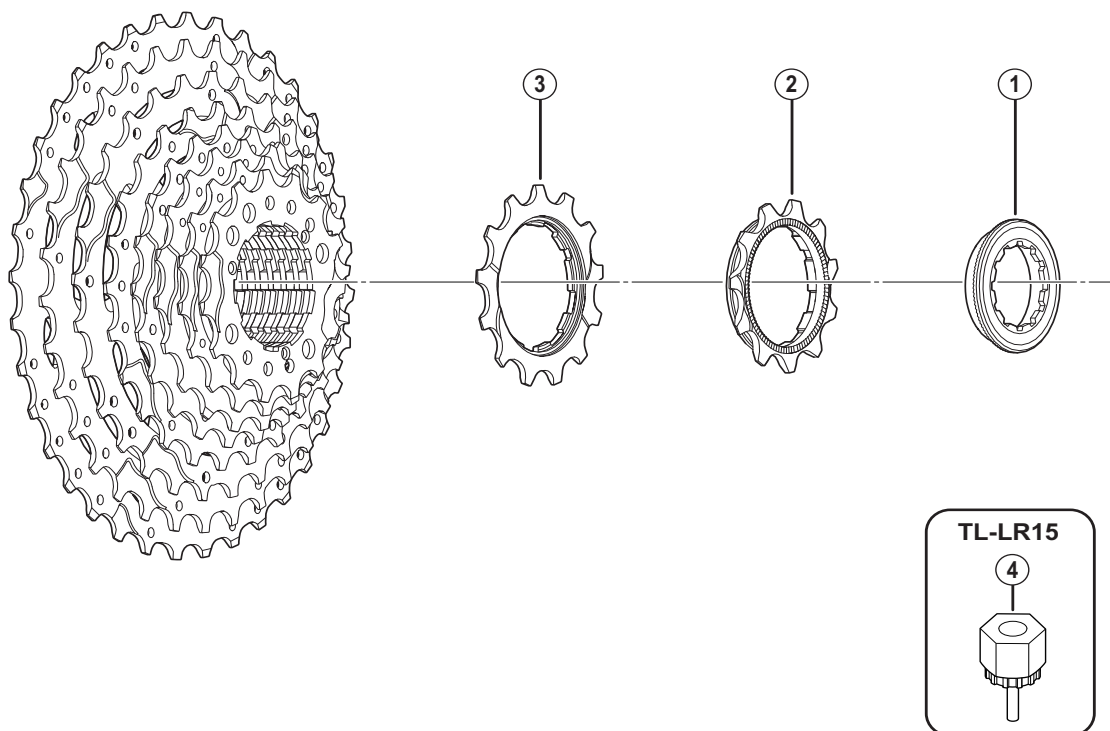

● bk-group sprocket teeth combination: 11-13-15-17-19-21-24-28-32-36T

ITEM NO.	SHIMANO CODE NO.	DESCRIPTION
1	Y1PG98010	Lock Ring
2	Y1PG11000	Sprocket Wheel 11T (Built in spacer type) for bk-Group
* 3	Y1PG13010	Sprocket Wheel 13T (Built in spacer type) for bk-Group
4	Y12009230	Lock Ring Removal Tool (TL-LR15)

Mar.-2017-3767A  
© Shimano Inc. I

Specifications are subject to change without notice.

# SHIMANO