

SHIMANO ULTEGRA Cassette Sprocket

CS-6600 10-Speed

11T Top Gear Type

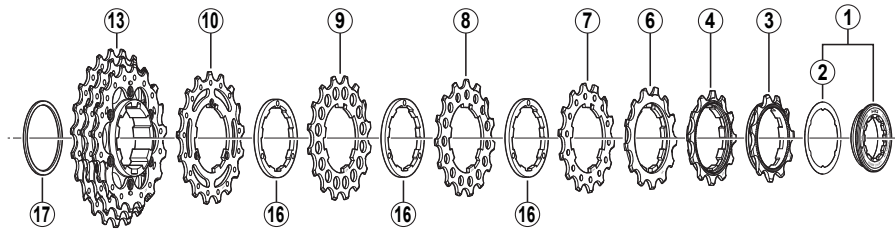

12T Top Gear Type

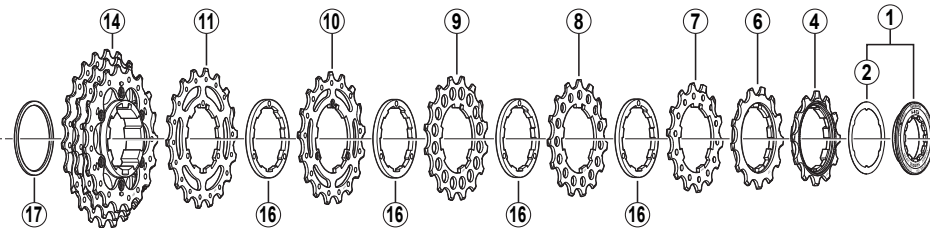

13/14/15/16T Top Gear Type

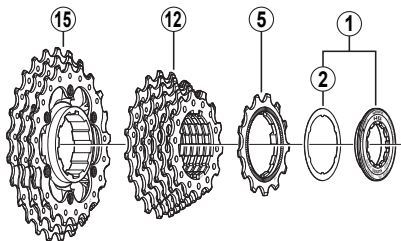

TL-LR15

18

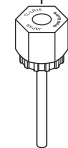

CS-6600 sprocket teeth combinations

11 - 23T	11-12-13-14-15-16-17	-19-21-23T
12 - 23T	12-13-14-15-16-17-18	-19-21-23T
12 - 25T	12-13-14-15-16-17-19	-21-23-25T
12 - 27T	12-13-14-15-16-17-19	-21-24-27T
13 - 25T	13-	14-15-16-17-18-19 -21-23-25T
14 - 25T	14-	15-16-17-18-19-20 -21-23-25T
15 - 25T	15-	16-17-18-19-20-21 -22-23-25T
16 - 27T	16-	17-18-19-20-21-22 -23-25-27T

ITEM NO.	SHIMANO CODE NO.	DESCRIPTION
1	Y-1ZD98010	Lock Ring & Spacer for 11T Top Gear
	Y-1ZD98020	Lock Ring & Spacer
2	Y-11W02000	Lock Ring Spacer
3	Y-1Z8 1100D	Sprocket Wheel 11T (Built in spacer type)
4	Y-1Z8 1200D	Sprocket Wheel 12T (Built in spacer type)
	Y-1ZD 1300D	Sprocket Wheel 13T (Built in spacer type)
5	Y-1ZD 1400D	Sprocket Wheel 14T (Built in spacer type)
	Y-1ZD 1500D	Sprocket Wheel 15T (Built in spacer type)
	Y-1ZD 1600D	Sprocket Wheel 16T (Built in spacer type)
6	Y-1Z8 1300D	Sprocket Wheel 13T (Built in spacer type)
7	Y-1Z8 1400D	Sprocket Wheel 14T
8	Y-1Z8 1500D	Sprocket Wheel 15T
9	Y-1Z8 1600D	Sprocket Wheel 16T
10	Y-1ZD 1700E	Sprocket Wheel 17T
	Y-1ZD 1800E	Sprocket Wheel 18T
11	Y-1ZD 1900E	Sprocket Wheel 19T
	Y-1ZD 98050	Sprocket Unit (14 - 15 - 16 - 17 - 18 - 19T)
12	Y-1ZD 98060	Sprocket Unit (15 - 16 - 17 - 18 - 19 - 20T)
	Y-1ZD 98070	Sprocket Unit (16 - 17 - 18 - 19 - 20 - 21T)
	Y-1ZD 98080	Sprocket Unit (17 - 18 - 19 - 20 - 21 - 22T)
13	Y-1ZD 98090	Sprocket Unit (19 - 21 - 23T)
	Y-1ZD 98100	Sprocket Unit (19 - 21 - 23T)
14	Y-1ZD 98110	Sprocket Unit (21 - 23 - 25T)
	Y-1ZD 98120	Sprocket Unit (21 - 24 - 27T)
	Y-1ZD 98130	Sprocket Unit (21 - 23 - 25T) for 13 - 25T
15	Y-1ZD 98140	Sprocket Unit (21 - 23 - 25T) for 14 - 25T
	Y-1ZD 98150	Sprocket Unit (22 - 23 - 25T)
	Y-1ZD 98160	Sprocket Unit (23 - 25 - 27T)
16	Y-1Z8 05000	Sprocket Spacer (t=2.35 mm)
17	Y-1Z8 07000	Low Spacer (t=1.0 mm)
18	Y-120 09230	Lock Ring Removal Tool (TL-LR15)

0405-2370

Specifications are subject to change without notice.

SHIMANO