

SHIMANO

SHIMANO (EUROPA) GmbH.
Kleinhülsen 1-3 4010 Hilden, Germany
Tel. 02103-5005-0

SHIMANO AMERICAN CORPORATION
One Shimano Drive, P.O. Box 19615, Irvine,
California U.S.A. 92713-9615 Tel. (714) 951-5003

Small parts list for after market.

- You may photocopy this sheet and use it as an order form.
- Sie können dieses Blatt kopieren und als Bestellformular verwenden.
- Vous pouvez photocopier cette feuille et l'utiliser comme bon de commande.
- Dit blad kan gecopieerd en als bestelformulier gebruikt worden.
- Potete fotocopiare questo foglio e usarlo come modulo di commissione.

SHIMANO STX Front Chainwheel

FC-MC31-CH Round Gear SG-X

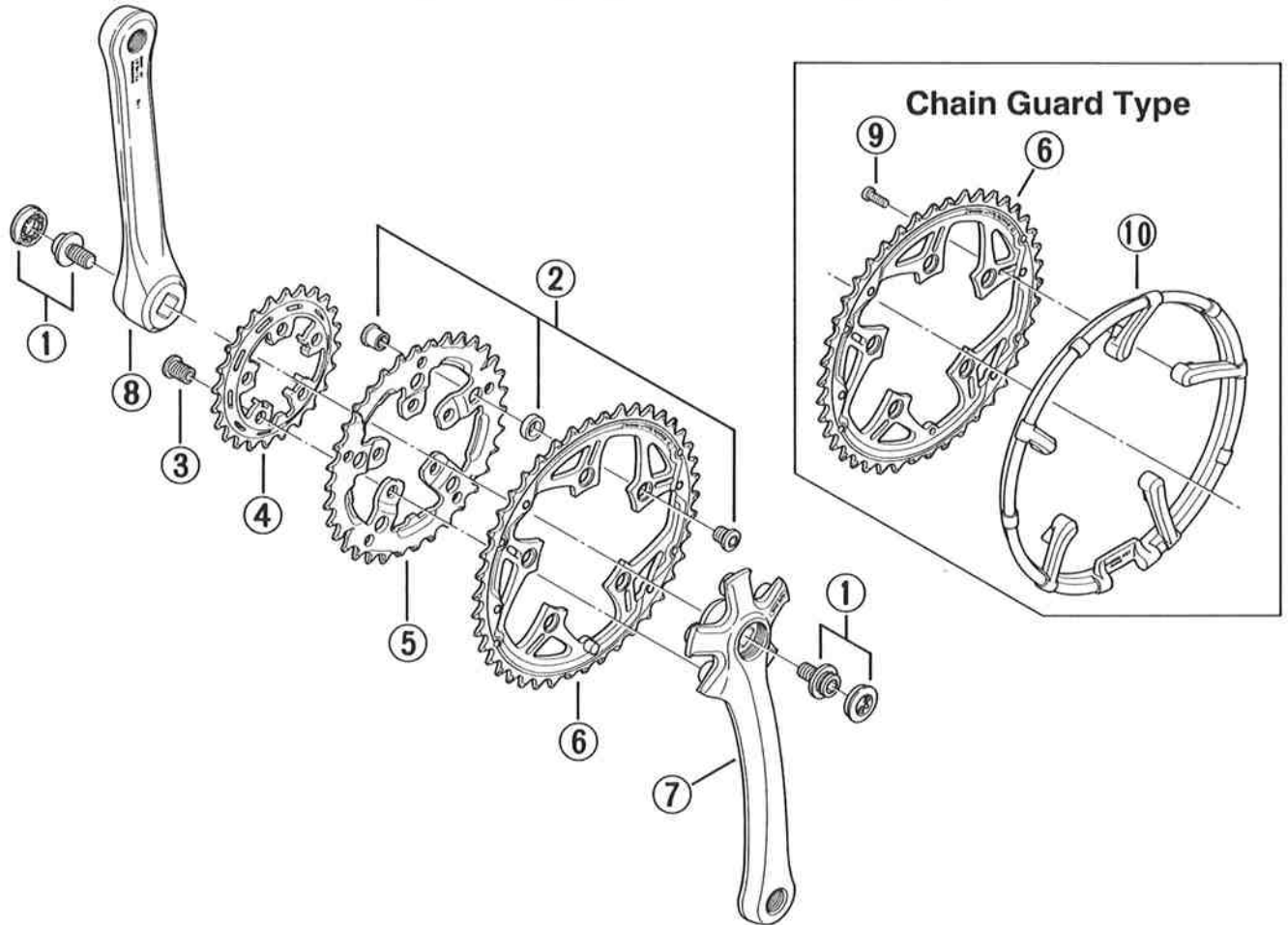

- Bolt circle diameter: 95mm....(For outer gear and middle gear), 58mm....(For middle gear and inner gear)

Q'TY	ITEM NO.	PART NO.	DESCRIPTION
	1	1CN 9010	Crank Arm Fixing Bolt & Cap
	2	1CL 9801	Outer Gear Fixing Bolt Unit (M8 x 8.5) 5 sets
	3	1CL 9802	Middle Gear & Inner Gear Fixing Bolt (M8 x 11.5) 5 pcs.
	4	1CC 2400	Chainring 24T / Round Gear SG (Silver)
	5	1CC 3400	Chainring 34T / Round Gear SG-X (Silver)
	6	1CL 9420	Chainring 42T / Round Gear SG-X (Black)
		1CL 9421	Chainring 42T / Round Gear SG-X (Black) for Chain Guard
	7	1CC 0220	Right Crank Arm 170mm (Chromica)
		1CC 0320	Right Crank Arm 175mm (Chromica)
	8	1CD 0220	Left Crank Arm 170mm (Chromica)
		1CD 0320	Left Crank Arm 175mm (Chromica)
	9	1CG 9801	Chain Guard Fixing Bolt (5 pcs.)
	10	1CL 9803	Chain Guard (Gray)