

DEORE XT Crankset

FC-M8120-1 BB-MT801

FC-M8120-B2 BB-MT800

SM-CRM85

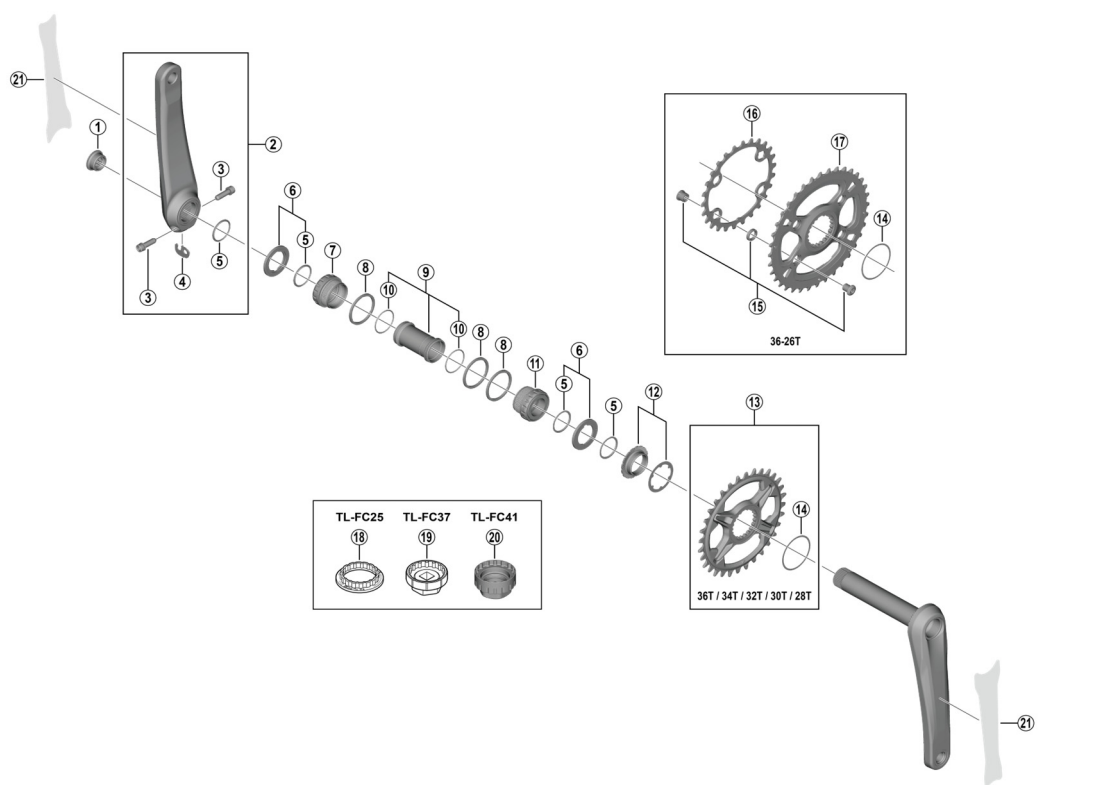

• Chaining teeth specification: 36-26T / 36T / 34T / 32T / 30T / 28T

ITEM NO.	SHIMANO CODE NO.	DESCRIPTION	INTERCHANGEABILITY		
1	Y0J620000	Crank arm fixing screw			
2	Y0J698010	Left hand crank arm unit 165 mm			
	Y0J698020	Left hand crank arm unit 170 mm			
	Y0J698030	Left hand crank arm unit 175 mm			
	Y0J698040	Left hand crank arm unit 180 mm			
3	Y1GS21000	Clamp screw with washer (M6 x 21)			
4	Y0J698050	Plate			
5	Y1F316000	Ring	A	A	
6	Y1PW98070	Spacer and ring	A	A	
7	Y2LC98010	Left hand cup (B.C.1.37" x 24T) english thread (BB-MT801)			
	Y1V698010	Left hand cup (B.C.1.37" x 24T) english thread (BB-MT800)			
8	Y1P804000	Spacer (2.5 mm)			
9	Y1E598210	Inner cover and O-ring			
10	Y1TF21000	O-ring			
11	Y2LC98020	Right hand cup (B.C.1.37" x 24T) english thread (BB-MT801)			
	Y1V698020	Right hand cup (B.C.1.37" x 24T) english thread (BB-MT800)			
12	Y0J698060	Lock ring and washer			
13	ISMCRM85Z8	Chainring 28T with spacer (SM-CRM85)			
	ISMCRM85A0	Chainring 30T with spacer (SM-CRM85)			
	ISMCRM85A2	Chainring 32T with spacer (SM-CRM85)			
	ISMCRM85A4	Chainring 34T with spacer (SM-CRM85)			
	ISMCRM85A6	Chainring 36T with spacer (SM-CRM85)			
14	Y0JC61000	Spacer			
15	Y0J898020	Chaining fixing bolt unit (4 sets)			
16	Y0JB26000	Chaining 26T-BJ for 36-26T			
17	Y0J898010	Chaining 36T-BJ for 36-26T			
18	Y13009260	TL-FC25 Bottom bracket cup tool			
19	Y13009270	TL-FC37 Bottom bracket cup tool			
20	Y13098720	TL-FC41 Front chaining direct mount tool			
21	Y0J698070	Protection sticker for crank arm 165/170 mm (2 pcs.)			
	Y0J698080	Protection sticker for crank arm 175/180 mm (2 pcs.)			

A: Same parts.

B: Parts are usable, but differ in materials, appearance, finish, size, etc.

Absence of mark indicates non-interchangeability.

Specifications are subject to change without notice.

Oct.-2022-4558C

© Shimano Inc. I

SHIMANO

