

# DEORE XT Crankset

## FC-M8100-1 FC-M8100-2 BB-MT801 BB-MT800 SM-CRM85

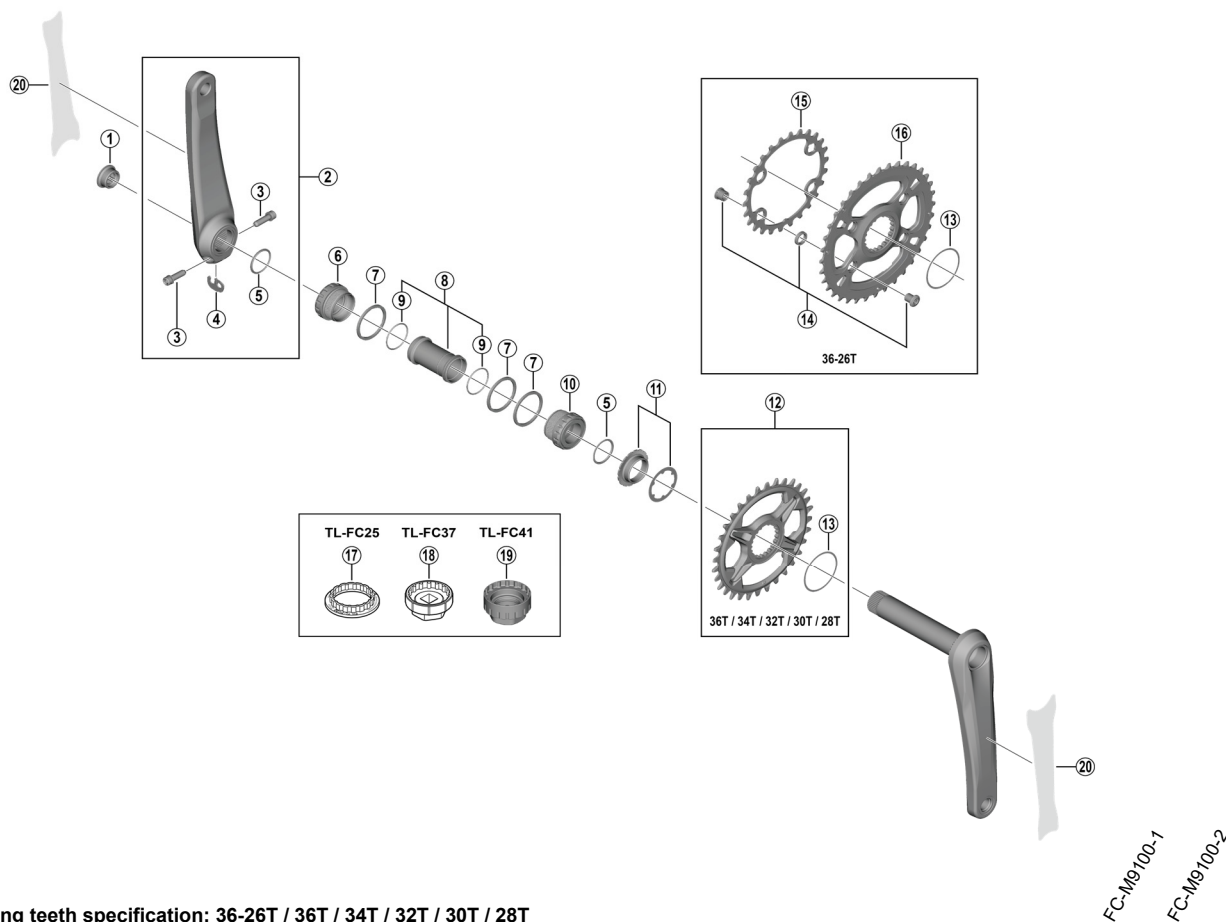

### • Chaining teeth specification: 36-26T / 36T / 34T / 32T / 30T / 28T

| ITEM NO. | SHIMANO CODE NO. | DESCRIPTION  | INTERCHANGEABILITY |   |  |
|----------|------------------|--|--------------------|---|--|
| 1        | Y0J620000        | Crank arm fixing screw                                     |                    |   |  |
| 2        | Y0J698010        | Left hand crank arm unit 165 mm                            |                    |   |  |
|          | Y0J698020        | Left hand crank arm unit 170 mm                            |                    |   |  |
|          | Y0J698030        | Left hand crank arm unit 175 mm                            |                    |   |  |
|          | Y0J698040        | Left hand crank arm unit 180 mm                            |                    |   |  |
| 3        | Y1GS21000        | Clamp screw with washer (M6 x 21)                          |                    |   |  |
| 4        | Y0J698050        | Plate  |                    |   |  |
| 5        | Y1F316000        | Ring   | A                  | A |  |
| * 6      | Y2LC98010        | Left hand cup (B.C.1.37" x 24T) english thread (BB-MT801)  |                    |   |  |
|          | Y1V698010        | Left hand cup (B.C.1.37" x 24T) english thread (BB-MT800)  |                    |   |  |
| 7        | Y1P804000        | Spacer (2.5 mm)  |                    |   |  |
| 8        | Y1E598210        | Inner cover and O-ring                                     |                    |   |  |
| 9        | Y1TF21000        | O-ring   |                    |   |  |
| * 10     | Y2LC98020        | Right hand cup (B.C.1.37" x 24T) english thread (BB-MT801) |                    |   |  |
|          | Y1V698020        | Right hand cup (B.C.1.37" x 24T) english thread (BB-MT800) |                    |   |  |
| 11       | Y0J698060        | Lock ring and washer                                       |                    |   |  |
| 12       | ISMCRM85Z8       | Chainring 28T with spacer (SM-CRM85)                       |                    |   |  |
|          | ISMCRM85A0       | Chainring 30T with spacer (SM-CRM85)                       |                    |   |  |
|          | ISMCRM85A2       | Chainring 32T with spacer (SM-CRM85)                       |                    |   |  |
|          | ISMCRM85A4       | Chainring 34T with spacer (SM-CRM85)                       |                    |   |  |
|          | ISMCRM85A6       | Chainring 36T with spacer (SM-CRM85)                       |                    |   |  |
| 13       | Y0JC61000        | Spacer   |                    |   |  |
| 14       | Y0J898020        | Chaining fixing bolt unit (4 sets)                         |                    |   |  |
| 15       | Y0JB26000        | Chainring 26T-BJ for 36-26T                                |                    |   |  |
| 16       | Y0J898010        | Chainring 36T-BJ for 36-26T                                |                    |   |  |
| 17       | Y13009260        | TL-FC25 Bottom bracket cup tool                            |                    |   |  |
| 18       | Y13009270        | TL-FC37 Bottom bracket cup tool                            |                    |   |  |
| 19       | Y13098720        | TL-FC41 Front chaining direct mount tool                   |                    |   |  |
| 20       | Y0J698070        | Protection sticker for crank arm 165/170 mm (2 pcs.)       |                    |   |  |
|          | Y0J698080        | Protection sticker for crank arm 175/180 mm (2 pcs.)       |                    |   |  |

A: Same parts.

B: Parts are usable, but differ in materials, appearance, finish, size, etc.

Absence of mark indicates non-interchangeability.

Specifications are subject to change without notice.

Oct.-2022-4508C

© Shimano Inc. I

# SHIMANO

