

Cassette Sprocket (9-speed)

CS-HG400-9 ar/au/bg/bh/cb-Group

ar-Group

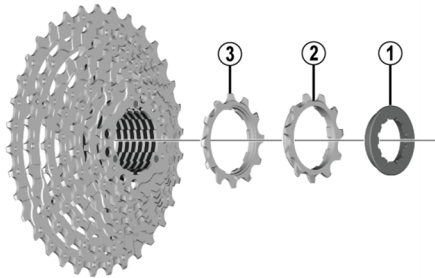

au / cb-Group

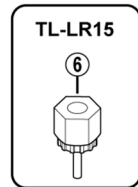
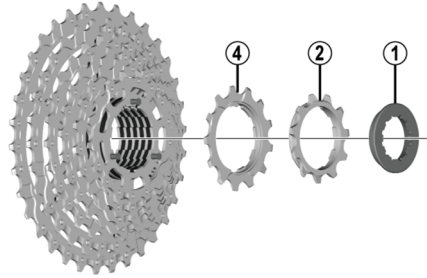

bg-Group

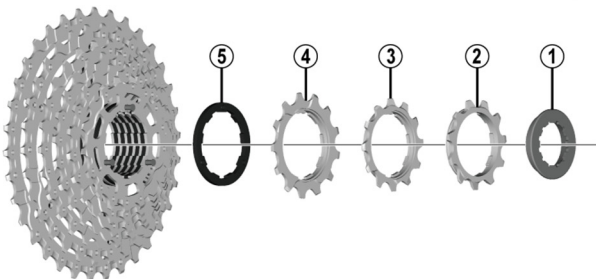

bh-Group

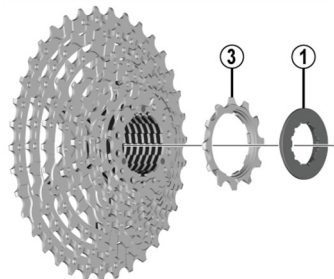

- bg-group sprocket teeth combination: 11-12-13-14-16-18-21-24-28T
- ar-group sprocket teeth combination: 11-12-14-16-18-21-24-28-32T
- au-group sprocket teeth combination: 11-13-15-17-20-23-26-30-34T
- cb-group sprocket teeth combination: 11-13-15-17-20-23-26-30-36T
- bh-group sprocket teeth combination: 12-14-16-18-21-24-28-32-36T

CS-HG61-9

ITEM NO.	SHIMANO CODE NO.	DESCRIPTION	INTERCHANGEABILITY
1	Y1PP01110	Lock Ring for ar/au/bg/cb-Group	B
	Y1PP01200	Lock Ring for bh-Group	B
2	Y1PP11100	Sprocket Wheel 11T (Built in spacer type) for ar/bg-Group	B
	Y1PP11000	Sprocket Wheel 11T (Built in spacer type) for au/cb-Group	B
3	Y1PP12100	Sprocket Wheel 12T (Built in spacer type) for ar/bg-Group	B
	Y1PP12000	Sprocket Wheel 12T (Built in spacer type) for bh-Group	B
4	Y1PP13000	Sprocket Wheel 13T (Built in spacer type) for au/cb-Group	B
	Y1PP13100	Sprocket Wheel 13T for bg-Group	B
5	Y35764251	Sprocket Spacer (t=2.56 mm)	A
6	Y12009230	Lock Ring Removal Tool (TL-LR15)	A

A: Same parts.

B: Parts are usable, but differ in materials, appearance, finish, size, etc.

Absence of mark indicates non-interchangeability.

Specifications are subject to change without notice.

Apr.-2017-3680A

© Shimano Inc. I

SHIMANO