

SHIMANO 105 Dual Control Lever  
**ST-5500-CA** FLIGHT DECK Compatible

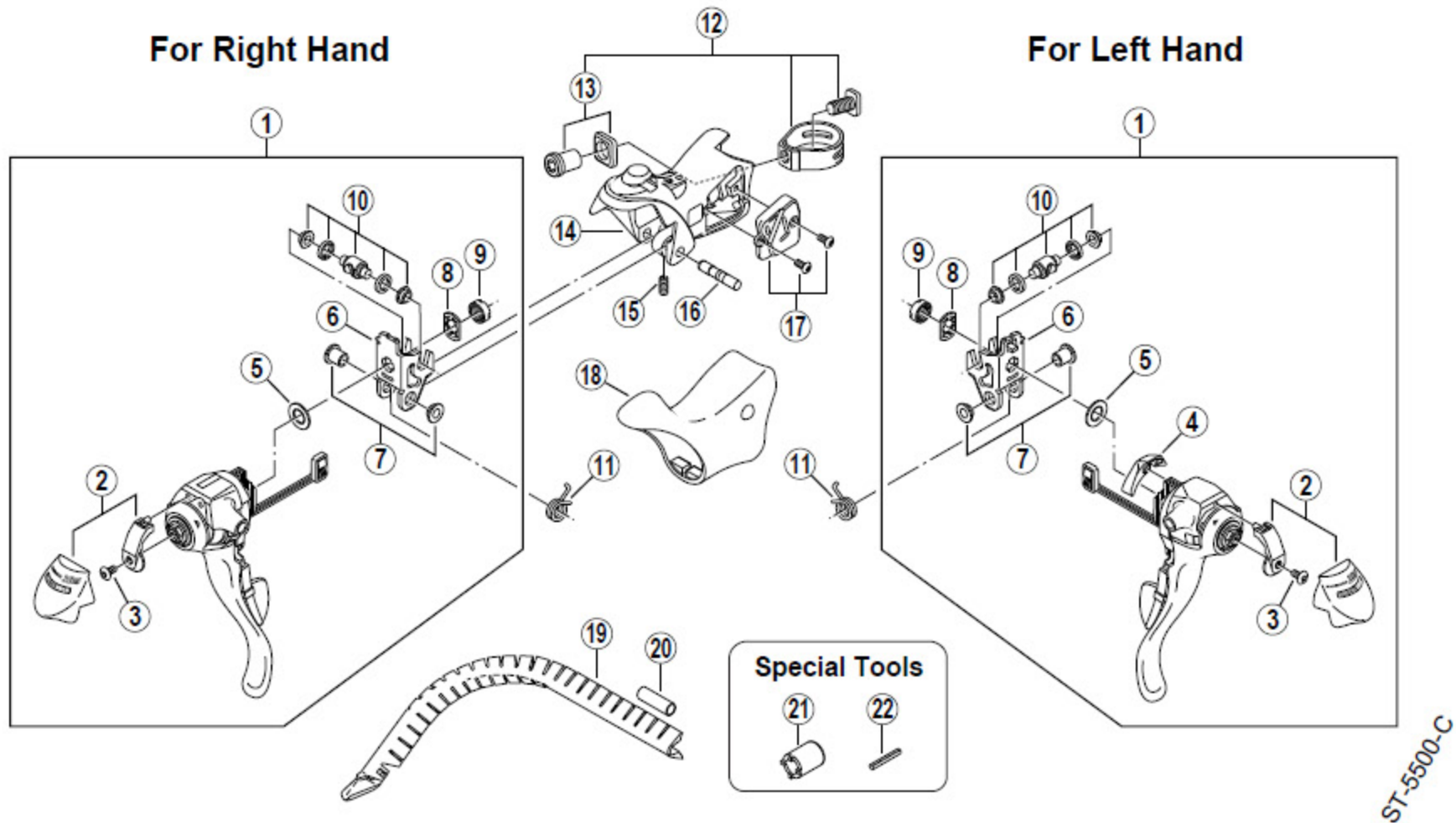

ITEM NO.	SHIMANO CODE NO.	DESCRIPTION	INTERCHANGEABILITY
1	Y-6B9 98070	R.H. Main Lever Assembly	
	Y-6B9 98080	L.H. Main Lever Assembly	
2	Y-6B9 98120	R.H. Name Plate & Front Cover	B
	Y-6B9 98130	L.H. Name Plate & Front Cover	B
3	Y-6BS 42000	Front Cover Fixing Screw (M3 x 6)	A
4	Y-6BS 71100	L.H. Rear Cover	A
5	Y-6BS 74000	Adapter Spacer	A
6	Y-6CT 03000	R.H. Adapter	
	Y-6CT 03010	L.H. Adapter	
7	Y-85Z 98010	Lever Axle Bush Unit	A
8	Y-6BD 39000	Non-Turn Washer	A
9	Y-66E 33000	Lock Nut	A
10	Y-6BD 98110	Cable Hook Unit	A
11	Y-6BD 75000	R.H. Return Spring	A
	Y-6BD 74000	L.H. Return Spring	A
12	Y-6BD 98120	Clamp Band Unit ( $\phi$ 23.8 mm – $\phi$ 24.2 mm)	A
13	Y-6BD 98130	Clamp Nut & Washer	A
14	Y-6B4 98030	R.H. Bracket	A
	Y-6B4 98040	L.H. Bracket	A
15	Y-6BD 76000	Lever Axle Fixing Screw	A
16	Y-6BS 84000	Lever Axle	A
17	Y-6CT 98080	R.H. Water-Proof Cap & Fixing Screws (M3 x 6.35)	
	Y-6CT 98090	L.H. Water-Proof Cap & Fixing Screws (M3 x 6.35)	
18	Y-6B9 98090	Bracket Covers (Pair)	A
19	Y-86B 90010	Outer Cable Guide	A
20	Y-877 11000	Outer Cable Joint	A
21	Y-130 03000	Lock Nut Removal Tool (TL-ST01)	A
22	Y-130 03100	Return Spring Installation Tool (TL-ST02)	A

A : Same parts.

B : Parts are usable, but differ in materials, appearance, finish, size, etc.

Absence of mark indicates non-interchangeability.

0101-1934A

**SHIMANO**<sup>®</sup>

Specifications are subject to change without notice.



© 2001 by Shimano Inc.