

# Shifting Lever (2-WAY RELEASE) ST type



User's manuals in other languages are available at :  
<http://si.shimano.com>

## IMPORTANT NOTICE

- Contact the place of purchase or a bicycle dealer for information on installation and adjustment of the products which are not found in the user's manual. A dealer's manual for professional and experienced bicycle mechanics is available on our website (<http://si.shimano.com>).
- Do not disassemble or alter this product.

**For safety, be sure to read this user's manual thoroughly before use, and follow it for correct use.**

## Important Safety Information

**For replacement information, contact the place of purchase or a bicycle dealer.**

### WARNING

- It is important to sufficiently understand the operation of the bicycle brake system. Improper use of your bicycle's brake system may result in a loss of control or a fall, which could lead to severe injury. Because each bicycle may handle differently, be sure to learn the proper braking technique (including brake lever pressure and bicycle control characteristics) and operation of your bicycle. This can be done by consulting your professional bicycle dealer and the bicycle's owners manual, and by practicing your riding and braking technique.
- If the front brake is applied too strongly, the wheel may lock and the bicycle may fall forward, and serious injury may result.
- Always make sure that the front and rear brakes are working correctly before you ride the bicycle.
- The required braking distance will be longer during wet weather. Reduce your speed and apply the brakes early and gently.
- If the road surface is wet, the tires will skid more easily. If the tires skid, you may fall off the bicycle. To avoid this, reduce your speed and apply the brakes early and gently.
- After reading the user's manual carefully, keep it in a safe place for later reference.

## Note

- Be sure to keep turning the crank during the lever operation.
- Read the user's manuals for the front derailleur, rear derailleur, and brakes as well.
- Products are not guaranteed against natural wear and deterioration from normal use and aging.
- For maximum performance we highly recommend Shimano lubricants and maintenance products.

## Regular inspections before riding the bicycle

Before riding the bicycle, check the following items. If any problems are found with the following items, contact the place of purchase or a bicycle dealer.

- Do the front and rear brakes work correctly?
- Is gear shifting carried out smoothly?
- Are the levers securely installed to the handlebar?
- Do any abnormal noises occur during operation?

## Names of parts

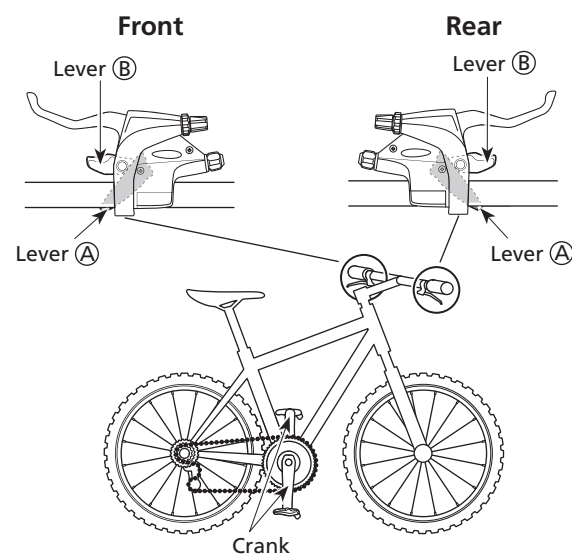

## Operation

### Braking operation

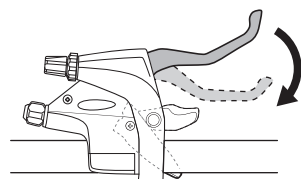

### Gear shifting operation

Be sure to keep turning the crank during the lever operation.

### Caution on operation

Both lever (A) and lever (B) always return to the start position when they are released after shifting.

### Operation of rear derailleur lever

The lever stroke can be varied to shift the desired number of gears; to shift by one gear at a time move the lever to the ① position, and to shift by two gears at a time move the lever to the ② position.

- Lever (A) : Shifts from smaller to larger rear sprocket (Pedaling becomes lighter.)

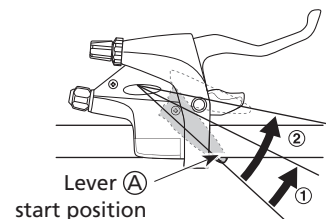

- ① : Shifts one sprocket  
E.x. : from 3rd to 4th

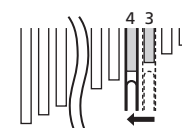

- ② : Quick-shifts two sprockets  
E.x. : from 3rd to 5th

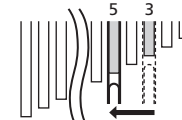

- Lever (B) : Shifts from larger to smaller rear sprocket (Pedaling becomes heavier.)

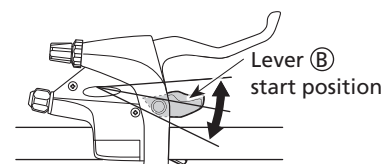

"The gears can be shifted by either pushing or pulling the lever."

E.x. : from 4th to 3rd

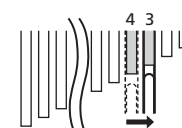

### Operation of front derailleur levers

\* The illustration shows the triple specification. The method is the same for the "double" specification.

- Lever (A) : Shifts from smaller to larger front chainring (Pedaling becomes heavier.)

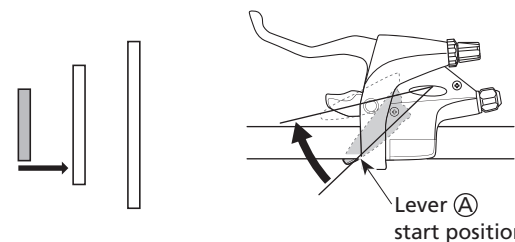

- Lever (B) : Shifts from larger to smaller front chainring (Pedaling becomes lighter.)

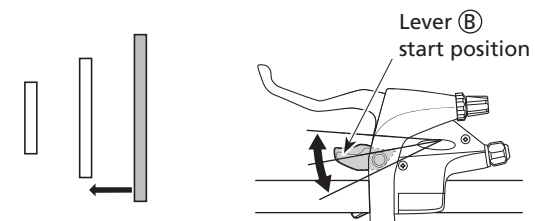

"The gears can be shifted by either pushing or pulling the lever."

### For shifting lever including trimming function

When lever (B) is operated, there is one click where trimming (the noise prevention mechanism) engages, and a second stronger click when the gear shift stroke is completed. After trimming, the next push will complete the gear shift stroke.

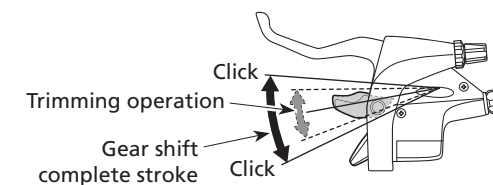

### Trimming Operation (noise prevention mechanism)

If the chain is on the large front chainwheel and the larger rear sprocket, the chain will rub on the front derailleur, producing a distinctive noise. When this happens, press lever (B) lightly (to the point where it clicks); this causes the front derailleur to move slightly towards the smaller chainwheel, thereby eliminating the noise.

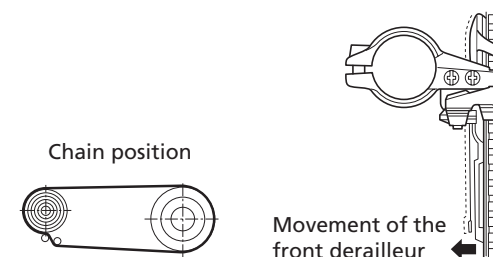

## SHIMANO

SHIMANO AMERICAN CORPORATION  
One Holland, Irvine, California 92618, U.S.A. Phone: +1-949-951-5003

SHIMANO EUROPE B.V.  
Industrieweg 24, 8071 CT Nunspeet, The Netherlands Phone: +31-341-272222

SHIMANO INC.  
3-77 Oimatsu-cho, Sakai-ku, Sakai-shi, Osaka 590-8577, Japan

Please note: specifications are subject to change for improvement without notice. (English)

© Oct. 2016 by Shimano Inc. ITP